

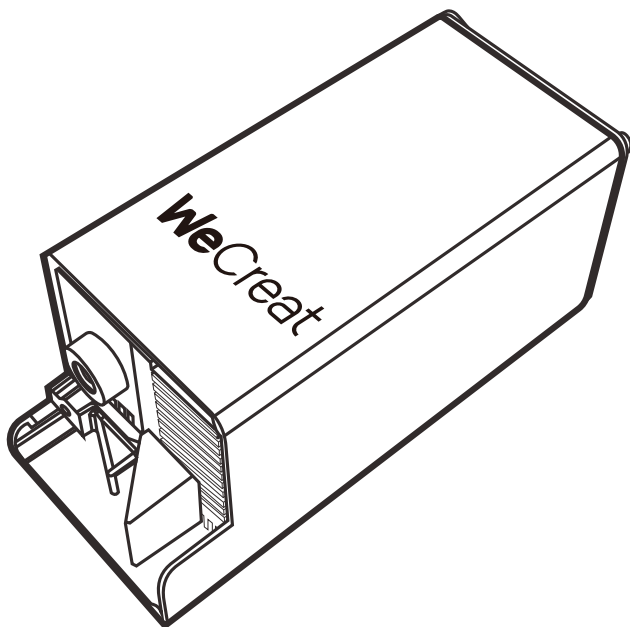

WeCreat 2W

1064nm Infrared LaserModule

User Guide



support@wecreat.com

What's In The Box

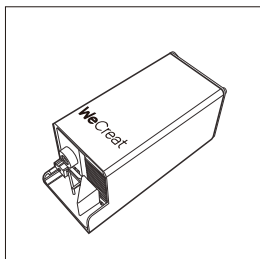

2W laser module *1

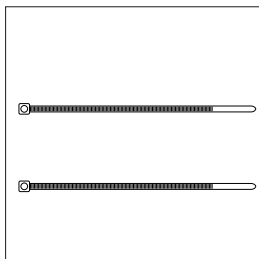

Cable tie *2

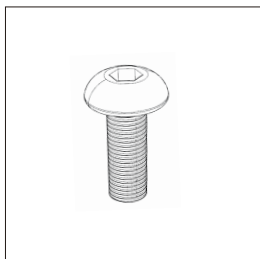

M3*6 screw *6

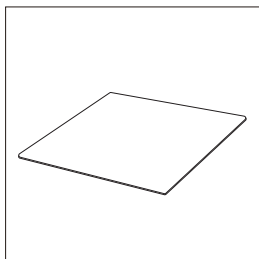

Aluminum sheet *5

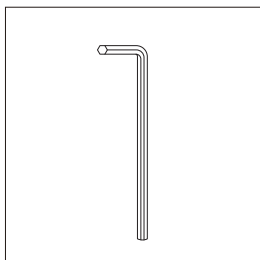

L-shaped Allen wrench *1

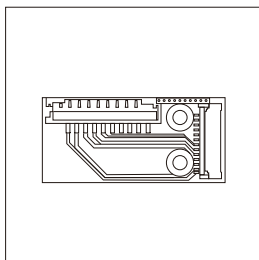

Adapter circuit board *1

Installation

For a video Installation Guide, please visit support.wecreat.com or scan this QR code to view.

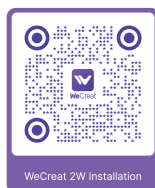

Step 1. Disassemble the initial Laser module

1. Turn off the power of the laser machine.

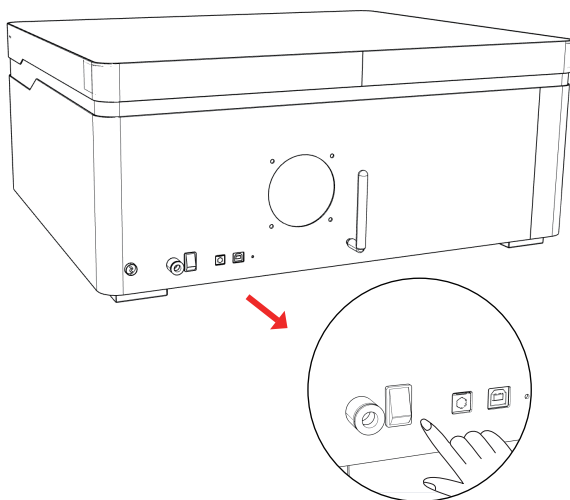

2. Remove the four screws on the back of the laser module, then take the laser module off from the X-Axis carefully.

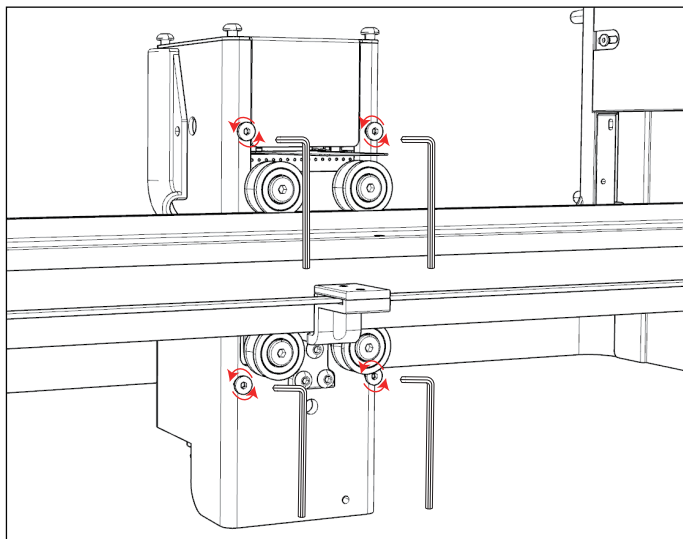

3. On the laser module's control board, open the black latch and pull out the connecting wire.

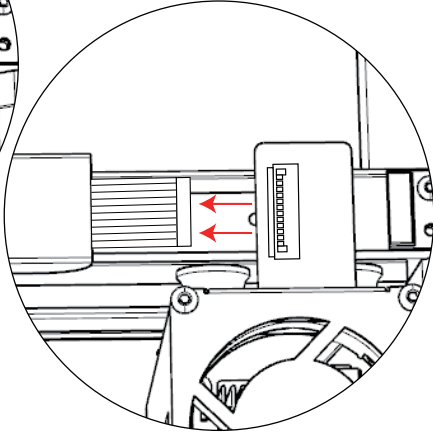
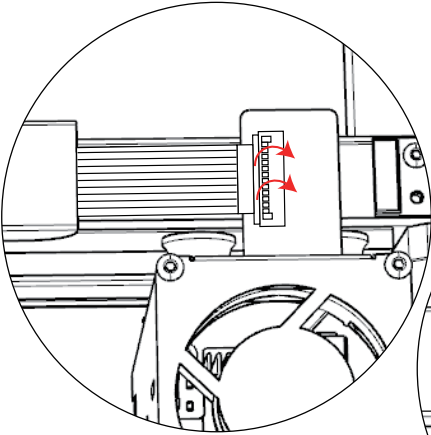
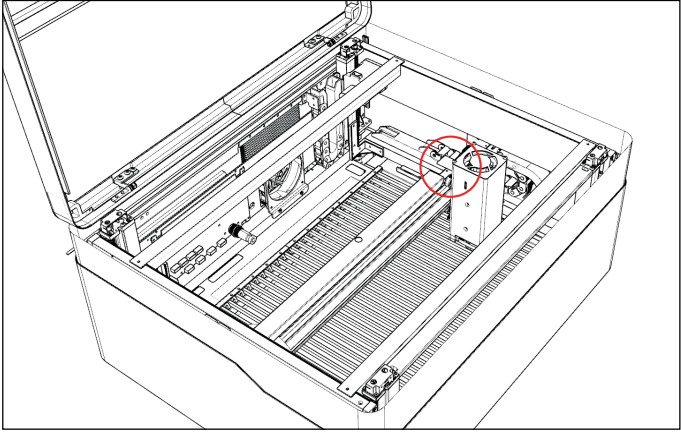

Step 2. Remove the air assist tube

The 2W laser module is mainly for metal or other materials that generate very little smoke during laser processing. So there is no need to use the air assist with the 2W laser module.

On the right end of the X-axis, find the air tube connector. Rotate to loosen the metal nut of the air tube connector and pull off the air tube.

Note: If it's difficult for your fingers to reach the area to rotate the nut, you can cut off the black cable tie there to get more operating space. You may use adhesive tape or cable tie to secure the metal connector on the machine end to prevent it from impacting the movement of the laser head in the future.

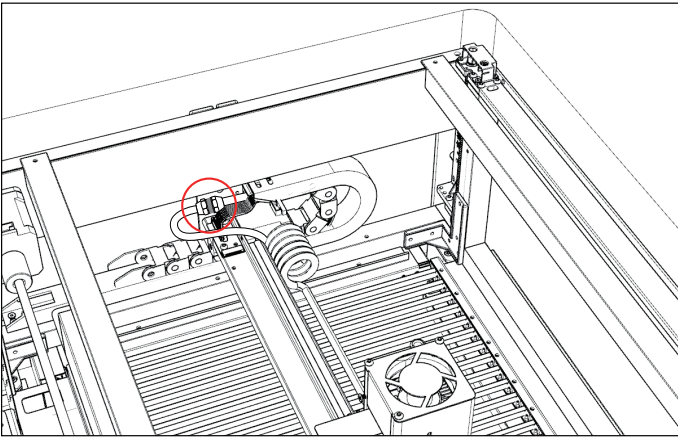

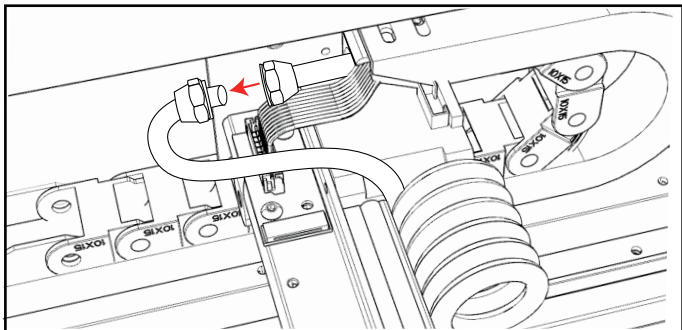
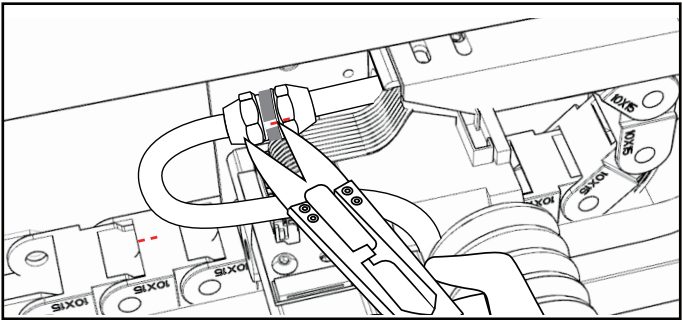
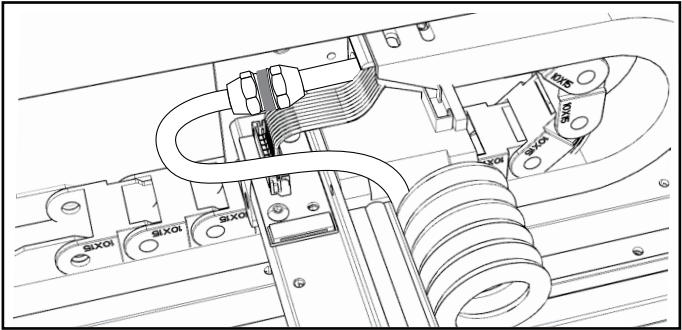

Step 3. Replace the adapter circuit board

1. Find the adapter circuit board on the right end of the X-axis. Unplug the wire harness carefully.

Note: If there is adhesive at the joint, please use tweezers to clamp the adhesive and then peel it off.

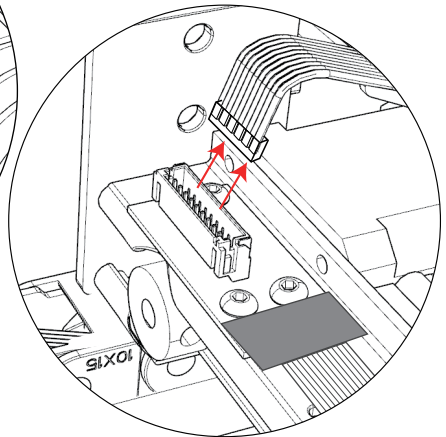
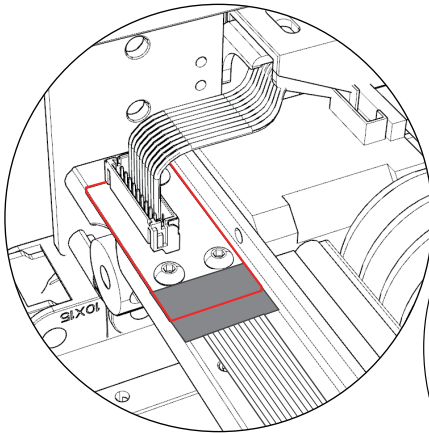
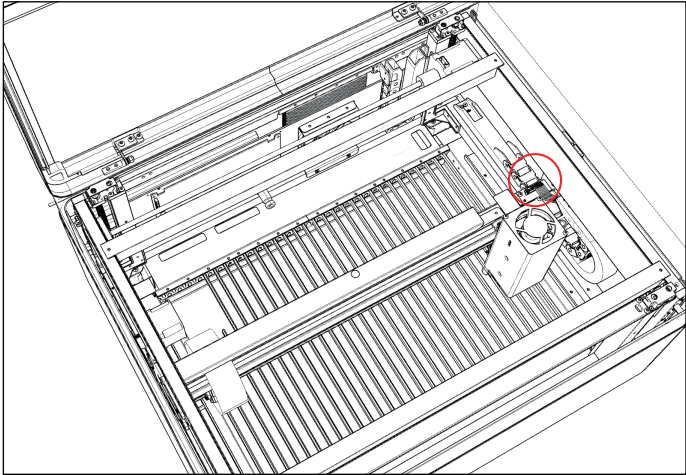

2. Uncover the black protective tape as shown in the figure below. Open the black latch and pull out the wire. Then take the 2 screws out and remove the board.

Note: Save the board if you are going to install the 20W laser module back in the future.

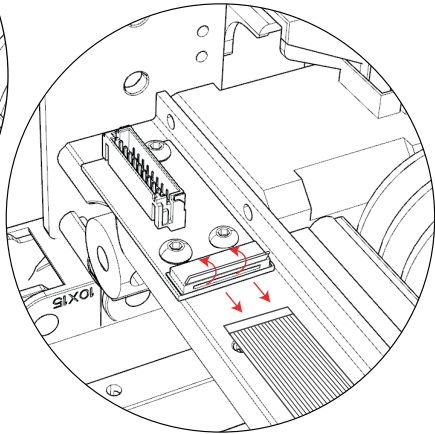
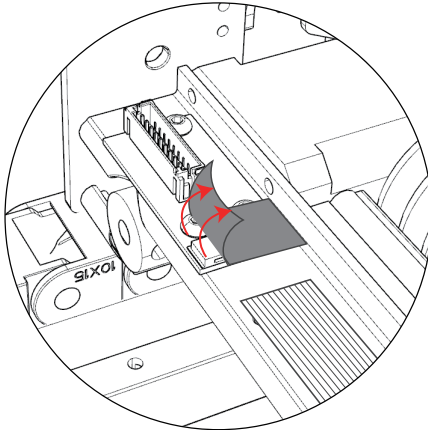
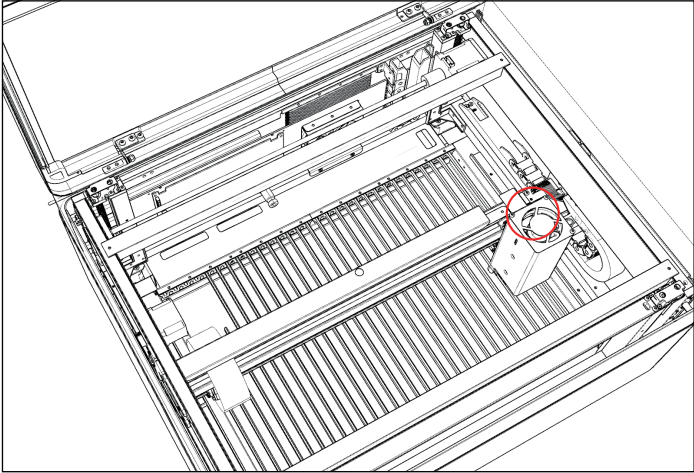

3. Install the new adapter circuit board supplied together with the 2W laser module, and secure the screws. Plug in the wire harness carefully. Connect the connection wire back, and press the black latch to secure the connection.

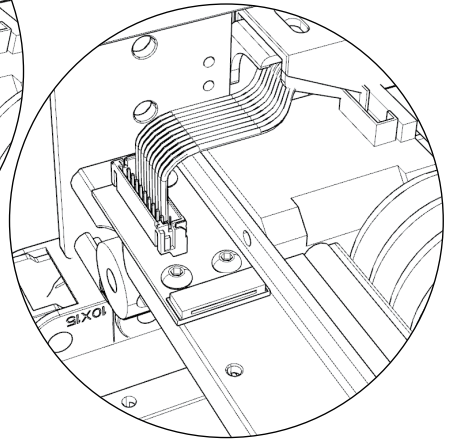
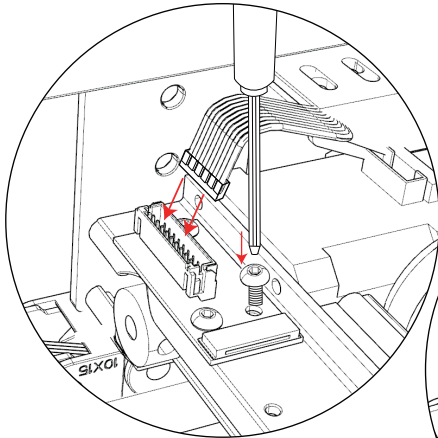
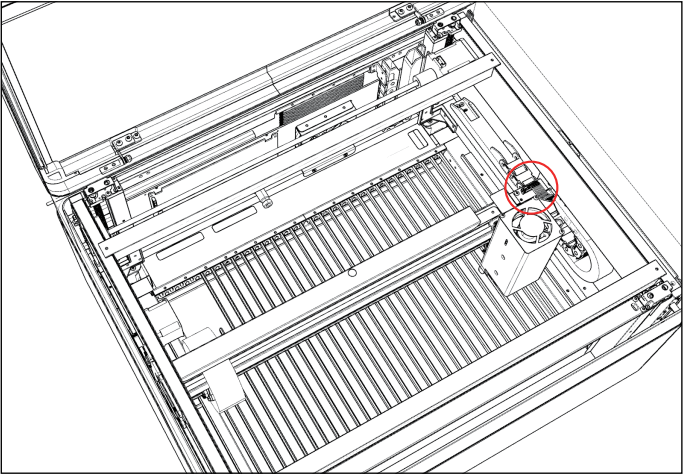

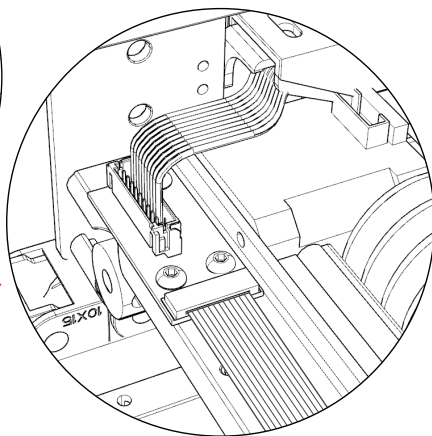
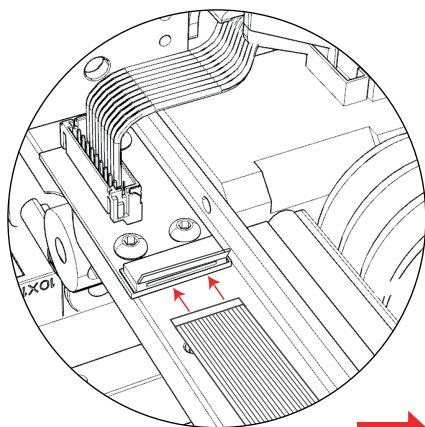
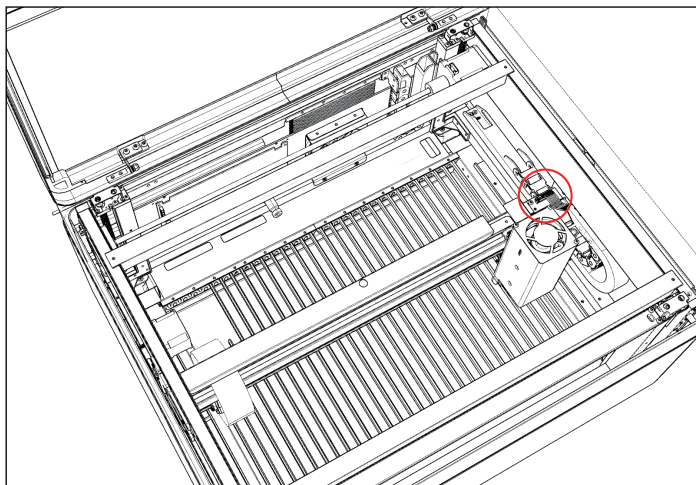

Step 4. Install the new laser module.

1. Align the laser module with the metal block on the X-axis and install the four screws in the positions shown in the figure

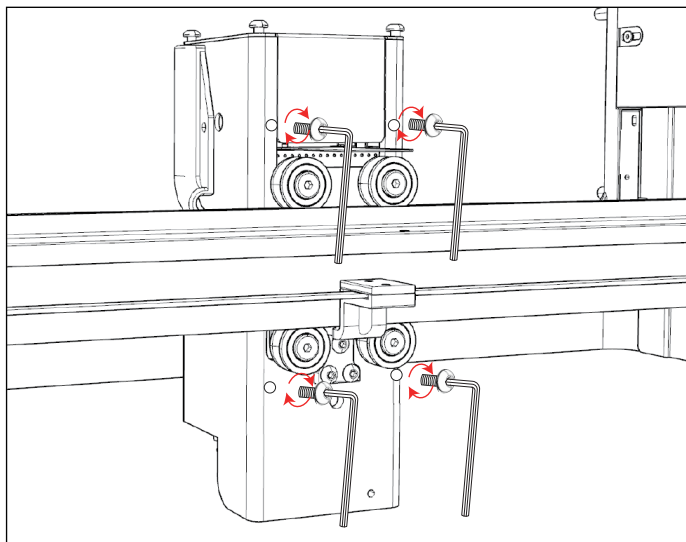

2. On the 2W laser module's control board, plug in the connecting wire and press the black latch to secure the connection.

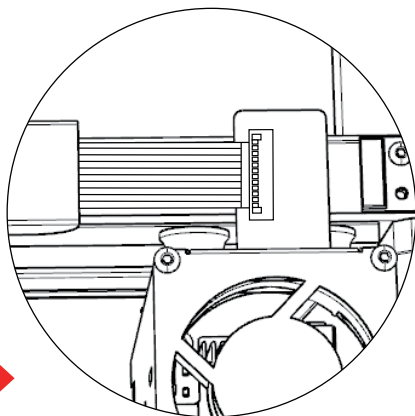
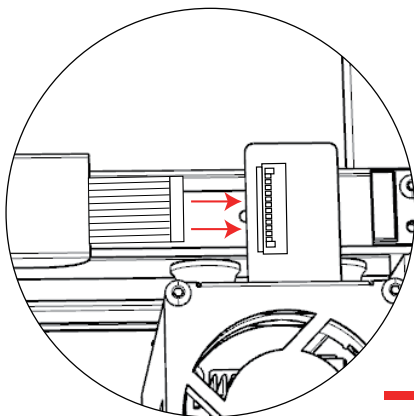
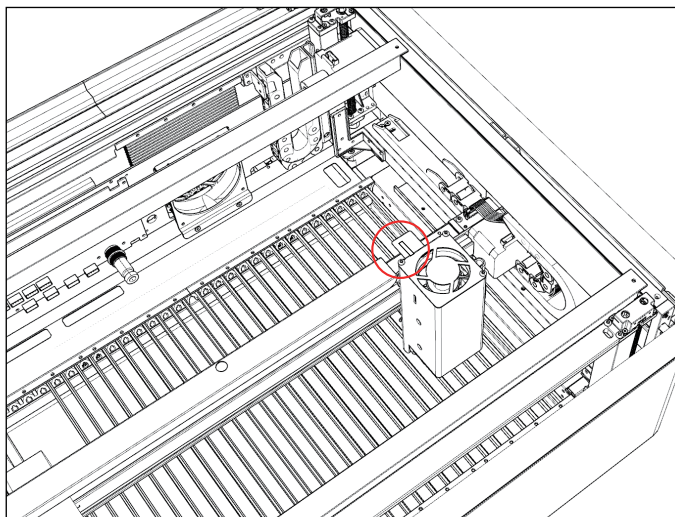

3. Congratulations! The installation is completed. Please turn on the machine, open the WeCreat Makelt software, and check the device list. It will show the 2W laser there.

FAQs

What should I do if the engraving effect is not as expected?

Due to the special working mechanism of the 2W laser head, it is necessary to wait for about one minute after each power-on of the machine to ensure that the laser head has been preheated completely to achieve the best engraving effect. For some models with a power-off mechanism when opening the cover (such as the Wecreat Vision EU version), please also wait for one minute before starting the engraving after opening or closing the cover.

Why does the laser's cooling fan always rotate?

We have implemented intelligent temperature control for the fan of this laser module, which can adjust the fan speed based on the temperature of the environment. As long as the machine is powered on, the cooling fan will start to work to ensure the laser head is at a suitable working temperature. If you find the noise disturbing, please turn off the machine after each use.