

Customer Support

Please visit the WeCreat Support Center for more setup, maintenance and application tutorials and questions.

<https://support.wecreat.com>

If you need more support, please try one of the following two options. We will get in touch with you as soon as possible.

1. Submit a support ticket at <https://support.wecreat.com>.
2. Directly send us an email: support@wecreat.com

Join Our Community.

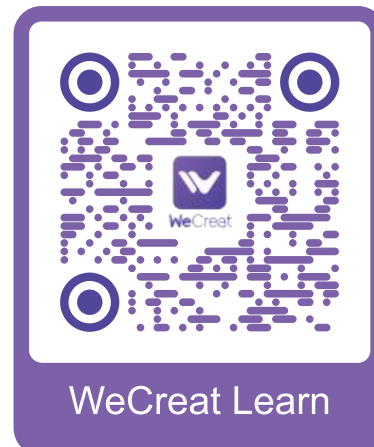

Download WeCreat Makeit!

Video Quick Start Guide

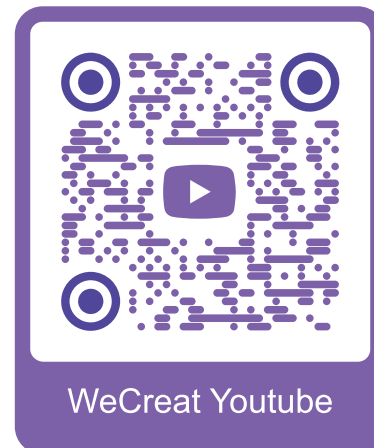

Let's Create with WeCreat!
www.wecreat.com



WeCreat Vision Pro 45W

Laser Engraving & Cutting Machine



USER MANUAL

Please review the entire guide before operating the device.

***Safety Notice:** Do not connect to power until setup is complete.

www.wecreat.com

Declaration

- Declaration.....1
- Safety.....2
- Meet Your WeCreat Vision Pro7
- What’ s In the Box.....10
- Product Setup14
- Software and Network.....20
- First Project25
- Using the Vision Pro with the Rotary Pro28
- Appendix35
- After-Sales Services39
- Warranty39

Declaration

The User's Manual (hereinafter referred to as the "Manual") is intended to provide detailed instructions for installing and operating the WeCreat Vision Pro. Through this manual, users will understand how to operate the laser safely and effectively to ensure optimal use.

Users must install and use according to the guidance of this Manual. The company does not assume responsibility for any damage or malfunction caused by not following the Manual's guidelines. The company is not responsible for any loss caused by unauthorized repair, modification, or improper use.

The compilation of this Manual aims to provide users with clear and accurate installation and usage guidance to promote the correct use of the laser machine, ensuring user safety and effective operation of the device.

The company is committed to continuously optimizing products and improving services. For any questions about the content of this Manual or any issues encountered during the use of the laser, please feel free to contact us for feedback: support@wecreat.com

The copyright of this Manual belongs to the company. This Manual and the information, diagrams, and logos contained herein are protected by copyright law. Without the company's explicit written authorization, no unit or individual may copy, reprint, excerpt, or utilize this Manual in any other form.

The company reserves the right to update this declaration and the content of the Manual at any time without further notice. If there are changes, please refer to the latest information published by the company.

Safety



Warning: Do not leave the device unattended when in operation.



Turn OFF device before plugging/unplugging.



If the machine operates with setting errors and is left unattended for an extended period of time, or if a mechanical or electrical fault occurs, it may lead to a fire.



Keep explosive and flammable materials away from the device.
Do not stack materials (such as paper) around the machine.
They may cause the spread of flames and increase the risk of material ignition.



Please do not lean on the machine top cover or place heavy objects on it. As this will affect the balance of the machine and cause failure to the auto lifting function. When the machine is not in use for a long time, we recommend to adjust the machine to Idle mode or Transportation mode.



Safety

Please follow the operating principles:

1. Prior to each use, inspect the machine for any damage. Do not operate the machine if any damage or defects are detected.
2. Ensure that the workspace is clean and level.
3. Unauthorized disassembly or alteration of the machine's structure is strictly prohibited. Do not modify or decompile its operating system.
4. Maintain cleanliness inside the machine. Residues and debris accumulated during cutting and engraving can be hazardous and may cause a fire. Regularly remove chippings and residues.
5. Do not operate the machine when the lid is open. Always ensure the lid is closed before operating the machine.

WeCreat Vision Pro is certified as a Class 1 laser product containing an embedded Class 4 laser module. The following label information applies to the WeCreat Vision Pro product and its laser module.

WeCreat Vision Pro

WeCreat Vision Pro

Model Number: LC2450
Company Name: WeCreat Tech Limited
Supply Voltage: 100V-240V
DC24V 10A 240W
Contains FCC ID: 2AATL-6223A-SRD
Operating Temperature: 0 °C ~ 40 °C (32°F ~ 104°F)
Storage temperature: 0 °C ~ 45 °C (32°F ~ 113°F)
Made in China

This device complies with Part 15 of the FCC Rules.
Operation is subject to the following two conditions:
(1) This device may not cause harmful interference, and
(2) This device must accept any interference received, including interference that may cause undesired operation.

Company Address: Room 501, Block 18 RuiYuan,
TaoYuan District, Nanshan, Shenzhen



WeCreat Vision Pro's Laser module

WeCreat

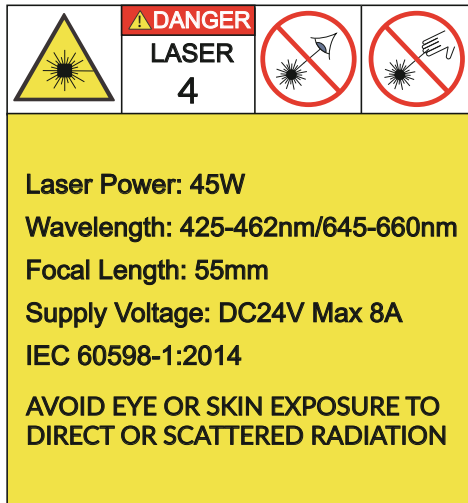

Caution! Use of controls or adjustments or performance of procedures other than those specified herein may result in hazardous radiation exposure.

FCC Statement

This device complies with Part 15 of the FCC Rules. Operation is subject to the following two conditions:

1. This device may not cause harmful interference, and
2. This device must accept any interference received, including interference that may cause undesired operation.

Warning: Changes or modifications not expressly approved by the party responsible for compliance could void the user's authority to operate the equipment.

Note: This equipment has been tested and found to comply with the limits for a Class B digital device, pursuant to Part 15 of the FCC Rules. These limits are designed to provide reasonable protection against harmful interference in a residential installation.

Safety

This equipment generates, uses, and can radiate radio frequency energy and, if not installed and used in accordance with the instructions, may cause harmful interference to radio communications. However, there is no guarantee that interference will not occur in a particular installation.

EU Declaration of Conformity

Hereby, WeCreat Tech Limited declares that the radio equipment type WeCreat Vision is in compliance with Directive 2014/53/EU and Machinery Directive 2006/42/EC. The full text of the EU Declaration of Conformity is available at the following internet address:

<https://support.wecreat.com/hc/en-us/articles/8677731019151-WeCreat-Vision-EU-Declaration-of-Conformity>

RF exposure statement

RF exposure information: The Maximum Permissible Exposure (MPE) level has been calculated based on a distance of $d=20$ cm between the device and the human body. To maintain compliance with RF exposure requirements, use product that maintain a 20cm distance between the device and the human body.

This device may be used in each member state.

Wireless Specifications

Bluetooth

Wireless Technology: BLE 5.0
Operating Frequency: 2402-2480MHz
Transmit Output Power: $\leq 5\text{dBm}$

2.4GHz Wi-Fi

Wireless Connectivity: IEEE 802.11b/g/n, up to 40MHz
Operating Frequency: 2412-2452MHz
Transmit Output Power: $\leq 15\text{dBm}$

Main Specifications

Laser radiation output: 45 W
Wavelength: 452 - 462 nm / 645 - 660 nm
IEC 60825-1:2014

Safety

Dimensions	Rated Laser Power
680*530*393mm 23.19"*20.91"*15.47"	45W
Package size	Max Engraving Speed
800*650*410mm	600mm/s
31.49"*25.59"*16.14"	Motion Accuracy
Weight	0.01mm
Gross weight: 35kg (77.16lbs)	Z-axis Movement
Electrical Requirements	140mm (5.51")
100-240 VAC, 50/60 Hz	Laser head Lifespan
Max: 240W	10000h
Air Assist	Safety Guard
30Kpa, 30L/min	Class I (FDA Certified)
Auto lifting	Laser Spot
140mm (5.51") without laser bed	0.15*0.15 mm
100mm (3.94") with laser bed	Autofocus
	Laser Radar

Meet Your WeCreat Vision Pro

For a video Quick Start Guide, please visit wecreat.com/learn or scan this QR code to view.



- 1** Start/Pause Button
(Status Indicator: Blue-Idle, Green-Processing, Red-Error)
Long press it to cancel the project
- 2** Detachable Tray

Meet Your WeCreat Vision Pro

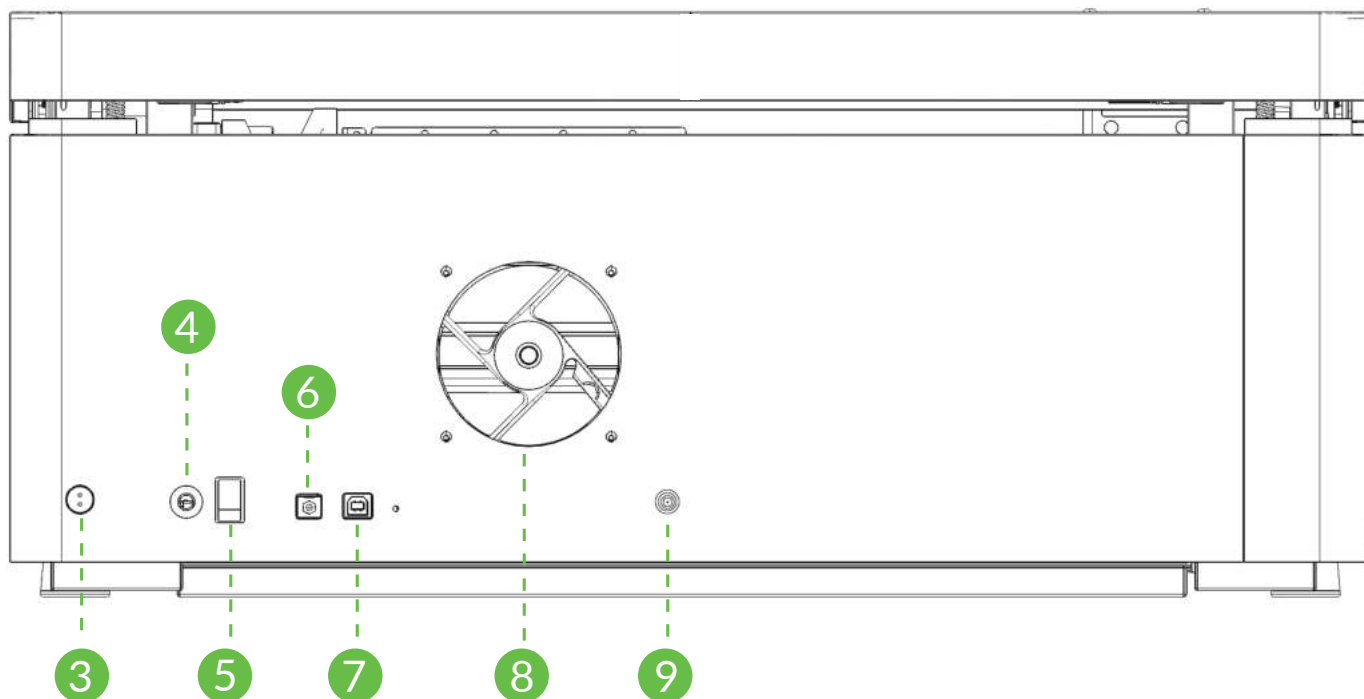

3 Air Assist Power Port

4 Air Assist Input Port

5 Power Switch

6 Power Port

7 USB Port

8 Exhaust Port

9 Wi-Fi Antenna Port

Meet Your WeCreat Vision Pro

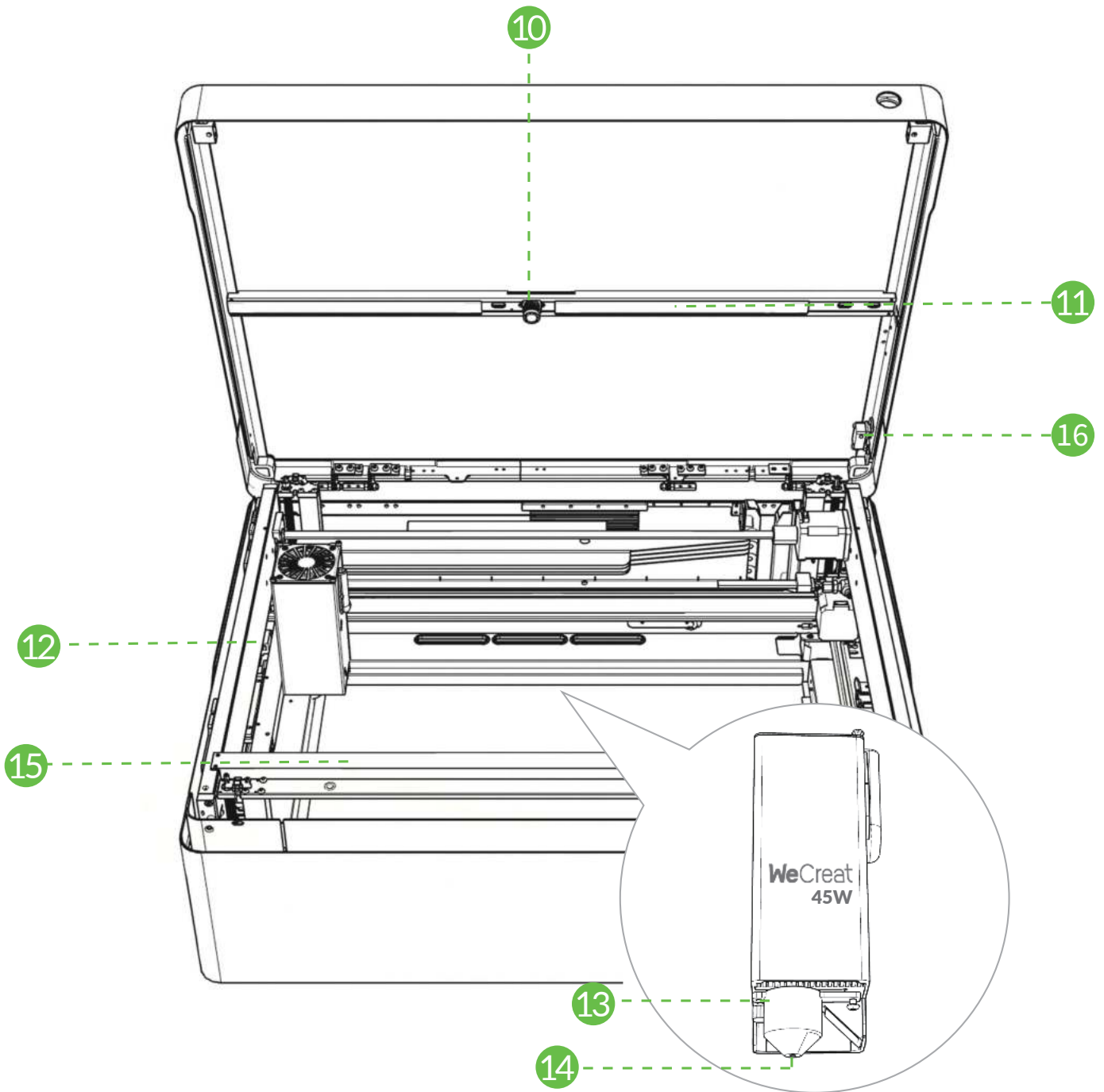

- 10 Camera
- 11 LED Strip
- 12 Laser Head
- 13 Air Nozzle
- 14 Laser Outlet
- 15 LED strip
- 16 LED Sensor

What's In the Box

Unpack to take out the WeCreat Vision Pro main product and check together with all included parts and accessories. If the product is severely damaged or any part is lost, please refrain from using it and get in touch with WeCreat customer service at support@wecreat.com. Packaging methods may vary on different production batches.

Package method 1

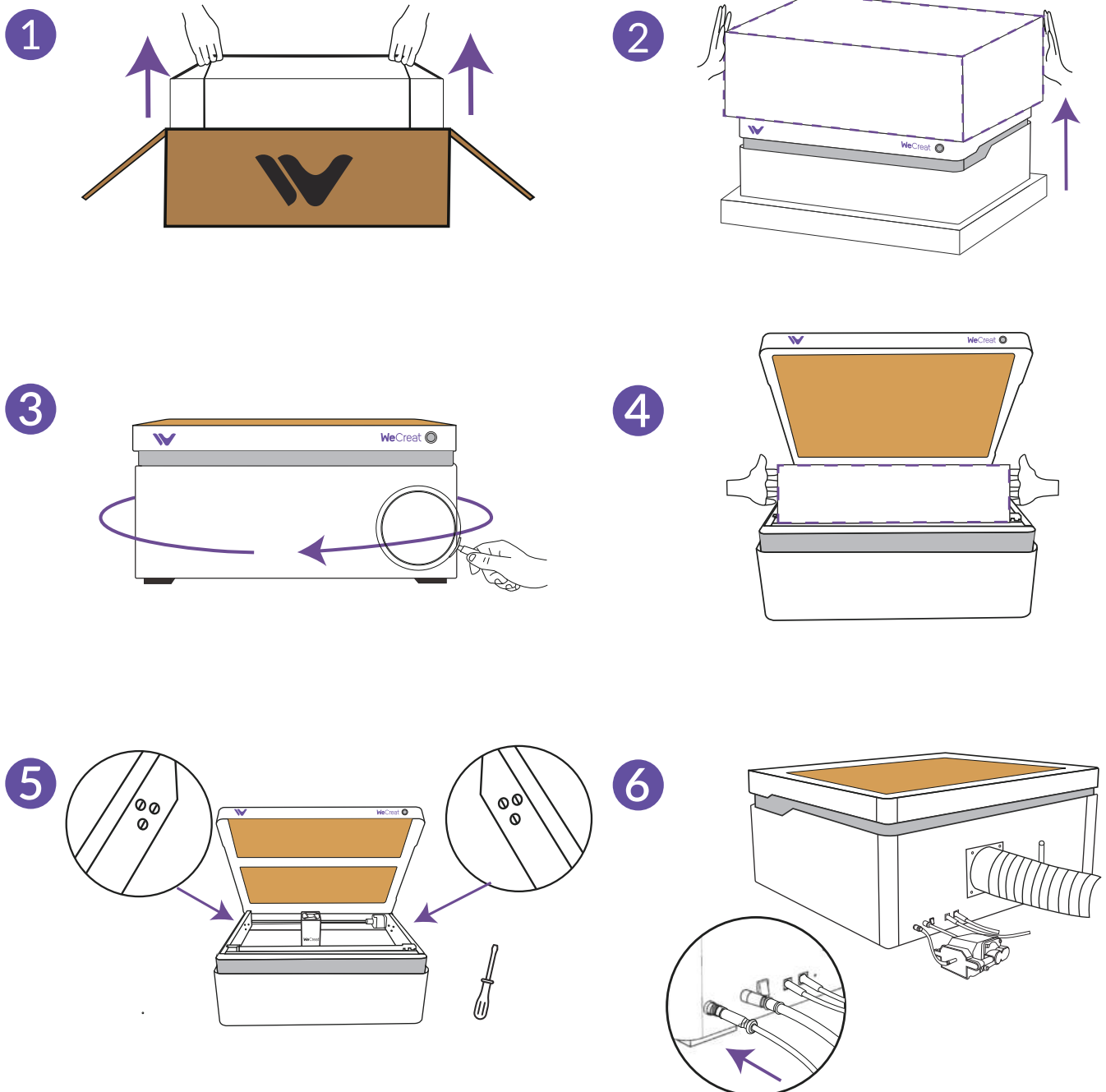

What's In the Box



User Manual *1

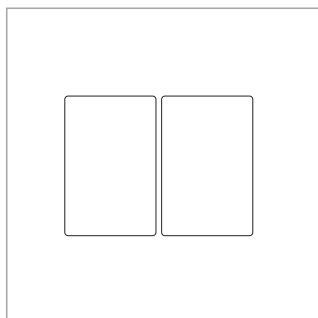

Sample *1

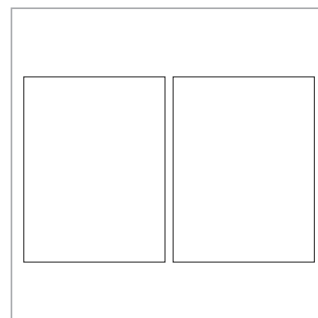

Basswood *1

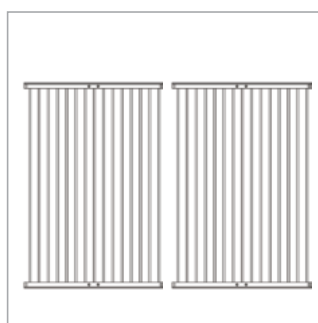

Laser Bed *1

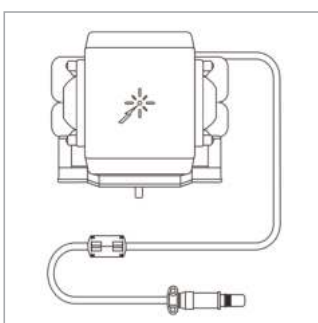

Air Assist Set *1

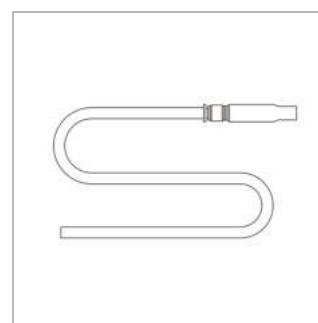

Air Assist Tube *1

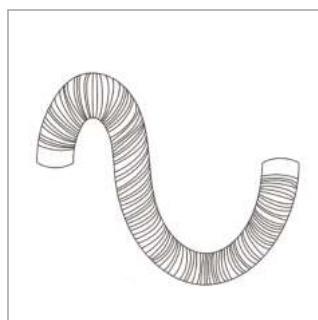

1.5m (4ft 11.05 inches)
Exhaust Hose *1

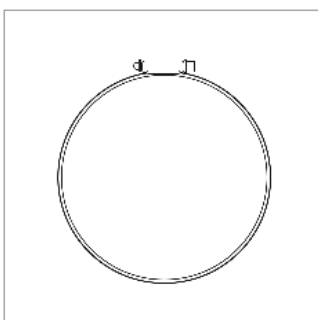

Exhaust Hose
Clamp *1

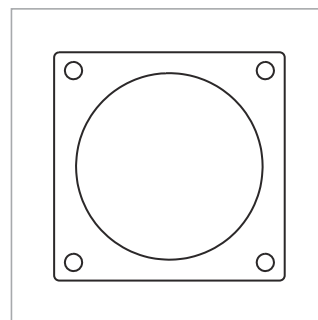

Exhaust Hose
Connector *1

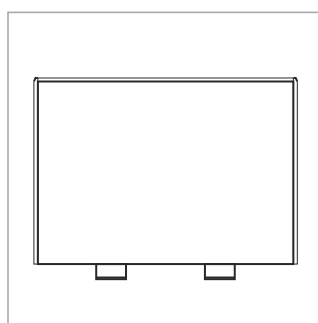

Detachable Tray*1

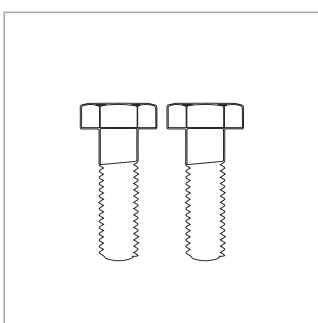

Spare Screws *1

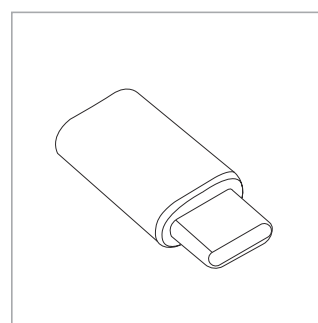

USB type-c Converter*1

What's In the Box

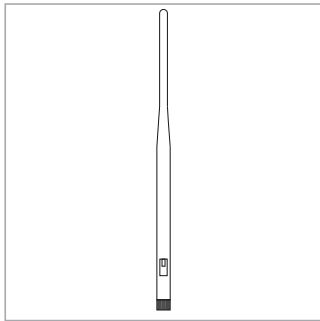

Wi-Fi Antenna *1

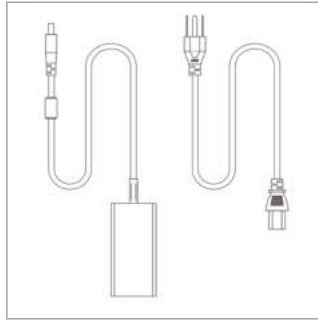

Power Cord *1

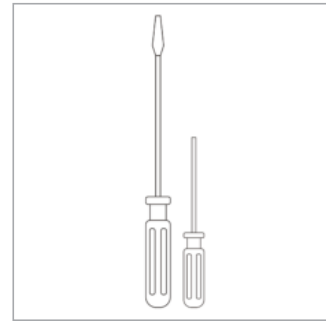

Screwdriver *1

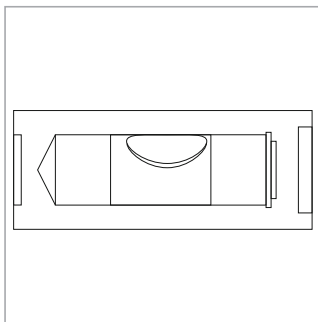

Mini Level*1

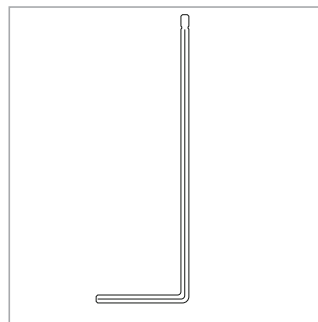

Hex Key *1

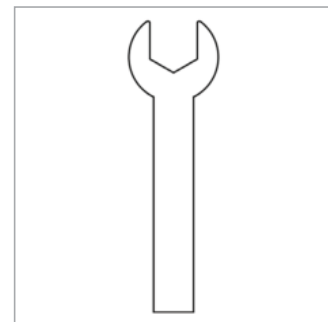

Wrench *1

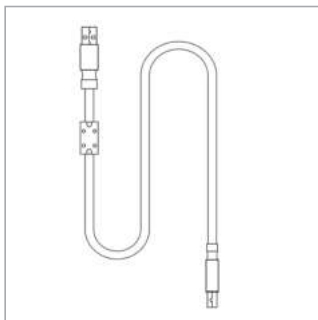

USB Cable*1

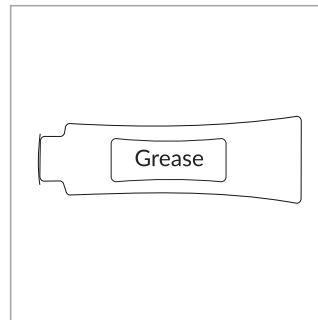

Grease *1

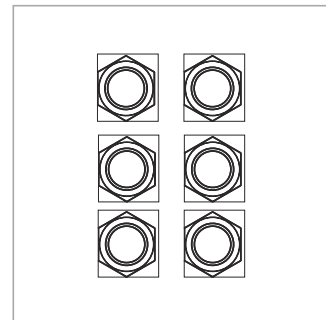

Spare Nuts *1

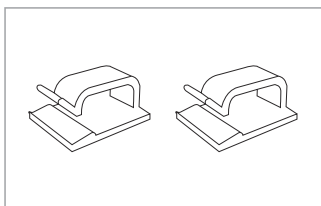

Cable Clamp*1

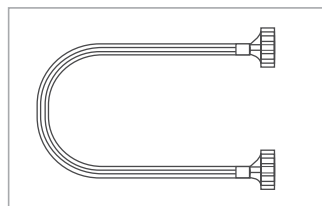

Spare Connection Wire*1

⚠ Save the packaging! If you would like to move your WeCreat Vision Pro, or ship it (for example, for gift or warranty purpose), check this manual or our unboxing video to learn how to pack it in the right way. Only the original boxes and foams can ensure a safe transportation.

What's In the Box

Available with WeCreat Vision Pro Rotary Pack:

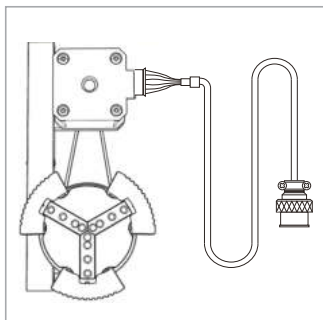

Rotary Pro *1

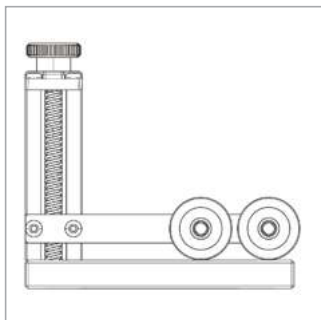

Rotary Holder *1

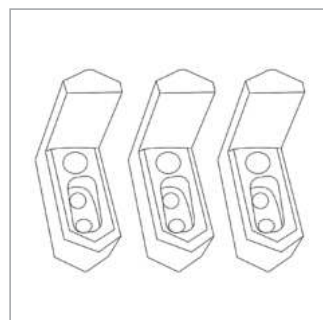

Single-step Jaw Component*1

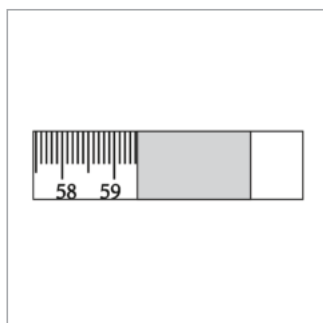

Tape Measure *1

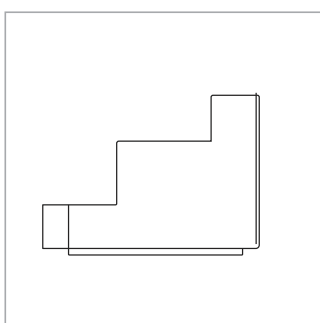

Double-step Jaw Component*3

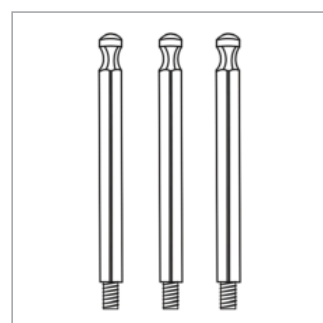

Threaded Stud *1

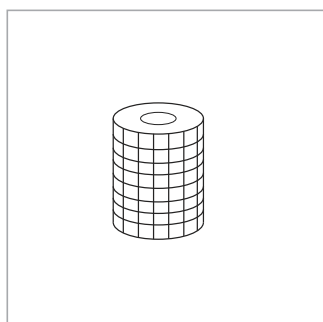

Silicone Grip*3

Product Setup

1. Install the exhaust hose connector with the small wrench and nuts supplied. Use the hose clamp to hold the exhaust hose.

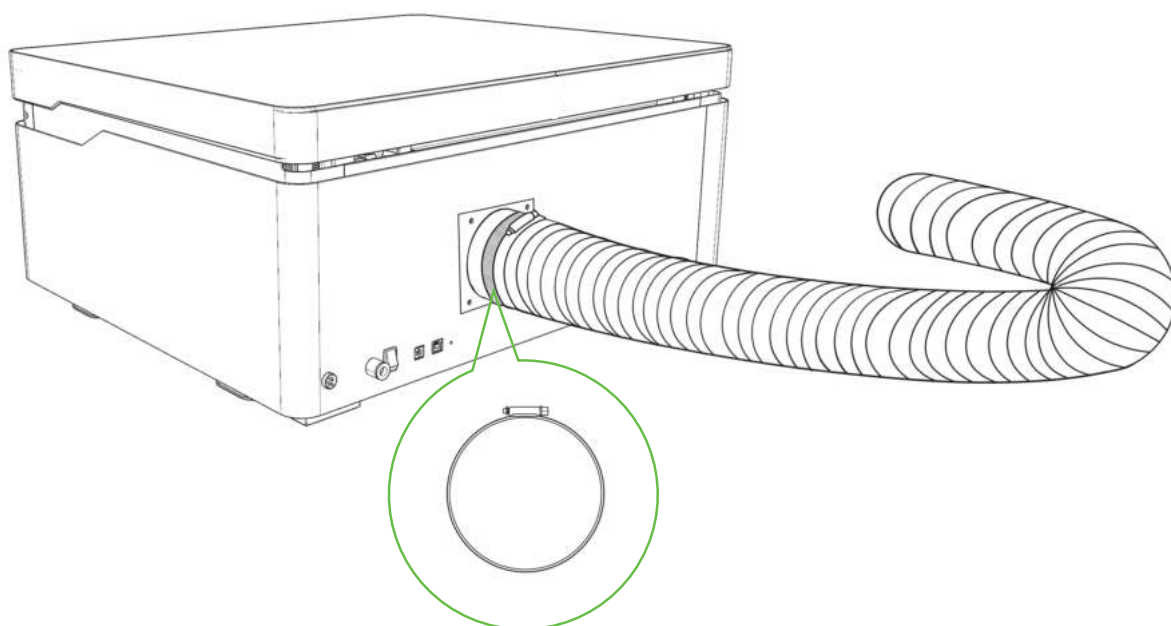
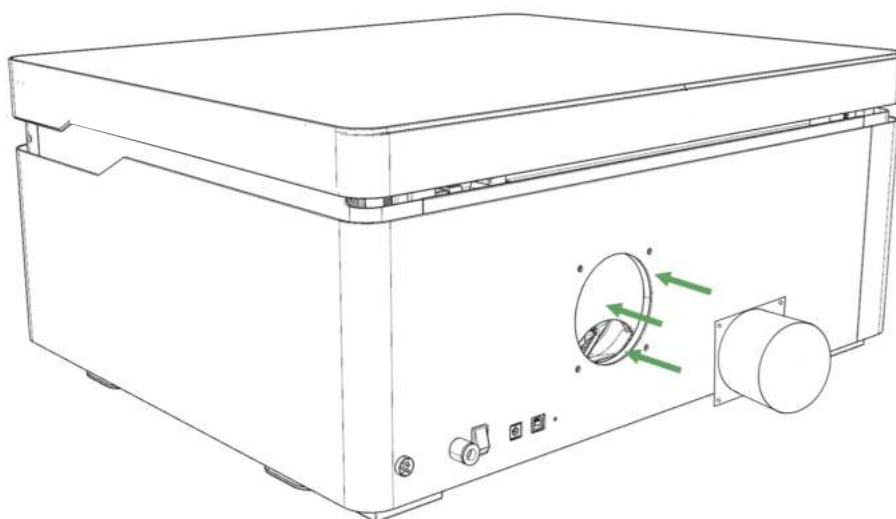

Product Setup

- 2 Put the other end of the hose outside of the window, or connect to the WeCreat Fume Extractor (sold separately).

Note: When the WeCreat Vision Pro is not in use, disconnect the hose from the machine or remove it from the window to avoid moisture/dust come into the machine and cause damage.



Using an exhaust hose extension may weaken the exhausting capacity of the machine, resulting in smoke leakage.

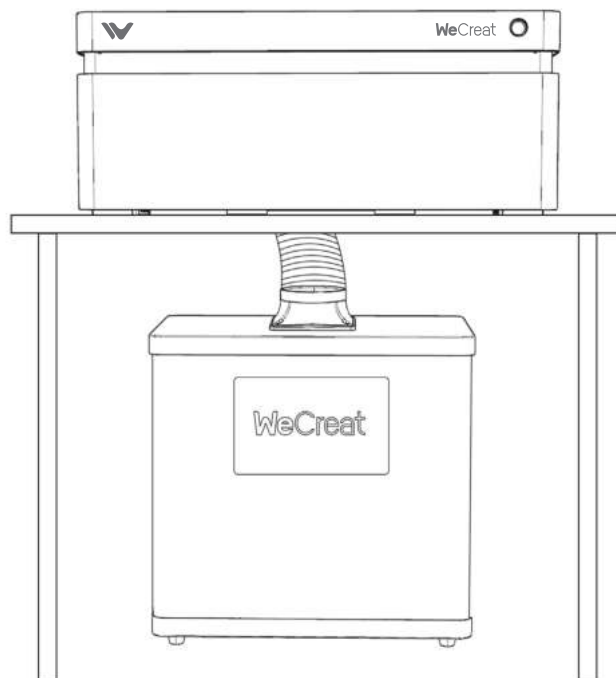
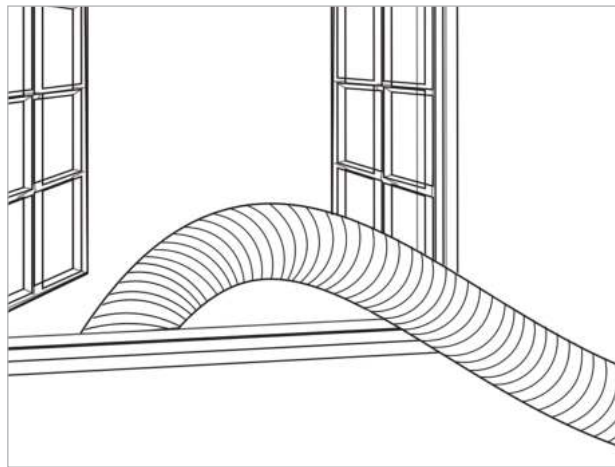

Product Setup

- 3 — Connect the Air Assist. Note: If you wish to unplug the air tube, press and hold the black annular valve to pull out the tube.

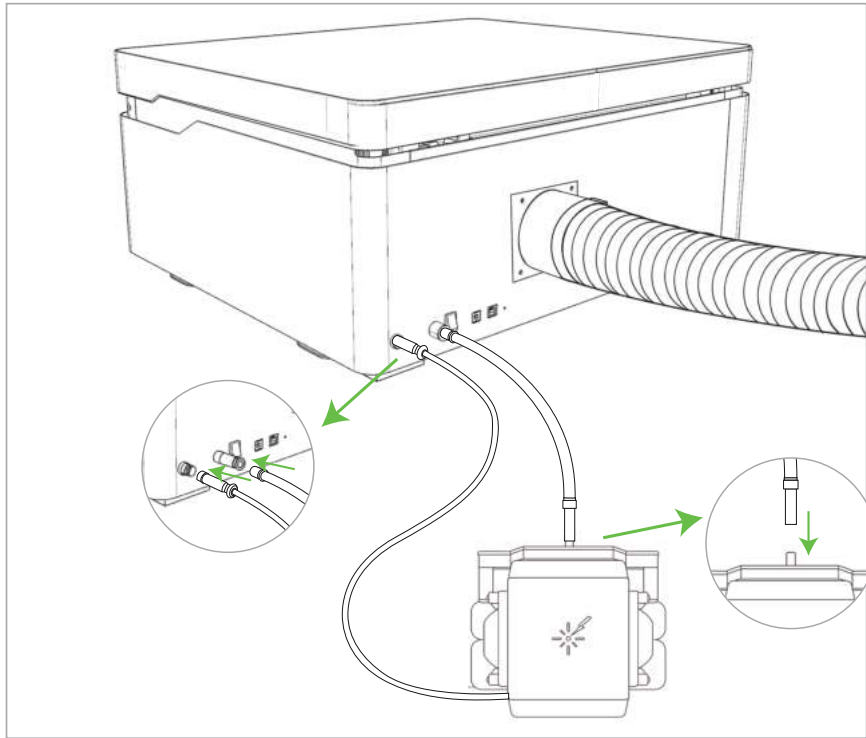

- 4 — Connect the Wi-Fi antenna.

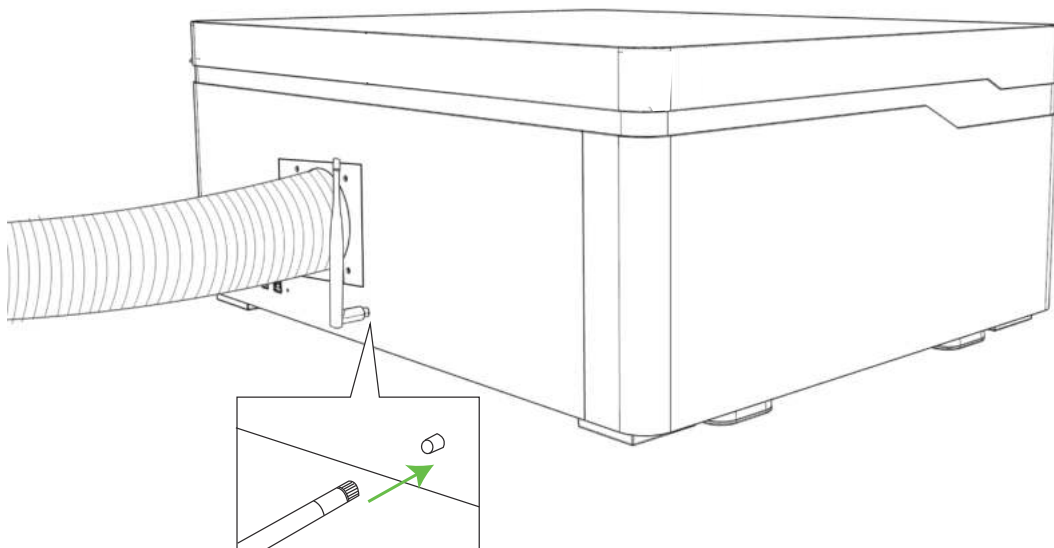

Product Setup

- 5 — Lift up the machine a little and insert the tray from the bottom of the machine along the guide rail.

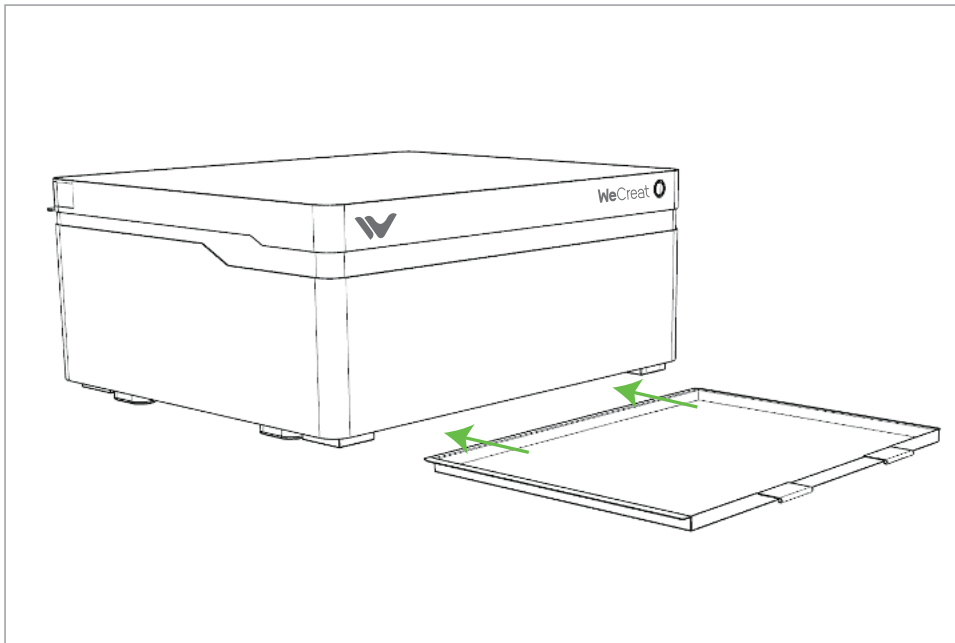

- 6 — Connect the power supply.

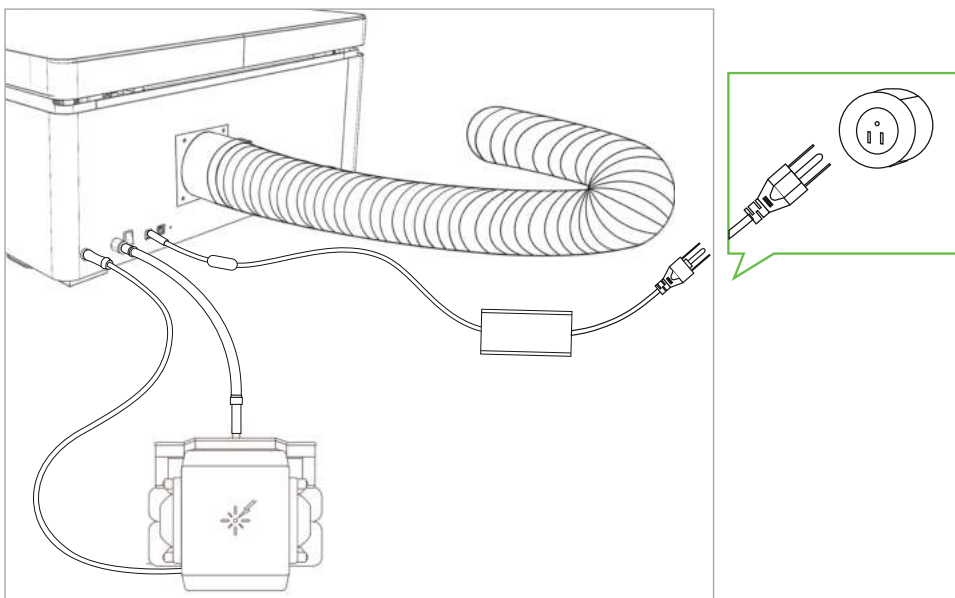

Product Setup

- 7 — Remove the Transport Guard Screws.

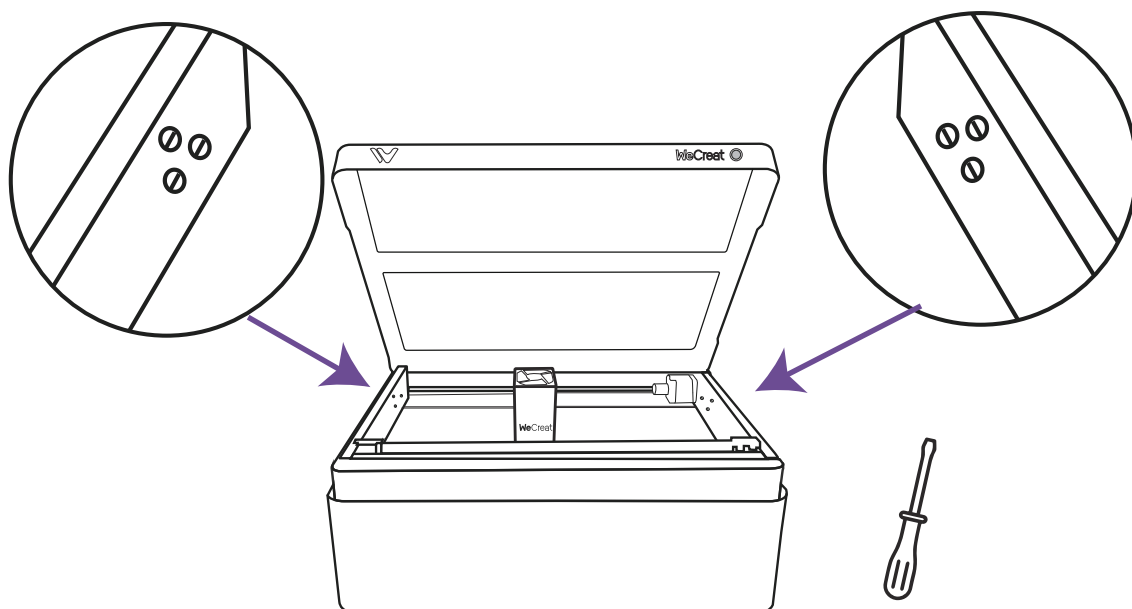

- 8 — Turn on the power switch. WeCreat Vision Pro will power on, emit a beep, and then rise up.

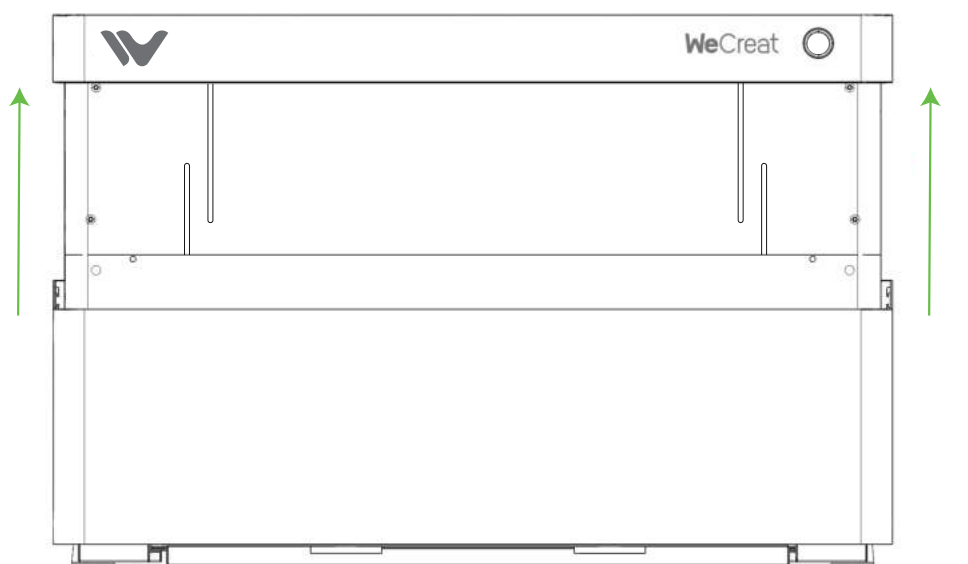

Product Setup

9. Place the laser beds flatly into the compartment and make sure the detachable tray is in place.

Note: Please make sure that the side of the frame with screws faces up.

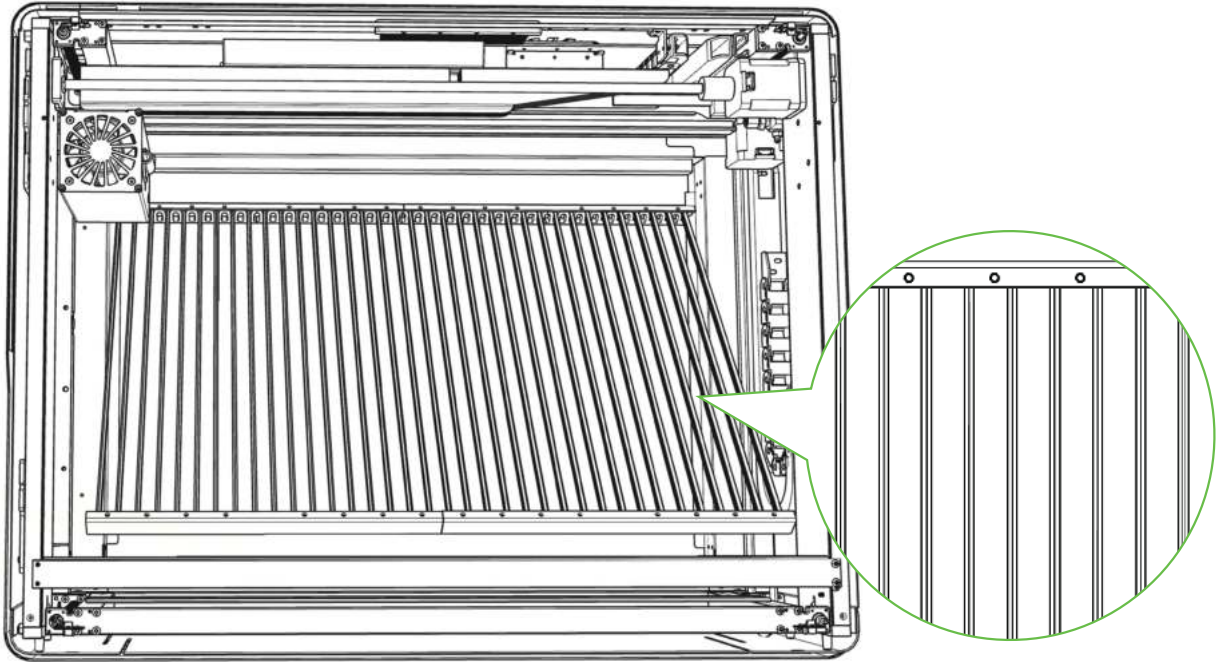

At this point, we have completed all the hardware installation steps. In the next chapter, we will introduce how to install and use the software. However, in order to ensure that the machine does not have potential problems caused by pressure or impact during transportation, or if you encounter some abnormalities during the power on process, we recommend that you refer to Appendix and do some check.

Appendix 1. Ensure the Z-axes are on the same plane

Software and Network

1. Visit <https://wecreat.com/pages/software> on your computer and download the WeCreat Makeit! App. Click Yes when you are asked "Do you want to allow this app to make changes to your device?" and then continue the installation as prompted.
2. Use the supplied USB cable to connect the machine to your computer. Open the WeCreat Makeit! Software and click the 'Profile' button to create or log in to your WeCreat account.

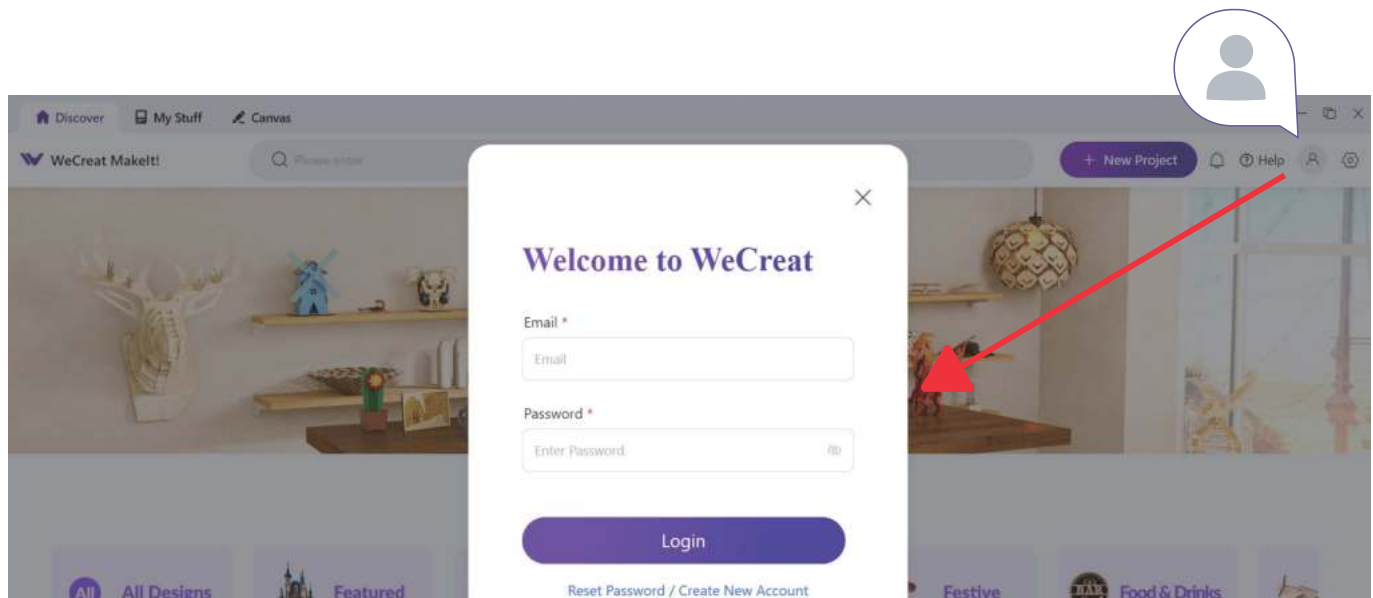

3. Once you have successfully logged in, click the New Project button.

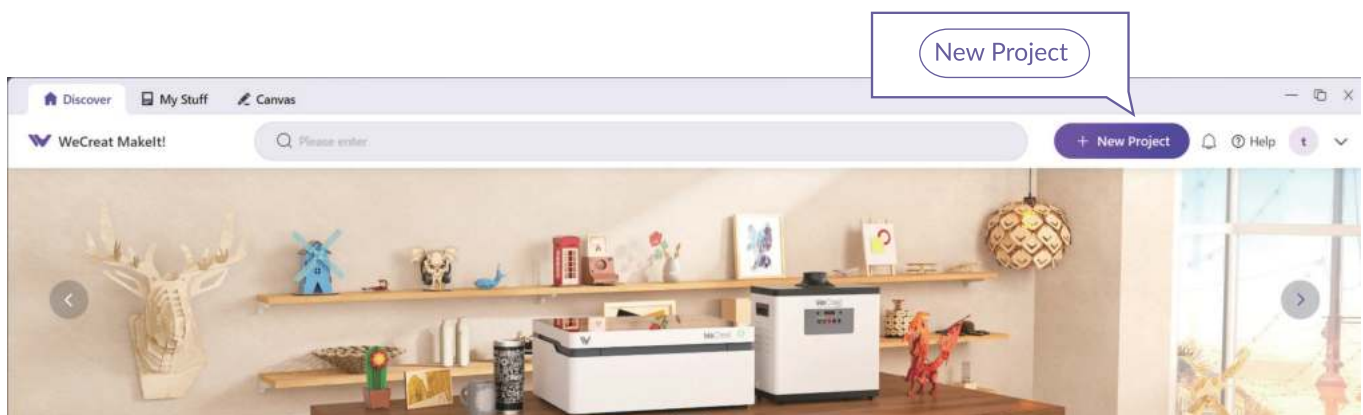

Software and Network

Note: For Windows operating system, it may ask you to install the USB driver first, please follow the prompts to finish the installation.

4. In the device list of the right menu bar, you will see the device name with a USB icon, that means the machine is ready for USB connection, please click on it to establish the connection between the machine and your computer. Then you can start creating new projects.

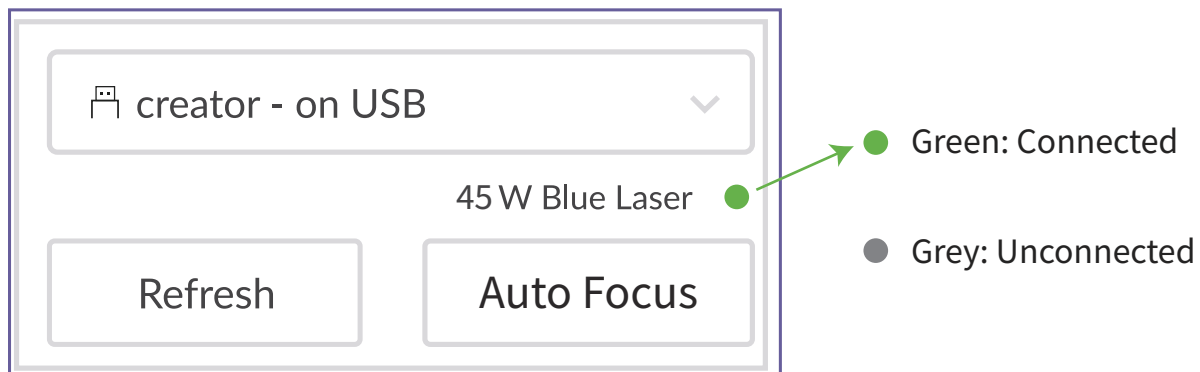

5. You may wish to connect the WeCreat Vision Pro via Wi-Fi instead of a USB cable connection. If so, please click the Settings button on the menu bar, and go to WiFi settings. Note: Don't disconnect the USB cable until Wi-Fi setup is complete.

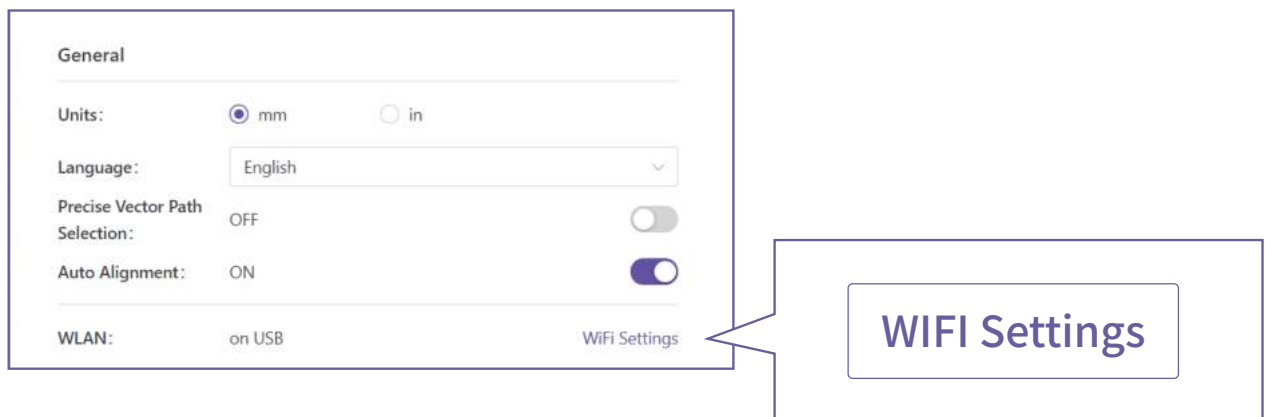

Software and Network

6. Select your home network and connect to it. Input your Wi-Fi password if required.

Note: This product doesn't support 5GHz Wi-Fi connection. Please ensure your Wi-Fi modem/router supports and has activated the 2.4GHz connection.

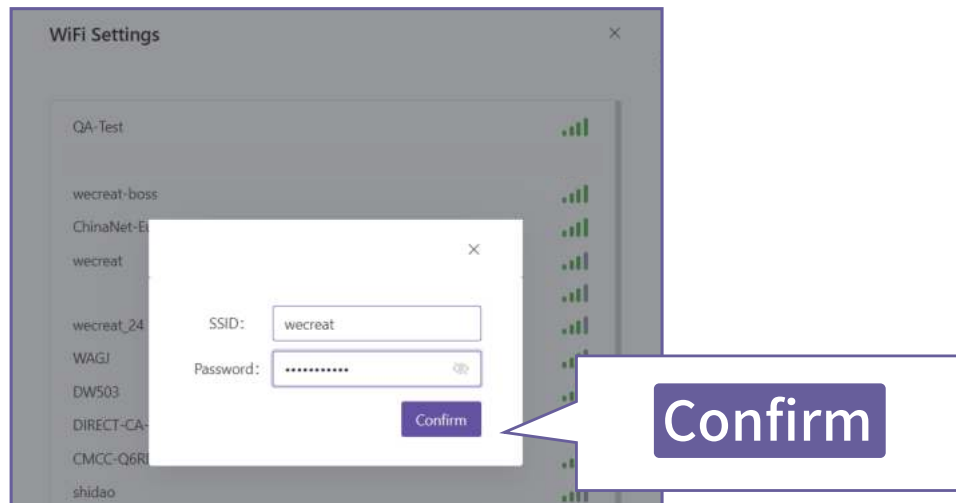

7. When you see the message “Wi-Fi connected successfully”, close the settings window. Then you will see the machine is shown in the device list with a green dot on the right side, which means you are now connected to Vision Pro wirelessly, eliminating the need for a USB connection.

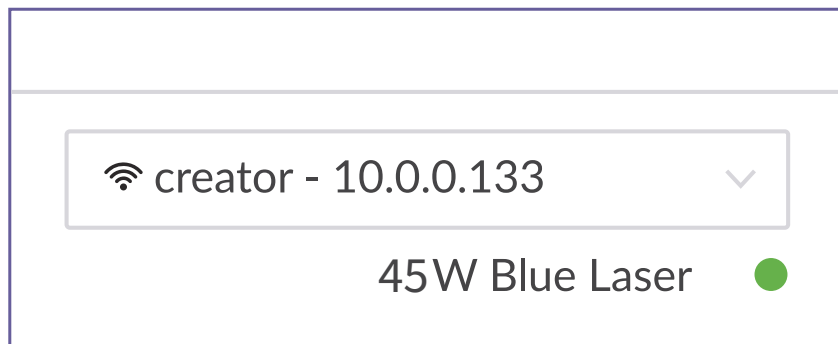

Note: Sometimes due to the compatibility issue with specific Wi-Fi modem/routers, issues may arise with showing the machine's name in the device list, in that case you can manually add the device as follows:

Software and Network

- ① Keep the USB cable connected between your computer and WeCreat Vision Pro.
- ② Open the Settings window, find the WLAN IP address, and write it down.

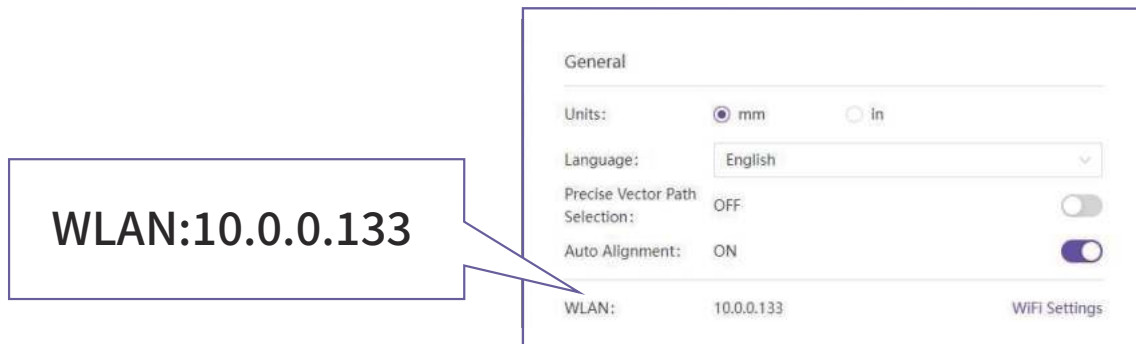

- ③ Navigate to the right side menu bar, click on the device list and click Add+. In the pop-up window, click on IP address tab, put in the IP address which you have just written down, then click Connect.

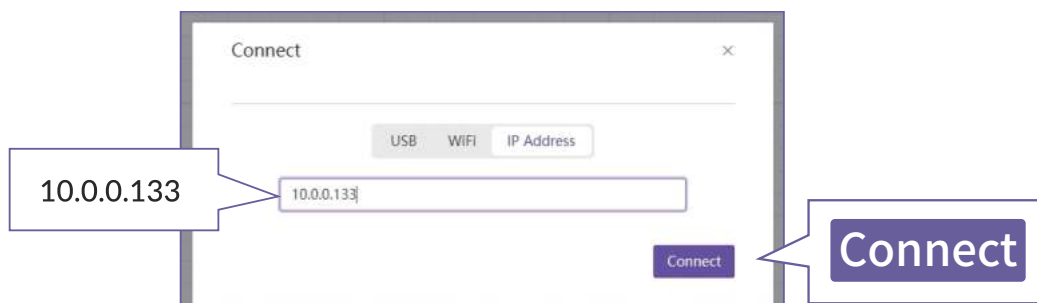
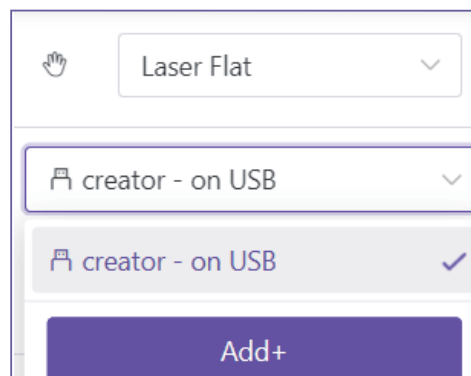

Software and Network

- ④ Now please check if the wireless connection is established.

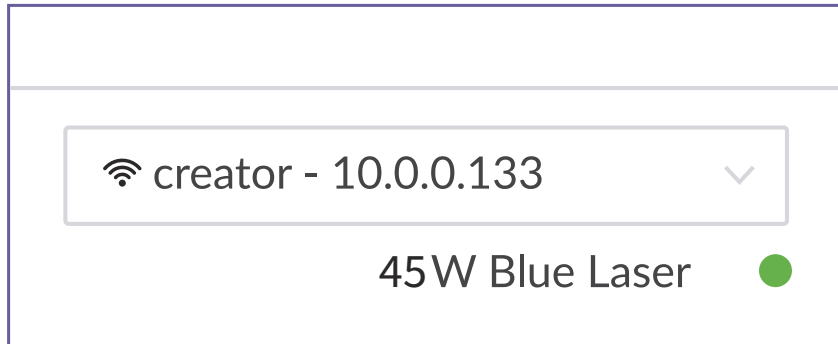

If you still encounter issues with establishing the Wi-Fi connection, please feel free to contact us at support@wecreat.com, our helpful and friendly support engineers are just one click away!

First Project

1. Open Makelt and click New Project.

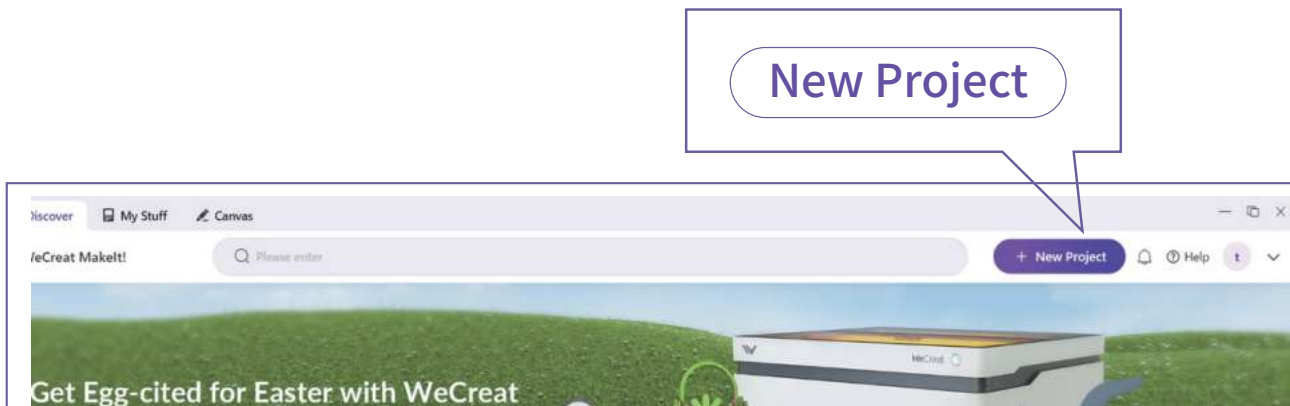

2. Open the lid and place the 3mm small sample wood that comes with the package. Click on refresh to show the wood position.
*Ensure the laser is connected either via USB or WiFi and you should be able to see a green dot on the right status bar.

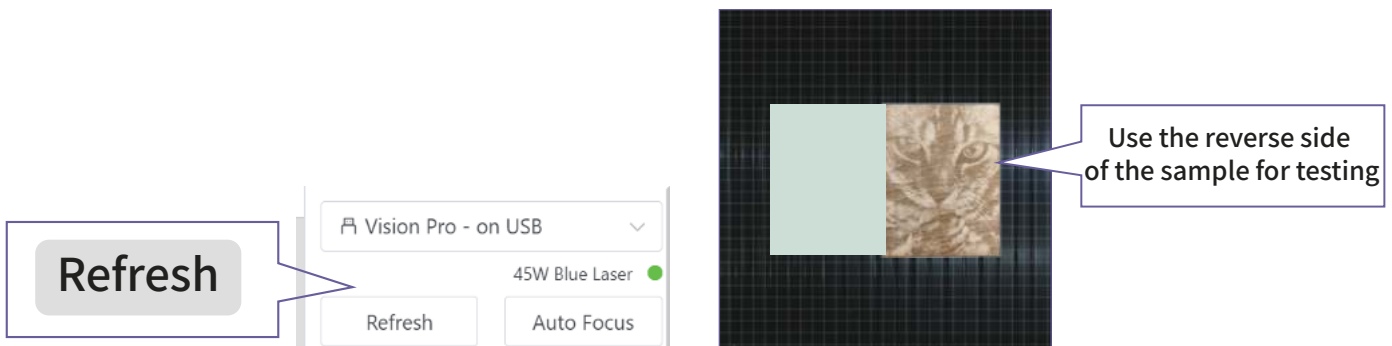

3. Select Text in the left side menu, then click on the canvas to insert the text. You can double-click the text area to edit it, or drag it to zoom in/out and adjust its position.

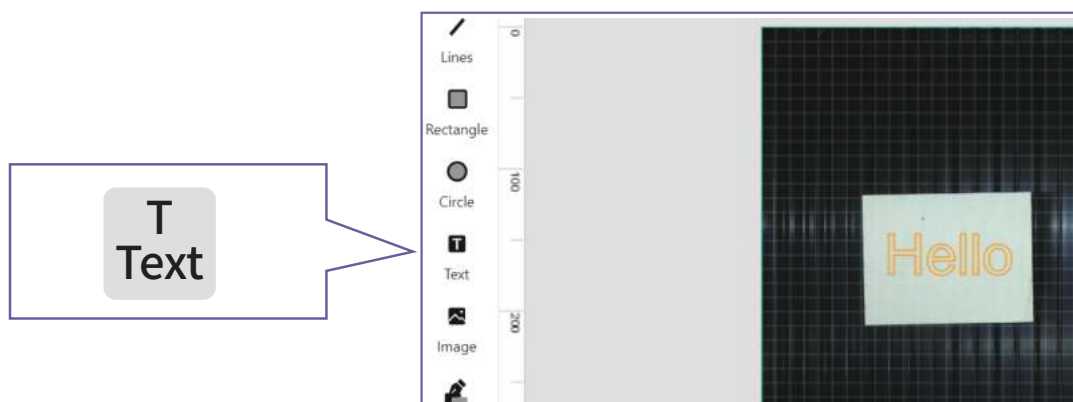

First Project

4. Drag the mouse to select the text, choose Line Engrave on the right side menu, adjust the Power and Speed settings accordingly, or simply keep the default settings.

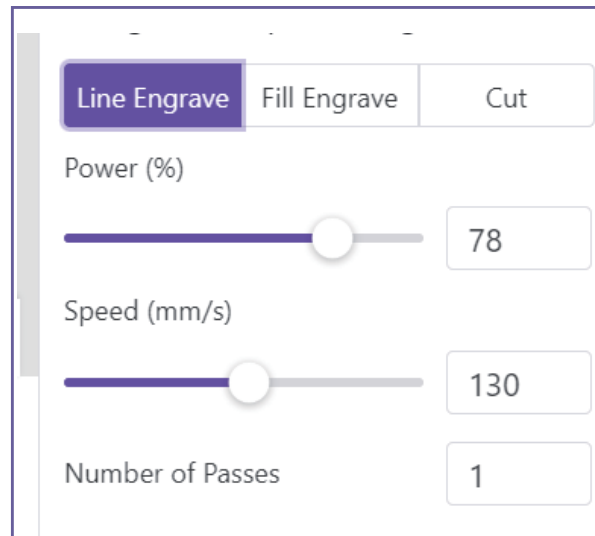

5. Then click the Auto Focus button, the machine will descend with the laser module moving to the desired location, then return to the top left corner.

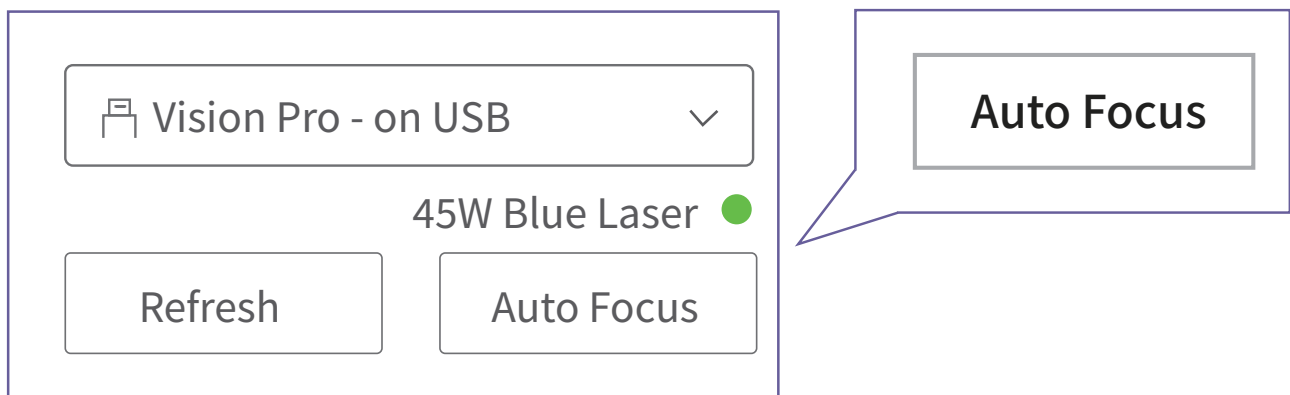

First Project

6. Click the Start button, check the preview and estimated processing time in the pop-up window and click Send. Then, when you are ready to begin engraving or cutting, press the physical button on the machine to start the job.

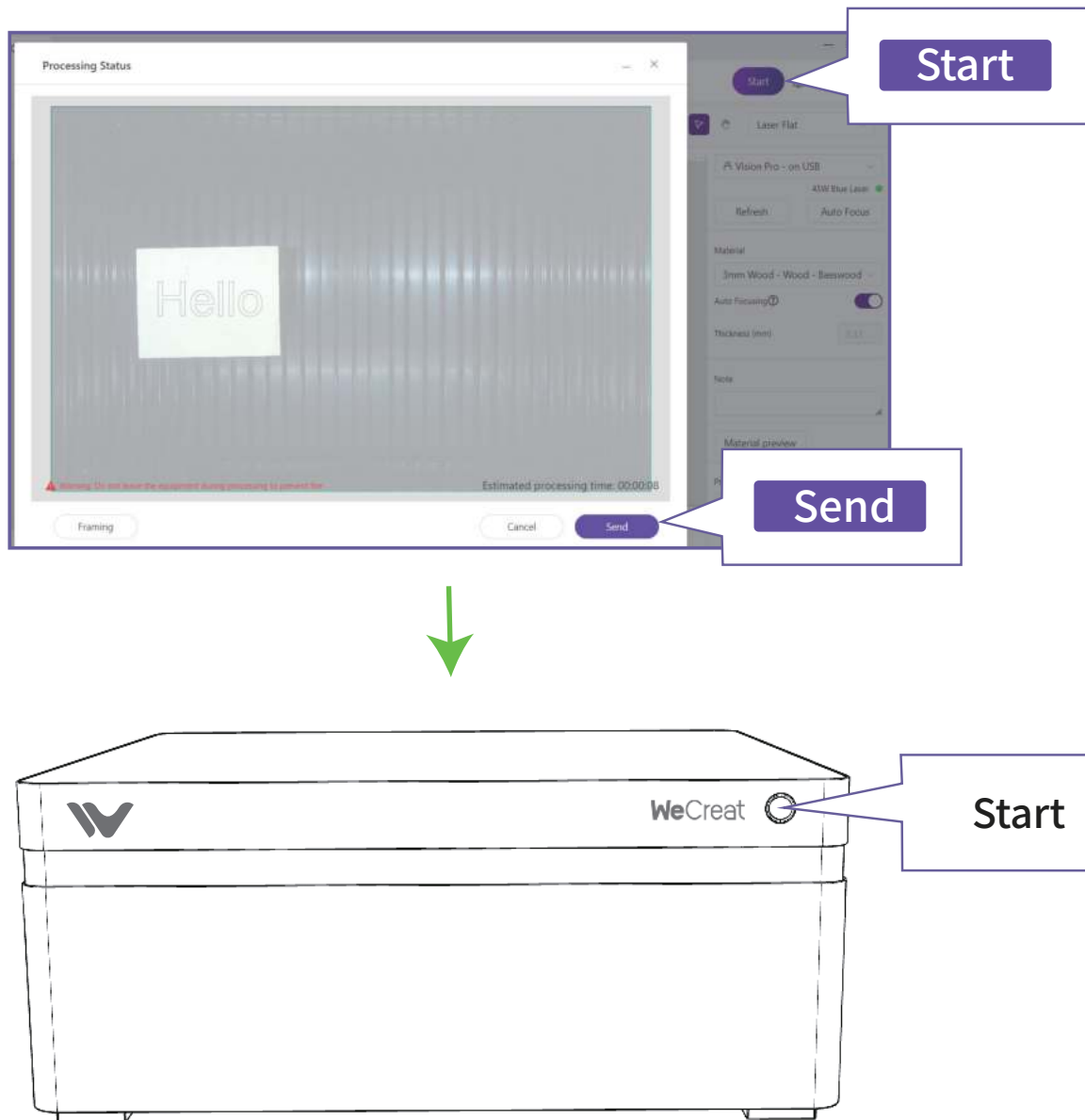

7. Wait until the task is finished, then open the top lid to meet your first project.

If you'd like to learn more about how to create advanced projects, please visit our online learning center at wecreat.com/learn

Using the Vision Pro with the Rotary Pro

Applicable to WeCreat Vision Pro Packs includes the Rotary Pro

For a video guide of how to install the Rotary Pro, please visit wecreat.com/learn or scan this QR code to view.

1. Before we start, please use the supplied tape measure to get the perimeter/diameter of the cylindrical object you want to engrave.

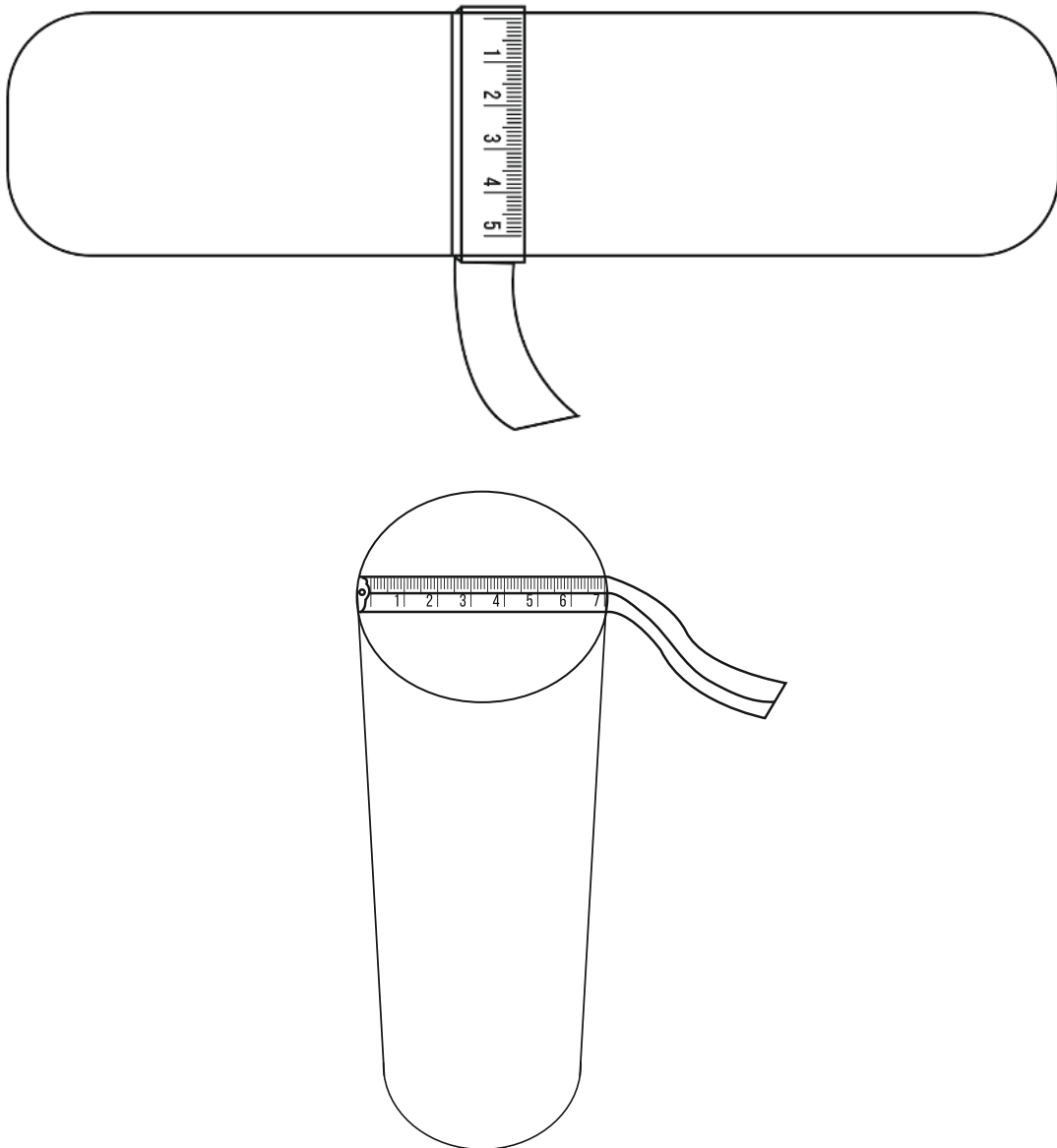

Using the Vision Pro with the Rotary pro

2. Take out the laser beds and the two screws on the frame which will be used to secure the Rotary Pro.

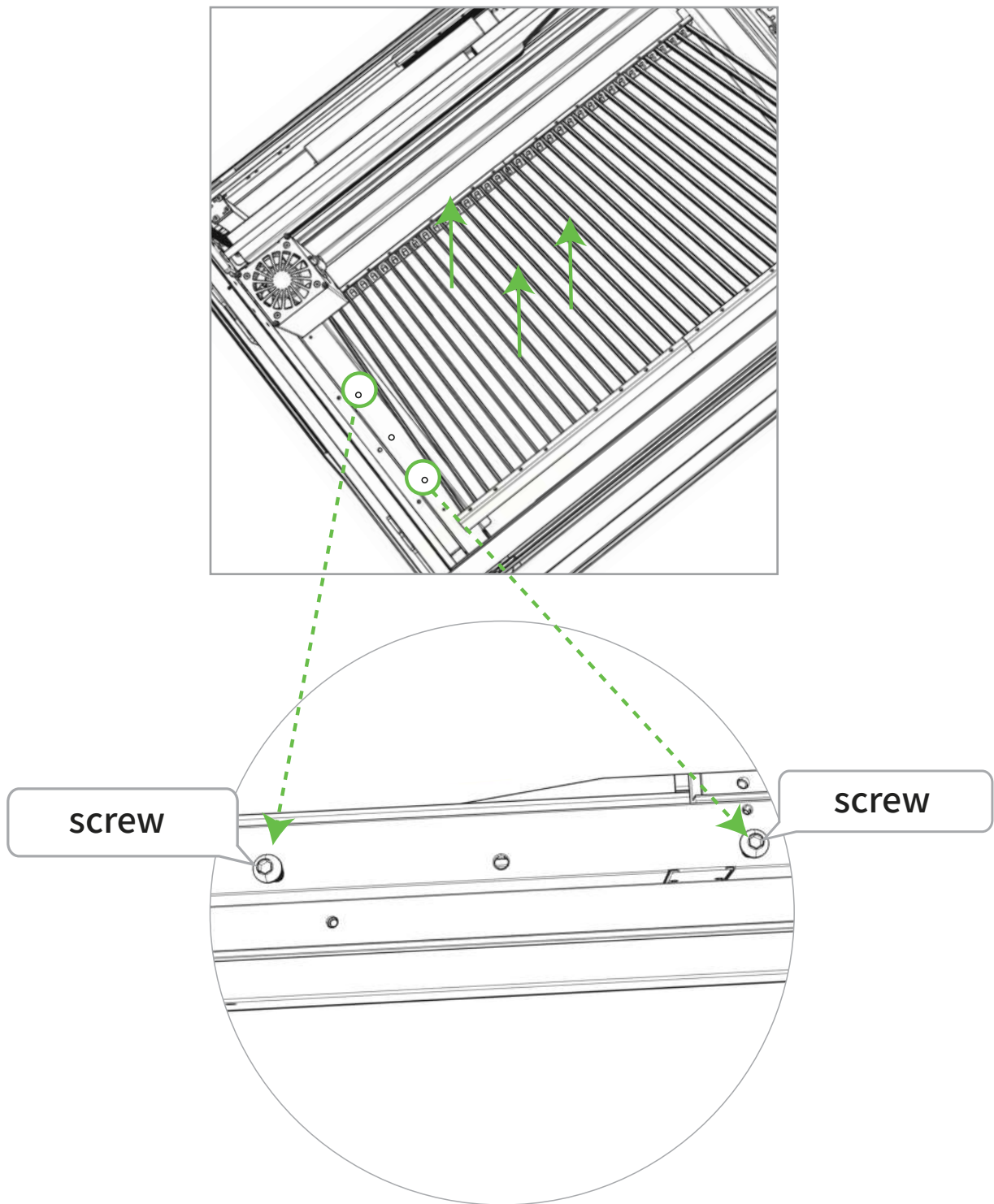

Using the Vision Pro with the Rotary pro

3. Put the Rotary Pro onto the left frame of the machine. Make sure the middle locating pin of the Rotary Set aligns with the locating hole on the left frame of the machine.

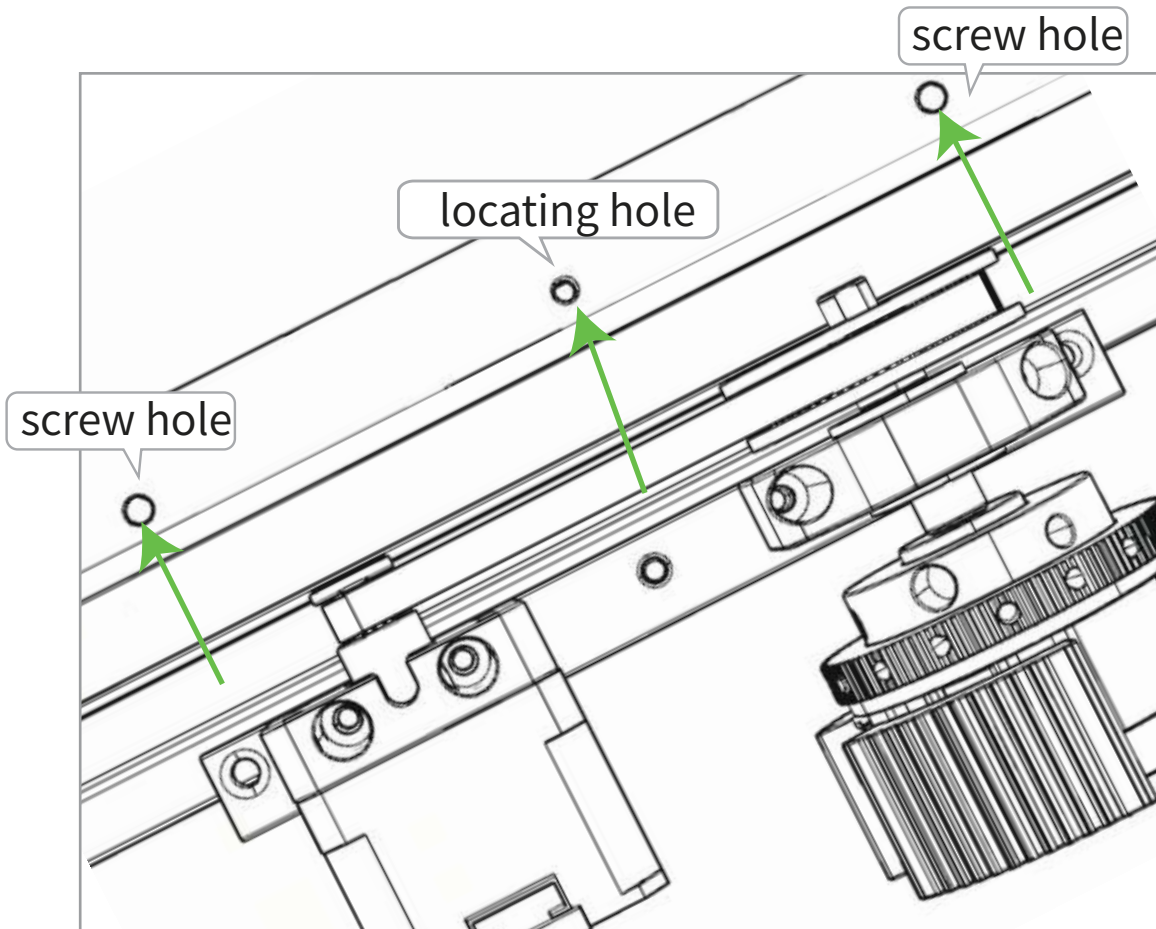

4. Then use the screwdriver and hex screws to fasten the Rotary Pro.

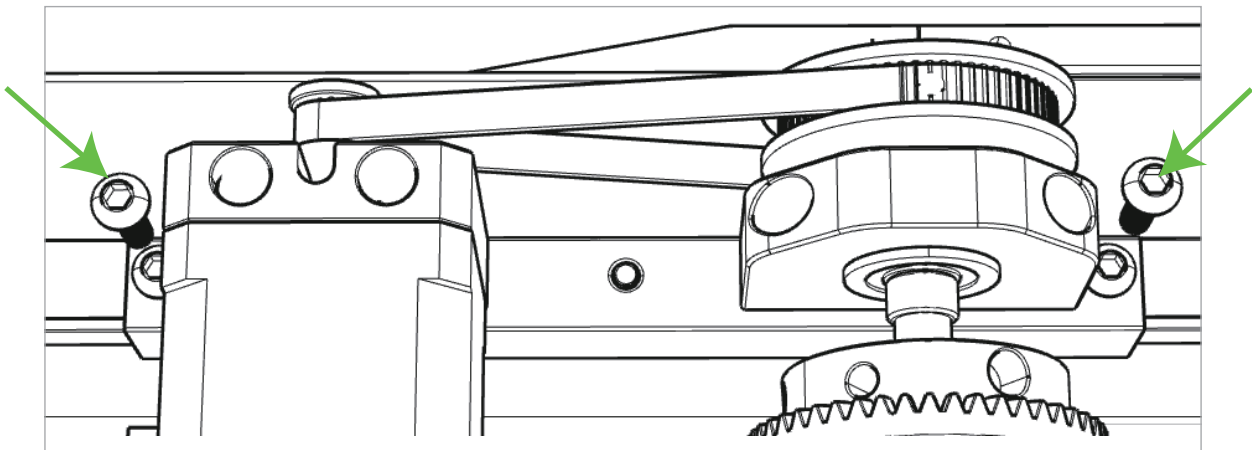

Using the Vision Pro with the Rotary pro

5. Plug the connection cable into the port on the machine's control board. Make sure to align the connector with the groove in the port.

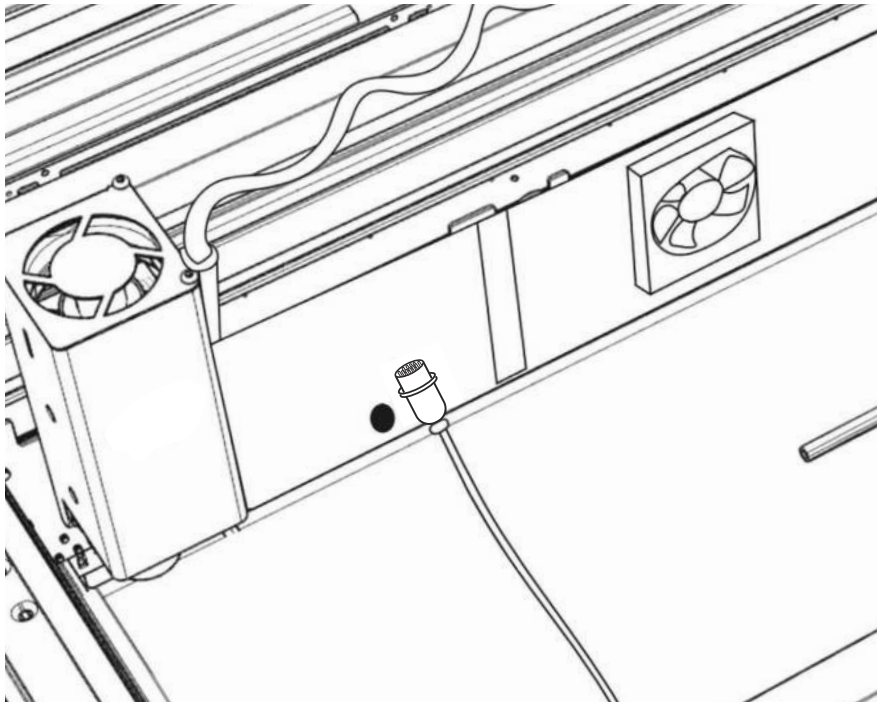

6. Place the cylinder you want to engrave onto the jaw chuck, secure it by rotating the chuck. Note: Adjust the chuck using the screwdriver again to ensure a tight Grip.

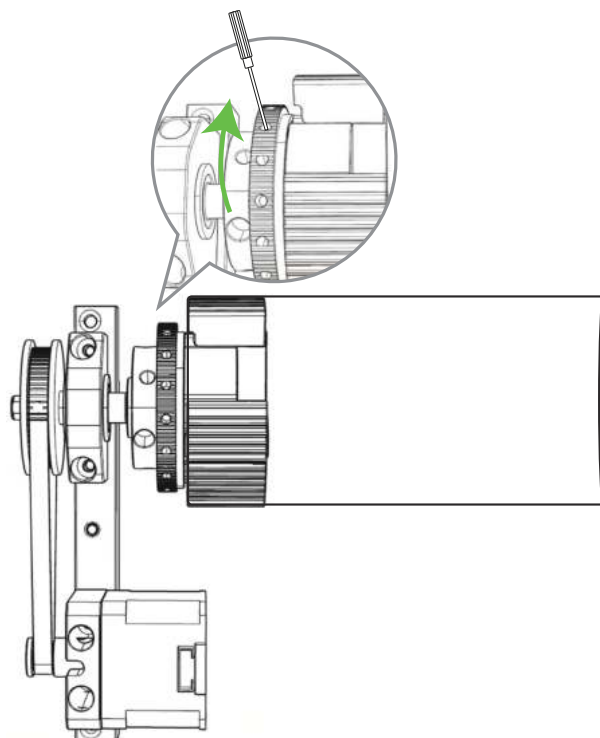

Using the Vision Pro with the Rotary Pro

7. Place the Holder part underneath the cylinder, spin the top wheel to adjust the height of the holder to ensure the cylinder is supported. You can use the supplied mini level to check if the cylinder is horizontally fixed.

Note: For standard cylindrical objects, use a mini level to check if it's parallel. For a tapered cup, ensure the bottom is fully against the claws to avoid gaps.

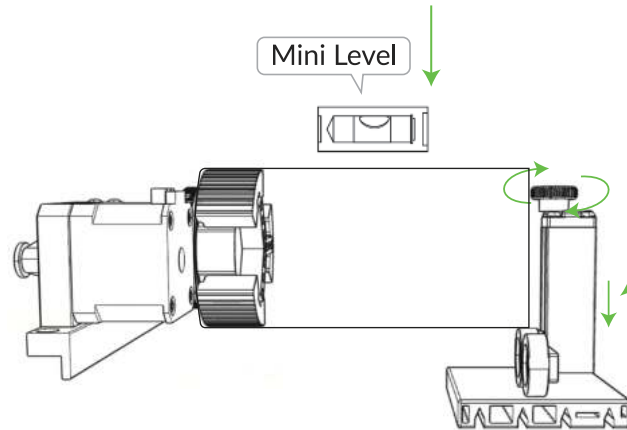

8. Turn off Non- working area of rotary in settings.

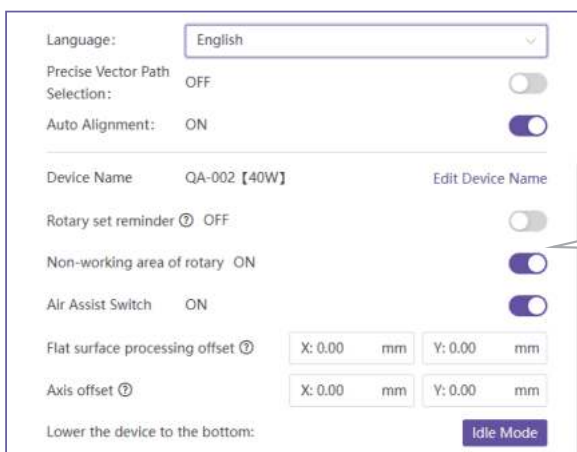

Non-working
area of rotary

9. Open the WeCreat Makelt! software, select Laser Cylindrical mode on the top right corner, it will show an image of the cylindrical object. Put in the Perimeter/Diameter you got in the beginning.

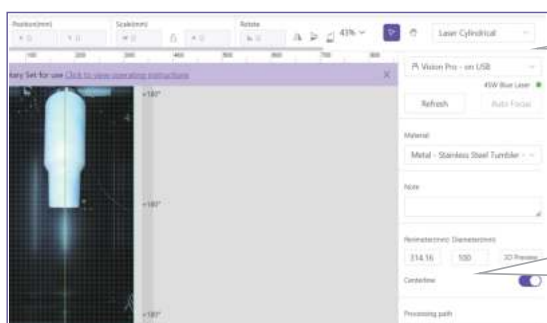

Laser Cylindrical

314.16

100

Using the Vision Pro with the Rotary Pro

10. Put your design (text/vector/image) on the desired position of the cylindrical object, choose the working mode (Engrave/Fill Engrave) and power/speed parameters, then click Start to get the preview.

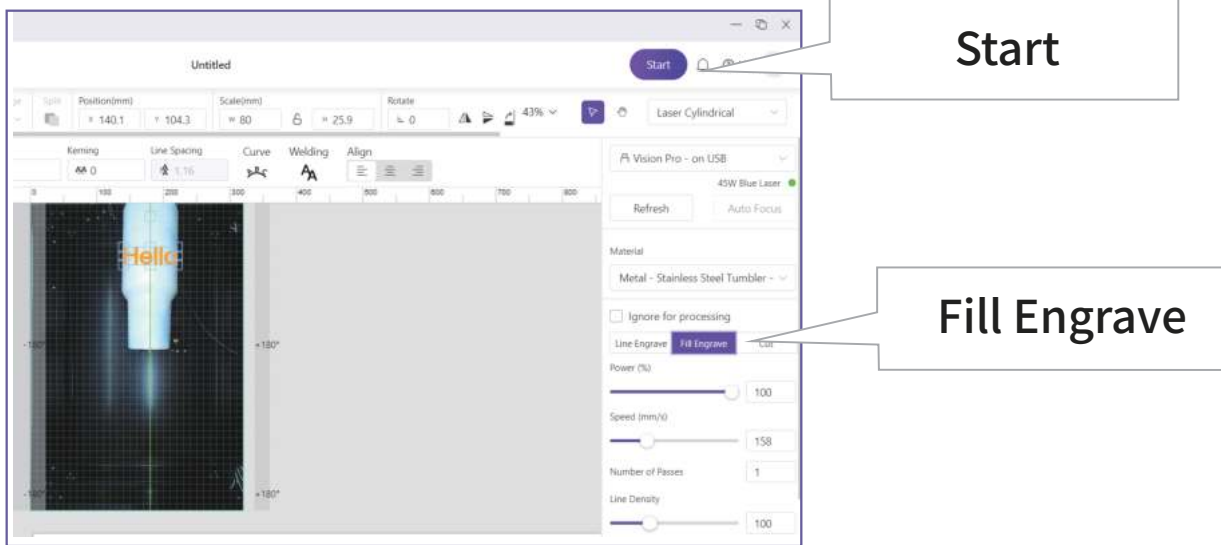

11. Click Send and press the Start/Pause button on the machine. Wait until the task is finished, the top lid will rise up and you can now open it to meet your first cylindrical project.

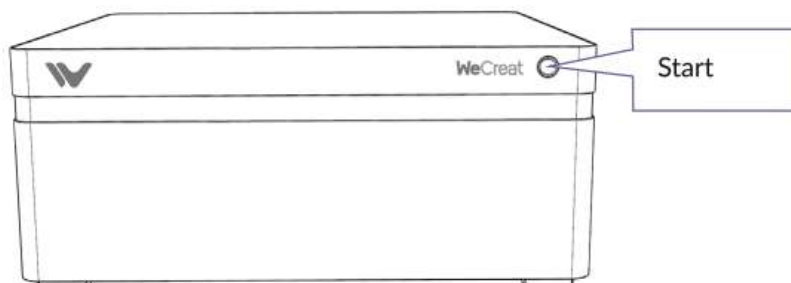
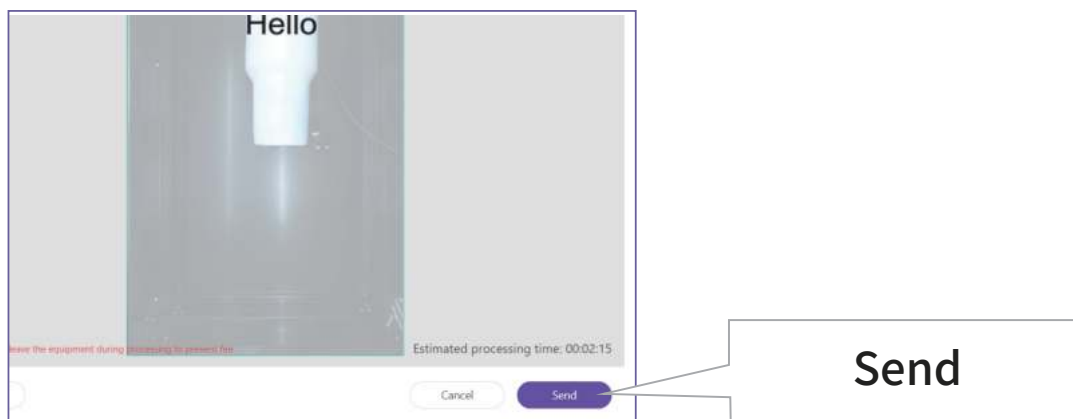

Using the Vision Pro with the Rotary Pro

Tips about the jaw chuck:

1. In its default status, it can be used for cylinders with diameters between 1 - 100 mm (0.039 - 3.93 inches).

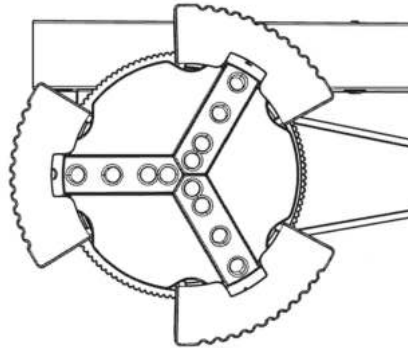

2. Please ensure that the Rotary connection cable passes through the groove on the rack below the chuck jaws. If it is placed directly above or below the cylinder to be engraved, the cable may be damaged by the laser.

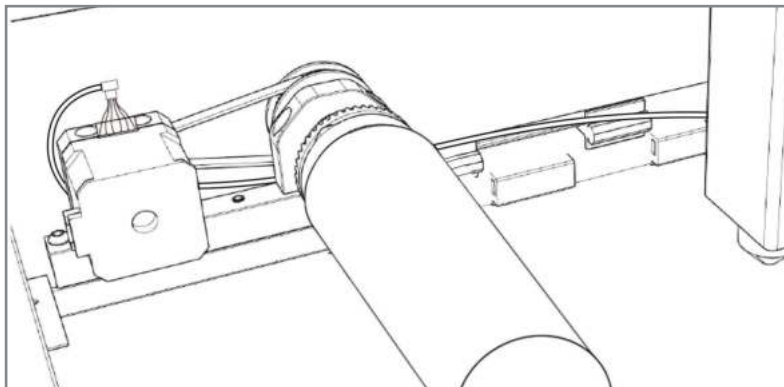

3. If you would like to engrave on small objects such as rings, please install the three threaded studs on the jaw chuck.

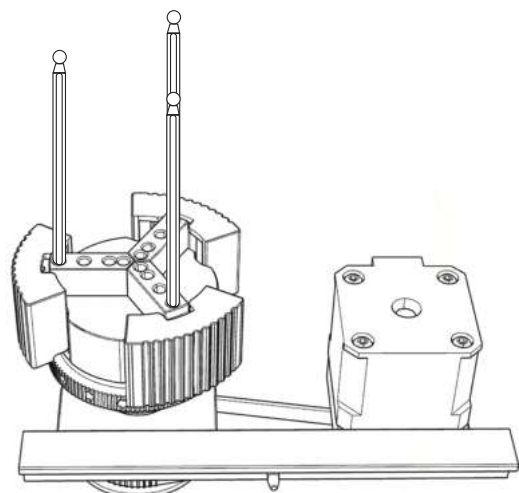
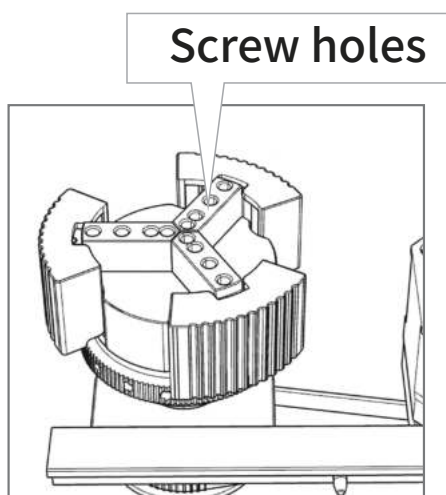

Appendix

Appendix 1. Ensure the Z-axes are on the same plane

Sometimes if the machine is heavily bumped or pressed during transportation, it will result in the top of the four Z-axes not being on the same plane, and cause abnormal noise issue during rising/lowering or the machine is even unable to move up/down. In this case, we recommend you to adjust the Z-axes manually.

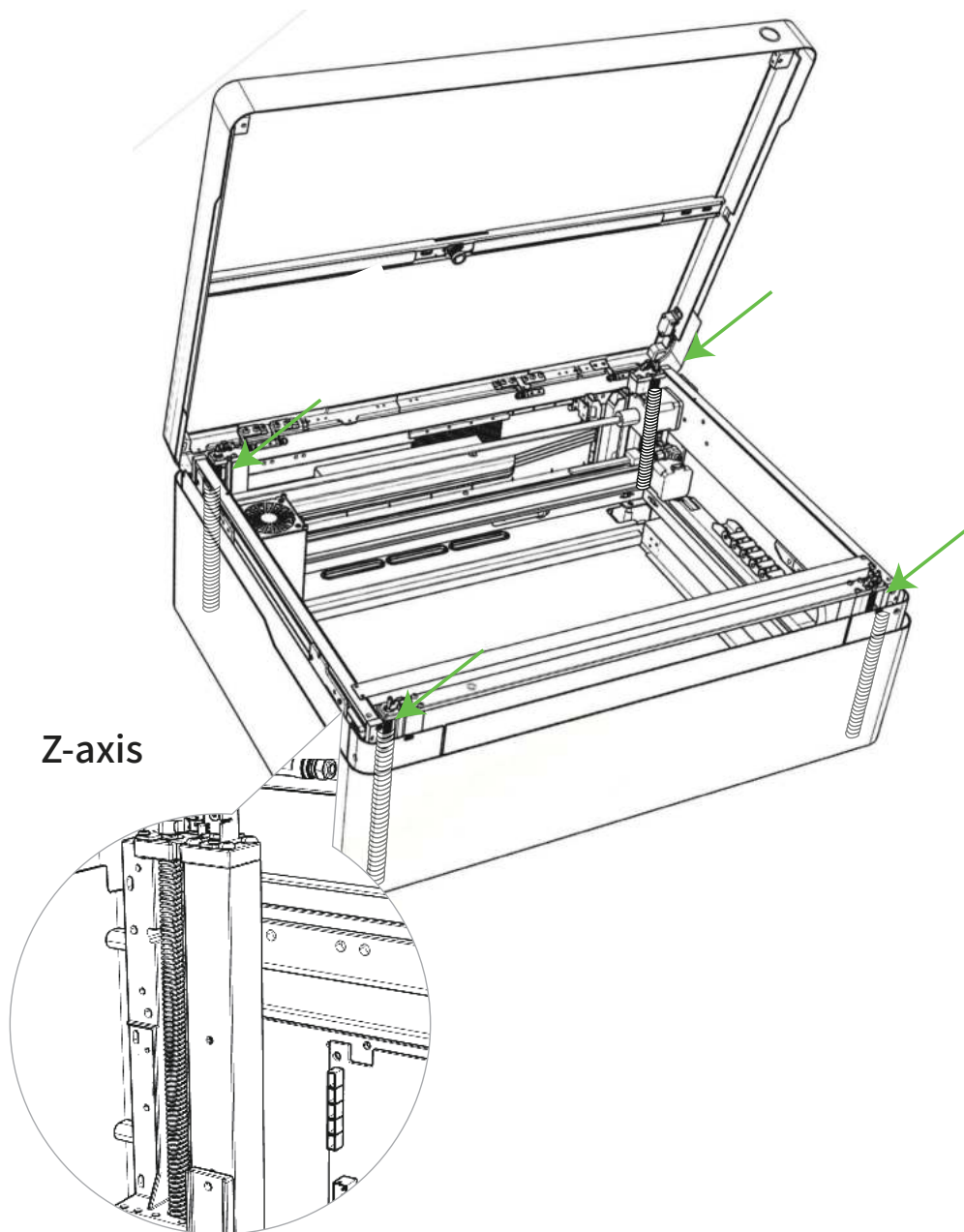

Appendix

1. Power OFF the machine first!

2. Use a straight screwdriver to adjust the screws on the four corners. Try the four screws one by one to see if all four screws can be easily turned, which means the Z-axes are in place.

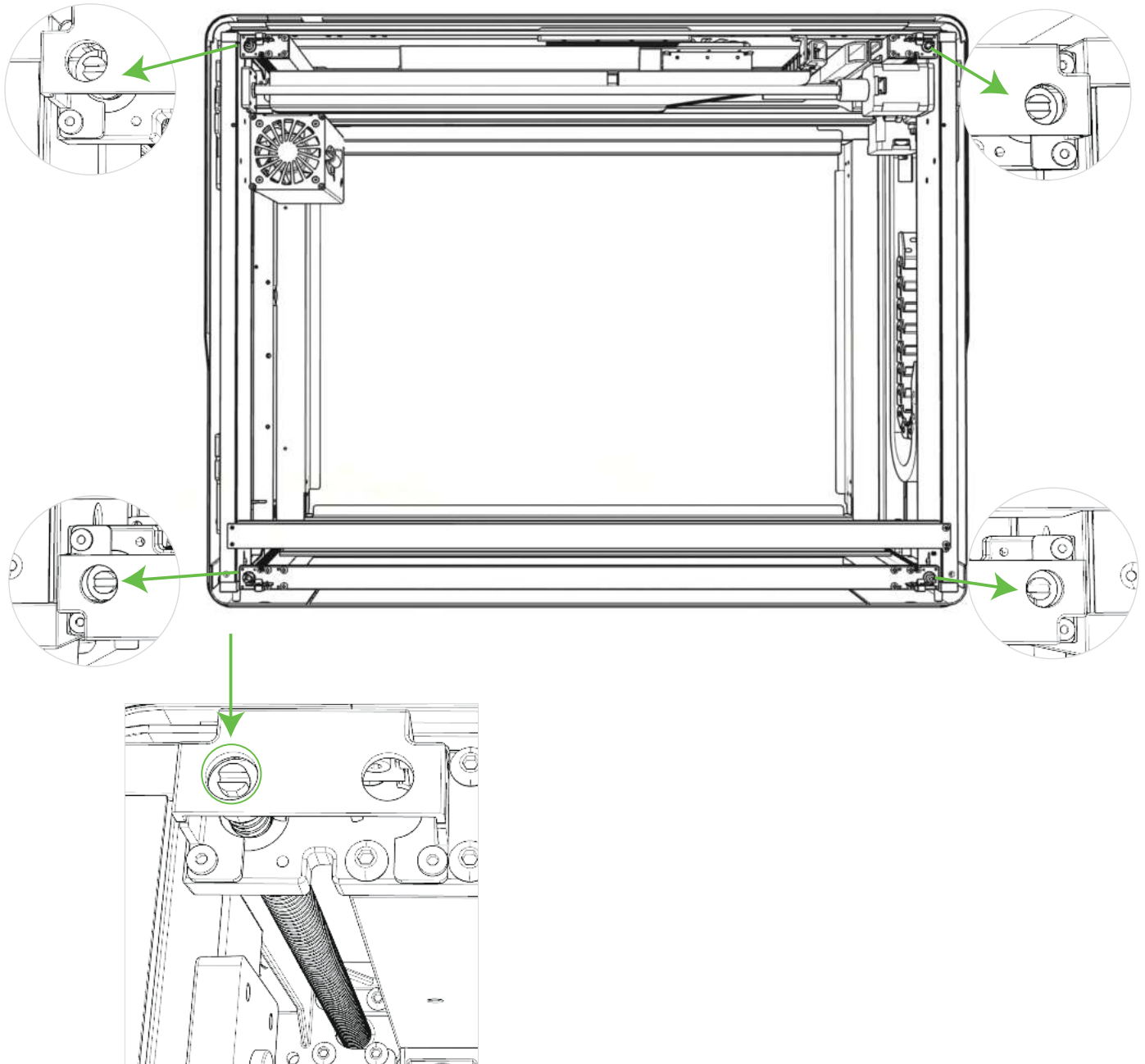

Appendix

3. If one of the screws is difficult to turn, it indicates that the corresponding Z axis may be stuck. You may also use the supplied mini level to measure and see which corner is higher/lower. Please place the level on the four corners and frames as shown below.

Note: Make sure the desk is level first. Otherwise, please don't use the level to measure the laser.

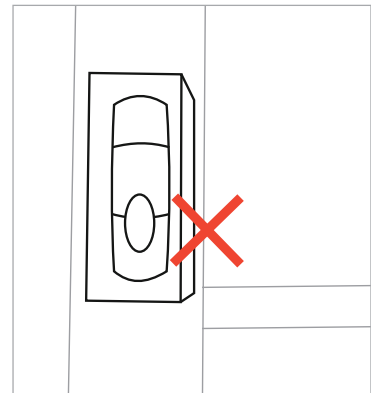
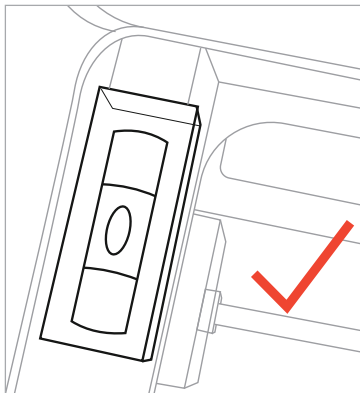
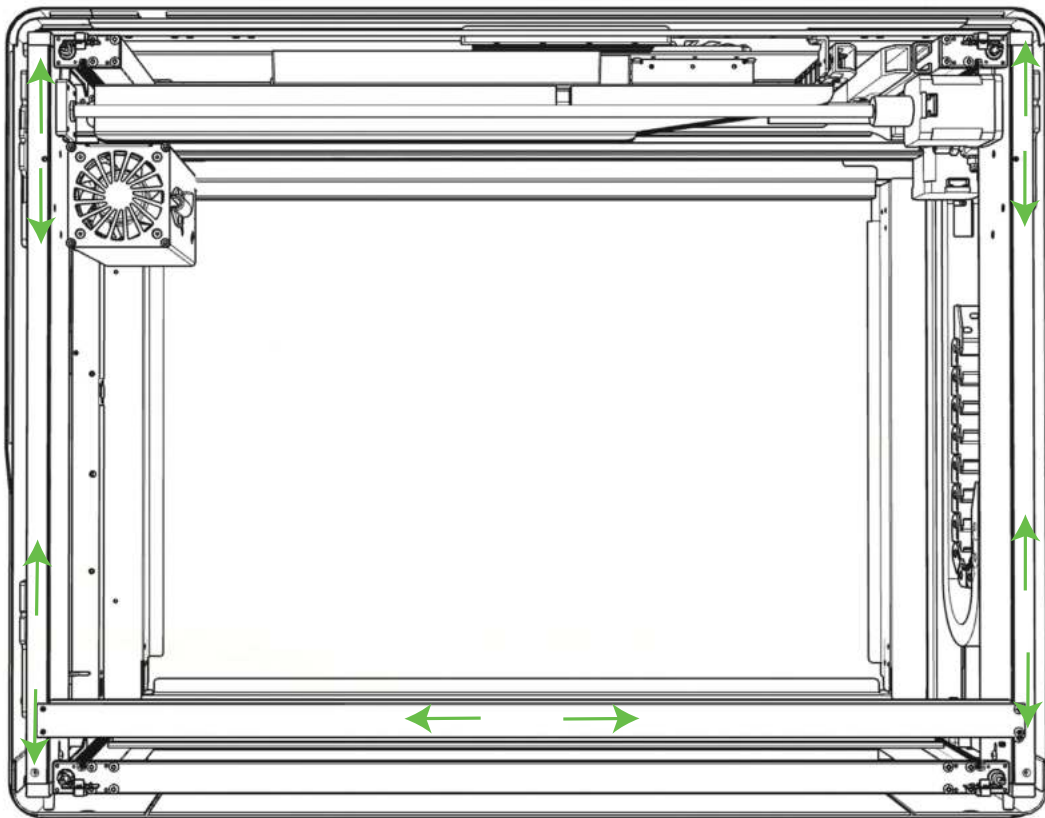

Appendix

4. After confirming which Z-axis is stuck, rotate the screws of the other three Z-axes to raise/lower them to the same height as the stuck Z-axis. At this point, try to turn the screw of the previously stuck Z-axis, and it should be easy to turn it.

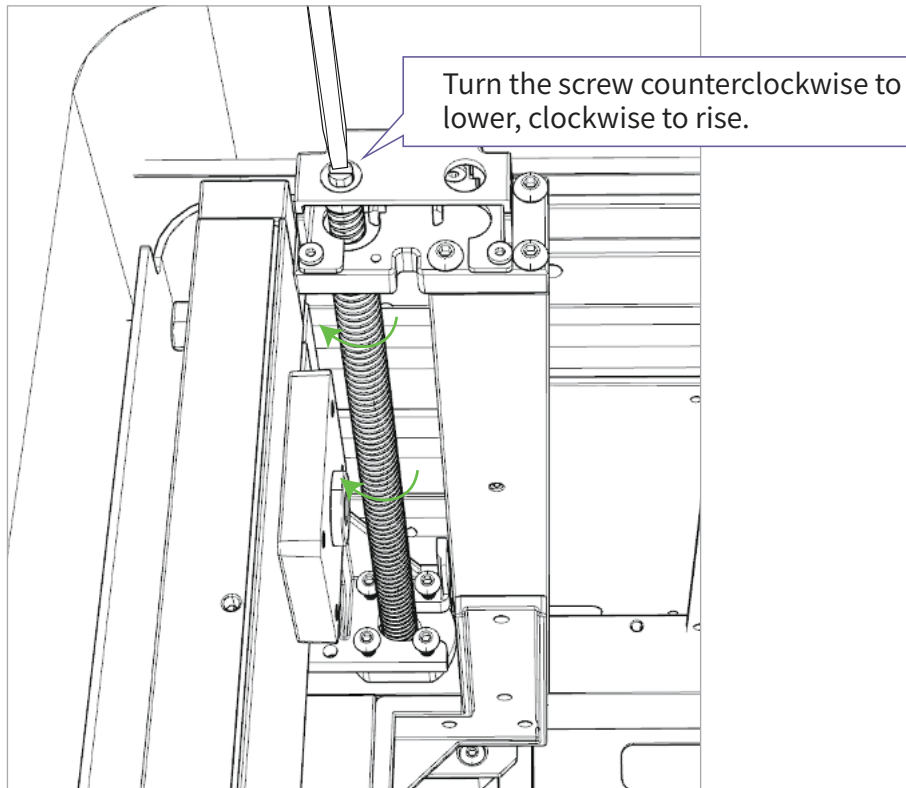

5. Ensure the four screws are all easy to turn, now you can power on the machine, and check if it moves up/down freely when powering on, doing auto-focus or switching to Idle/Transportation mode.

Please scan the QR code to view all the cleaning and maintenance steps below.



Appendix

After-Sales Services

On a mission to make laser engraving easier to everyone, WeCreat group is here to help.

For after-sales services, WeCreat can be reached via

Telephone: +1 425-939-3933 Mon- Fri, 9 am - 6 pm EST

Email: support@wecreat.com

Website: www.wecreat.com

Warranty

Within the initial one-year warranty period, we offer comprehensive technical support for any issues you may encounter.

Please click on the link below for more details. This limited manufacture' s warranty does not affect any statutory warranty provided by law.

<https://wecreat.com/pages/warranty-policy>