

# Customer Support

---

Please visit the WeCreat Support Center for more setup, maintenance and application tutorials and questions.<https://support.wecreat.com>

If you need more support, please try one of the following three options. We will get in touch with you as soon as possible.

1. Submit a support ticket at <https://support.wecreat.com>.
2. Directly send us an email: [support@wecreat.com](mailto:support@wecreat.com)
3. Drop us a call: +1 (425) 939-3933 Mon - Fri: 9:00 am - 6:00 pm EST

## Join Our Community



Download WeCreat Makeit!

Video Quick Start Guide

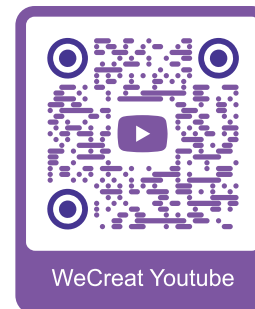
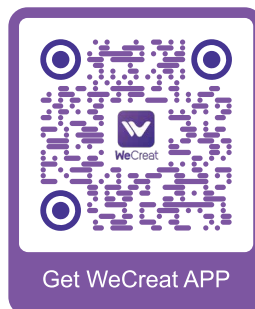

Let's Create with WeCreat!  
[www.wecreat.com](http://www.wecreat.com)



# WeCreat Vista User Manual

## Laser Engraving & Cutting Machine



### USER MANUAL

Please review the entire guide before operating the device.

\*Safety Notice: Do not connect to power until setup is complete.

[www.wecreat.com](http://www.wecreat.com)



# WeCreat

- Declaration.....1
- Safety.....2
- Meet Your WeCreat Vista.....7
- What’s In the Box..... 9
- Product Setup ..... 14
- Software and Network..... 20
- First Project .....25
- Use WeCreat Vista with the Rotary Set .....28
- Hazardous Substances .....34
- Maintenance .....35
- After-Sales Services .....35
- Warranty .....35

# Declaration

---

The User's Manual (hereinafter referred to as the "Manual") is intended to provide detailed instructions for installing and operating the WeCreat Vista. Through this manual, users will understand how to operate the laser safely and effectively to ensure optimal use.

Users must install and use according to the guidance of this Manual. The company does not assume responsibility for any damage or malfunction caused by not following the Manual's guidelines. The company is not responsible for any loss caused by unauthorized repair, modification, or improper use.

The compilation of this Manual aims to provide users with clear and accurate installation and usage guidance to promote the correct use of the pass through feeder, ensuring user safety and effective operation of the device.

The company is committed to continuously optimizing products and improving services. For any questions about the content of this Manual or any issues encountered during the use of the laser, please feel free to contact us for feedback: [support@wecreat.com](mailto:support@wecreat.com)

The copyright of this Manual belongs to the company. This Manual and the information, diagrams, and logos contained herein are protected by copyright law. Without the company's explicit written authorization, no unit or individual may copy, reprint, excerpt, or utilize this Manual in any other form.

The company reserves the right to update this declaration and the content of the Manual at any time without further notice. If there are changes, please refer to the latest information published by the company.

# Safety

---



**Warning: Do not leave the device unattended when in operation.**



Turn OFF device before plugging/unplugging.



If the machine operates with setting errors and is left unattended for an extended period of time, or if a mechanical or electrical fault occurs, it may lead to a fire.



Keep explosive and flammable materials away from the device.  
Do not stack materials (such as paper) around the machine.  
They may cause the spread of flames and increase the risk of material ignition.



**Please do not lean on the machine top cover or place heavy objects on it.**

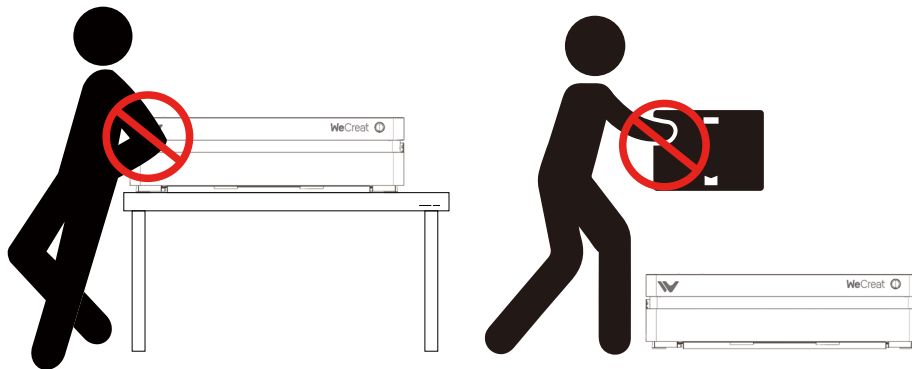

# Safety

---

## Please follow the operating principles:

1. Prior to each use, inspect the machine for any damage. Do not operate the machine if any damage or defects are detected.
2. Ensure that the workspace is clean and level.
3. Unauthorized disassembly or alteration of the machine's structure is strictly prohibited. Do not modify or decompile its operating system.
4. Maintain cleanliness inside the machine. Residues and debris accumulated during cutting and engraving can be hazardous and may cause a fire. Regularly remove chippings and residues.
5. Do not operate the machine when the lid is open. Always ensure the lid is closed before operating the machine.

WeCreat Vista is certified as a Class 1 laser product containing an embedded Class 4 laser module. The following label information applies to the WeCreat Vista product and its laser module.

## WeCreat Vista

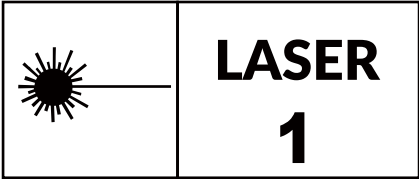
|   |  |
|---|--|
| <h3>WeCreat Vista</h3>  |  |
| <p>Model Number: LE2410<br/>Company Name: WeCreat Tech Limited<br/>Supply Voltage: 100V-240V<br/>DC24V 4.5A 108W<br/>Contains FCC ID:2BH5I-6223A-SRD<br/>Contains IC:32869-6223ASRD<br/>HVIN: 6223A-SRD<br/>Operating Temperature: 0°C~ 40°C (32°F ~ 104°F)<br/>Storage temperature:0°C~ 45°C(32°F ~ 113°F)<br/>Made in China</p> <hr/> <p>Company Address: Room 501, Block 18 RuiYuan,<br/>TaoYuan District, Nanshan, Shenzhen</p> | <p>This device complies with Part 15 of the FCC Rules.<br/>Operation is subject to the following two conditions:<br/>(1) This device may not cause harmful interference, and<br/>(2) This device must accept any interference received, including interference that may cause undesired operation.</p> |
|    |    |

# Safety

---

## WeCreat Vista's Laser module

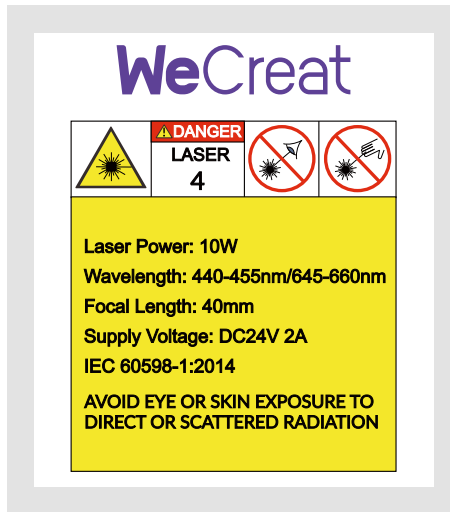

**Caution!** Use of controls or adjustments or performance of procedures other than those specified herein may result in hazardous radiation exposure.

## FCC Statement

This device complies with Part 15 of the FCC Rules. Operation is subject to the following two conditions:

1. This device may not cause harmful interference, and
2. This device must accept any interference received, including interference that may cause undesired operation.

**Warning:** Changes or modifications not expressly approved by the party responsible for compliance could void the user's authority to operate the equipment.

**Note:** This equipment has been tested and found to comply with the limits for a Class B digital device, pursuant to Part 15 of the FCC Rules. These limits are designed to provide reasonable protection against harmful interference in a residential installation.



# Safety

---

This equipment generates, uses, and can radiate radio frequency energy and, if not installed and used in accordance with the instructions, may cause harmful interference to radio communications. However, there is no guarantee that interference will not occur in a particular installation.

## RF exposure statement

RF exposure information: The Maximum Permissible Exposure (MPE) level has been calculated based on a distance of  $d=20$  cm between the device and the human body. To maintain compliance with RF exposure requirements, use product that maintain a 20cm distance between the device and the human body.

This device may be used in each member state.

## Wireless Specifications

### Bluetooth

Wireless Technology: BLE 5.0  
Operating Frequency: 2402-2480MHz  
Transmit Output Power:  $\leq 5$ dBm

### 2.4GHz Wi-Fi

Wireless Connectivity: IEEE 802.11b/g/n, up to 40MHz  
Operating Frequency: 2412-2452MHz  
Transmit Output Power:  $\leq 15$ dBm

## Main Specifications

Laser radiation output: 10 W  
Wavelength: 455nm  
IEC 60825-1:2014

# Safety

---

## Vista 10W

|   |                            |
|---|----------------------------|
| <b>Dimensions</b>   | <b>Rated Laser Power</b>   |
| 643*471*166mm(25.32"*18.54"*6.54")                            | 10W                        |
| <b>Package size</b>   | <b>Max Engraving Speed</b> |
| 765*590*330mm(30.12"*23.23"*12.99")                           | 600mm/s                    |
| <b>Weight</b>   | <b>Motion Accuracy</b>     |
| Net Weight: 14.5kg (31.97lbs)<br>Gross Weight: 26kg(57.32lbs) | 0.05mm                     |
| <b>Electrical Requirements</b>                                | <b>Safety Guard</b>        |
| AC 100-240V, 50/60HZ  | Class I (FDA Certified)    |
| <b>Air Assist</b>   | <b>Laser Spot</b>          |
| 30Kpa, 30L/min  | 0.035*0.200mm              |

# Meet Your WeCreat Vista

---

For a video Quick Start Guide, please visit [wecreat.com/learn](http://wecreat.com/learn) or scan this QR code to view.

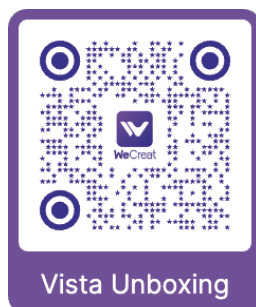

**1** Start/Pause Button  
(Status Indicator:Blue-Idle, Green-Processing, Red-Error)

**2** Detachable Tray

# Meet Your WeCreat Vista

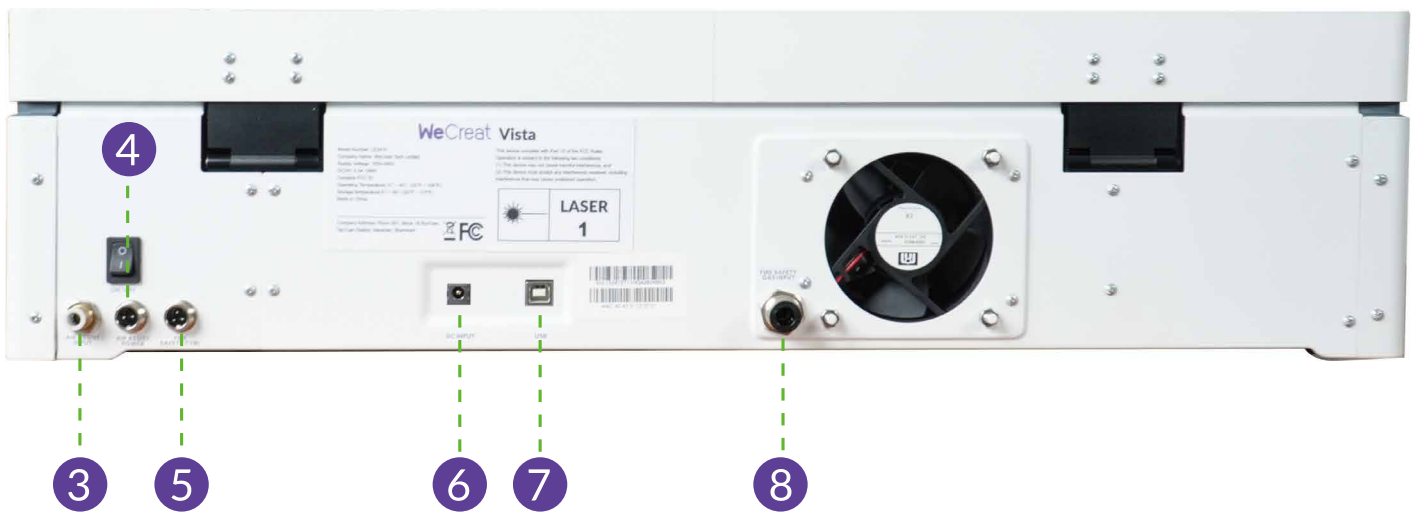

3 Air Assist Input Port

4 Air Assist Power Port

5 Fire Safety Ctrl

6 DC Input

7 USB Port

8 Fire Safety Gas Input

9 Transport Guard Pin

10 Transport Guard Screw

# What's In the Box

Unpack to take out the WeCreat Vista and check all included parts and accessories. If the product is severely damaged or any part is lost. Refrain from using it, please get in touch with WeCreat customer service at [support@wecreat.com](mailto:support@wecreat.com).

Packaging methods may vary from bundle to bundle.

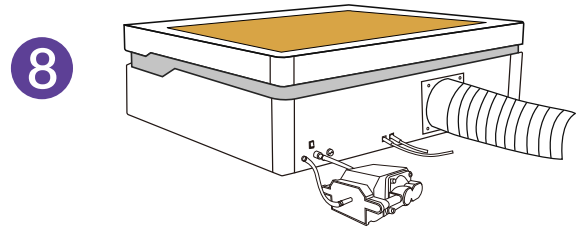
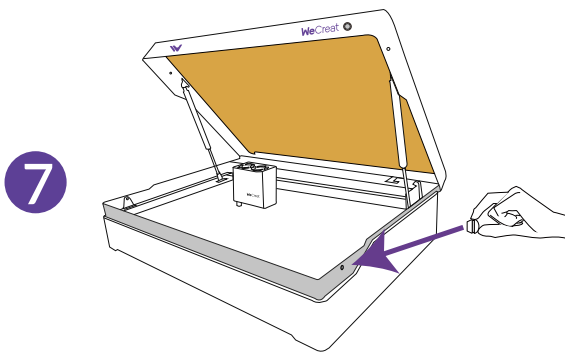
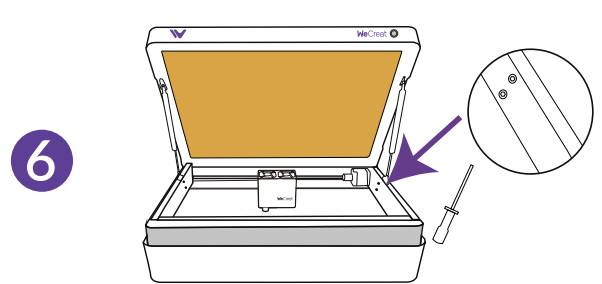
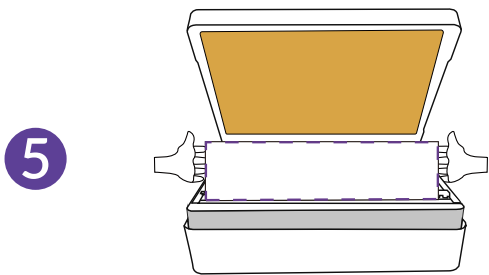
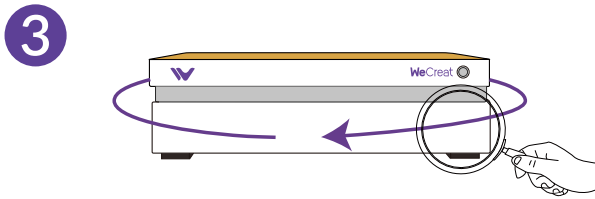
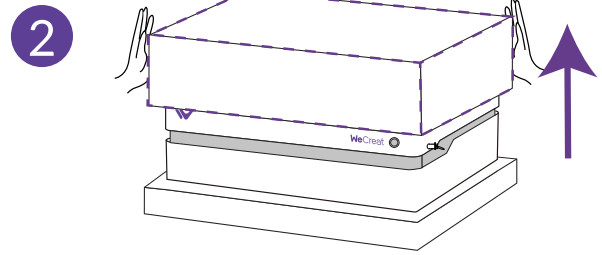
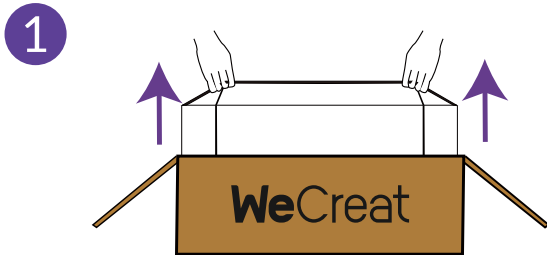

# What's In the Box

---



User Manual

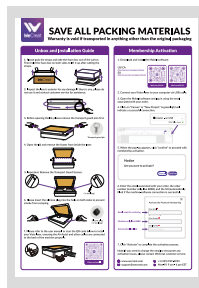

Unboxing Guide



Basswood \*2



Detachable Tray



Sample

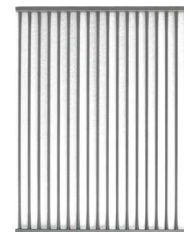

Laser Bed \*2

## Box 1: Power adapter



Power adapter

## Box 2: Rotary kit

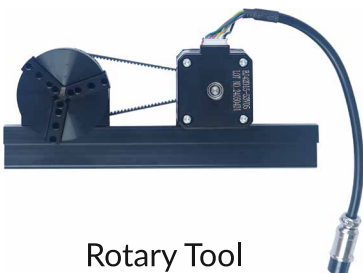

Rotary Tool

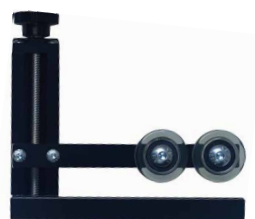

Rotary Holder



M4\*10\*6



Double-step Jaw Component\*3

# What's In the Box

---

## Box 3: Exhaust hose



Hose connector



Hose



Hose Clamp

## Box 4: Air assist kit



Air Assist



Air Pipe

## Box 5: Cables and Tools bag



Power Cable



USB Cable



Vista Riser



Reference Block

# What's In the Box

---



USB-TypeC  
Convertor



Silicone Plug\*2



Mini Level



Single-step  
Jaw Component\*3



Grease



Tape Measure



Chuck Key



M4\*15\*2



M3\*8\*6



M4\*10\*4



Long Screwdriver



Short Screwdriver



Threaded Stud\*3



Wrench



# What's In the Box

---

**Note:** for basic pack, the screws in the size of M4\*15, M4\*10, the 3 threaded studs, the mini level, the Vista riser as well as the tape measure are not included.

Vista Riser: If you want to engrave higher material, please take off the base cover of the laser and install the 4 risers. For more detailed instructions, please watch our installation video.

 **Save the packaging!** If you would like to move your WeCreat Vista, or ship it (for example, for gift or warranty purpose), check this manual or our unboxing video to learn how to pack it in the right way. Only the original boxes and foams can ensure a safe transportation.

# Product Setup

---

- 1 — Remove the transport guard pins on both sides.



- 2 — Remove the 4 transport guard screws on each side and tear off the 2 stickers.

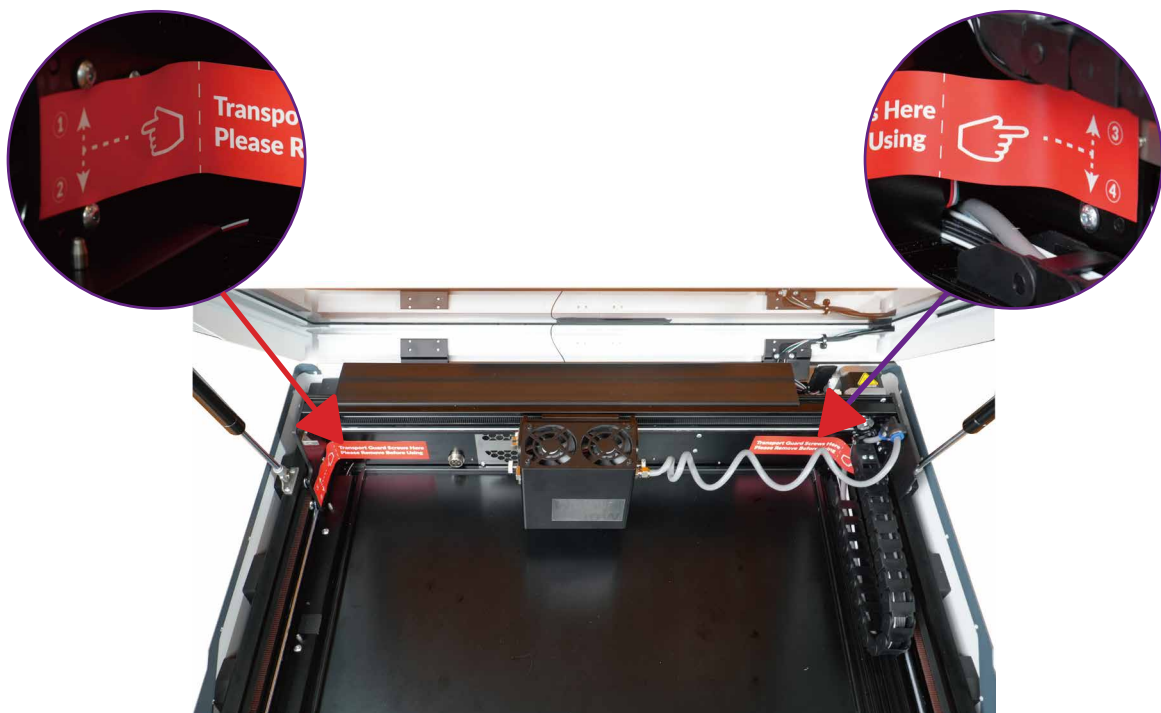

# Product Setup

---

3 — Put the bottom tray from inside of the laser, ensure both sides align with the guide rail.

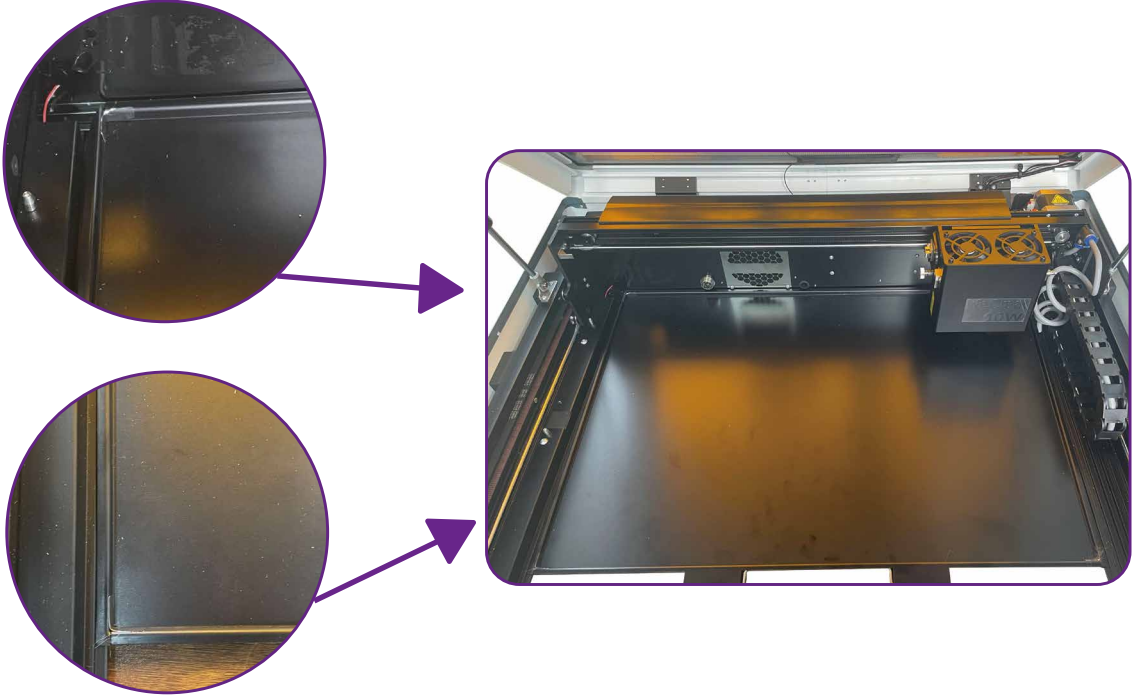

# Product Setup

---

- 4 — Install the laser beds, ensuring that the end with the oblique sections faces upwards.



- 5 — Insert the silicone plug into the hole on both sides to prevent smoke from escaping.

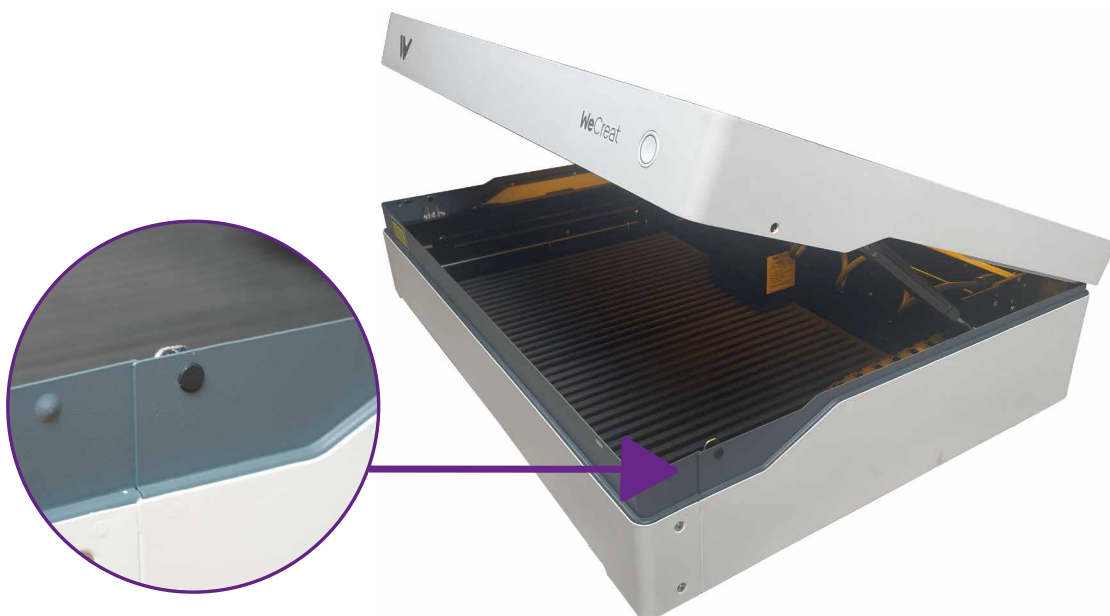

# Product Setup

---

- 6 — Connect the air assist set.  
Insert one end of the air pipe into the air assist input port. Insert the other end of it to the connection port of the air assist set.  
**Note:** If you wish to unplug the air tube, please press and hold the black annular valve to pull out the tube. Insert the power cord of the air assist and turn the nut to fix it.



- 7 — Insert the power cord into the power adapter and insert the other end into the DC input.



# Product Setup

---

- 8 — Insert the USB cable.



- 9 — Install the exhaust hose.  
Use a wrench to unscrew the 4 screws outside of the exhaust outlet. Loosen the clamp using the bottom end of the wrench.

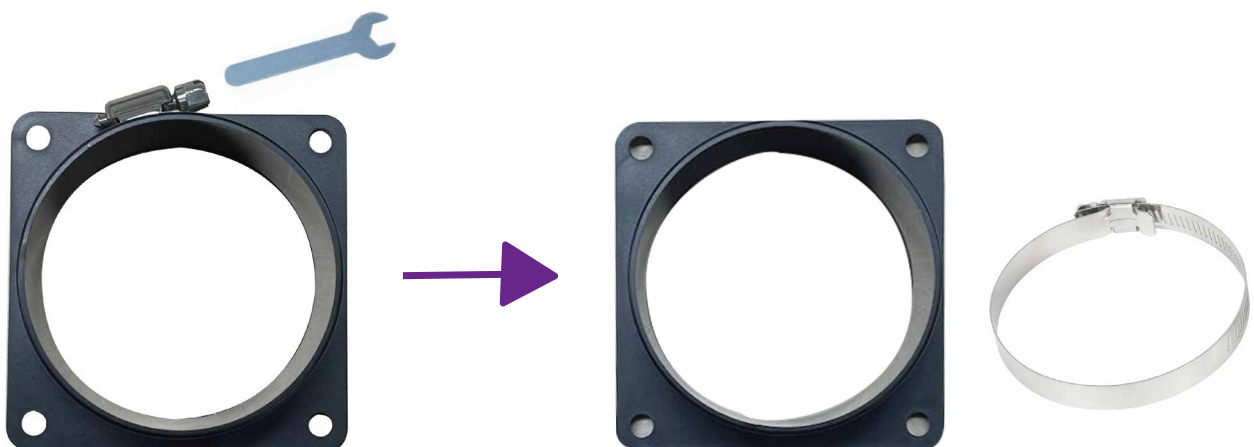
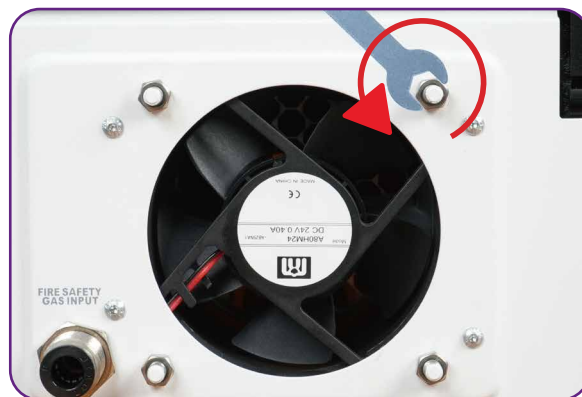

# Product Setup

---

- Install the connector onto the exhaust outlet, insert the hose, and tighten it securely.



- 10 — Plug in the power cord and turn on the machine to power up WeCreat Vista.



At this point, we have completed all the hardware installation steps. In the next chapter, we will introduce how to install and use the software.

# Software and Network

1. Visit <https://wecreat.com/pages/software> on your computer and download the WeCreat Makeit! App. Click Yes when you are asked "Do you want to allow this app to make changes to your device?" and then continue the installation as prompted.

2. Use the supplied USB cable to connect the machine to your computer. Open the WeCreat Makeit! Software and click the 'Profile' button to create or log in to your WeCreat account.

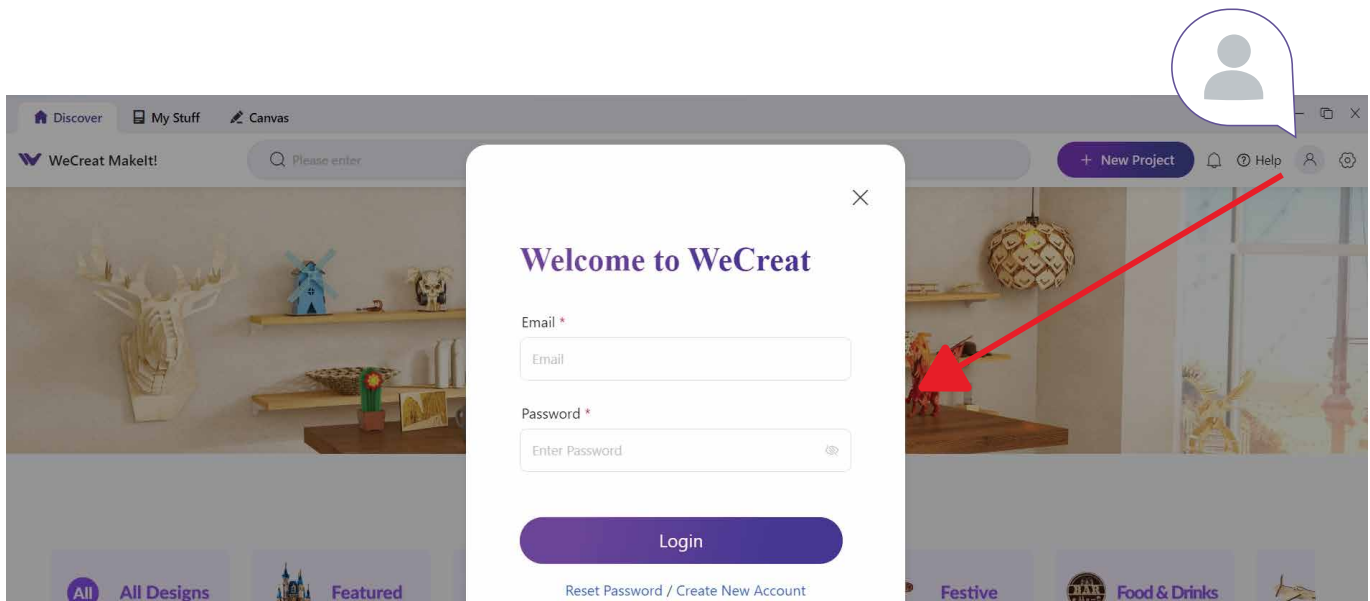

3. Once you have successfully logged in, click the New Project button.

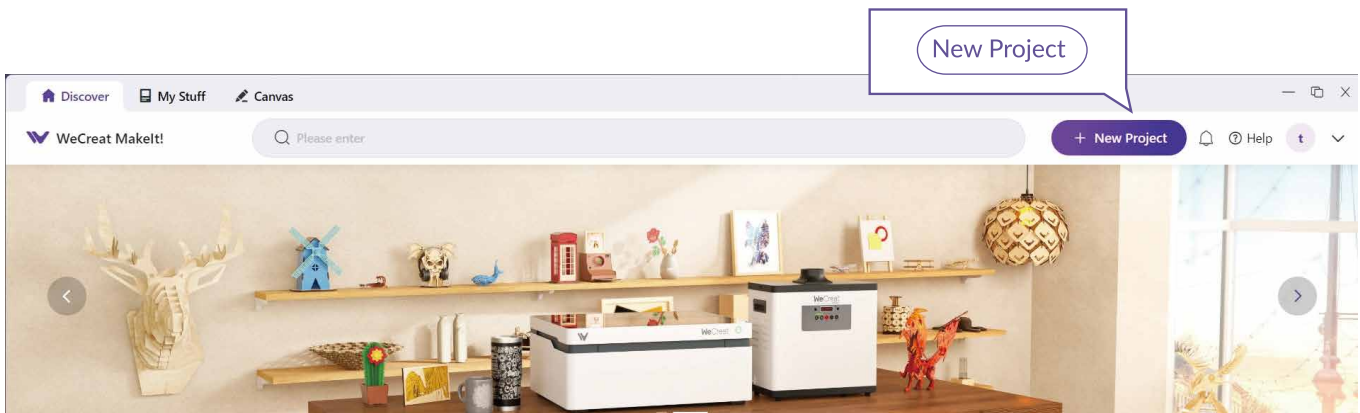



# Software and Network

---

**Note:** For Windows operating system, it may ask you to install the USB driver first, please follow the prompts to finish the installation.

4. In the device list of the right menu bar, you will see the device name with a USB icon, that means the machine is ready for USB connection, please click on it to establish the connection between the machine and your computer. Then you can start creating new projects.

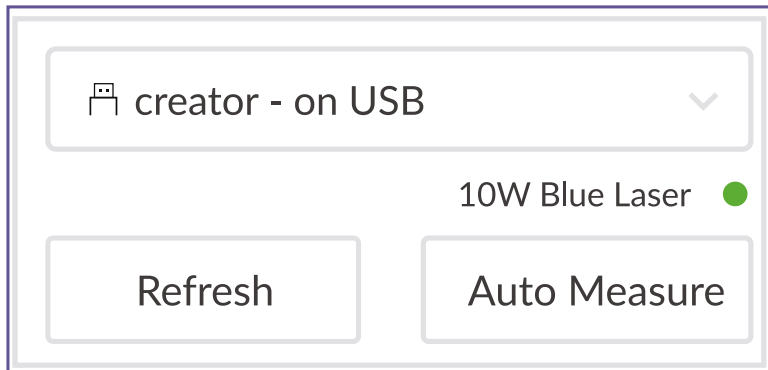

5. You may wish to connect the WeCreat Vista via Wi-Fi instead of a USB cable connection. If so, please click the Settings button on the menu bar, and go to WiFi settings. Note: Don't disconnect the USB cable until Wi-Fi setup is complete.

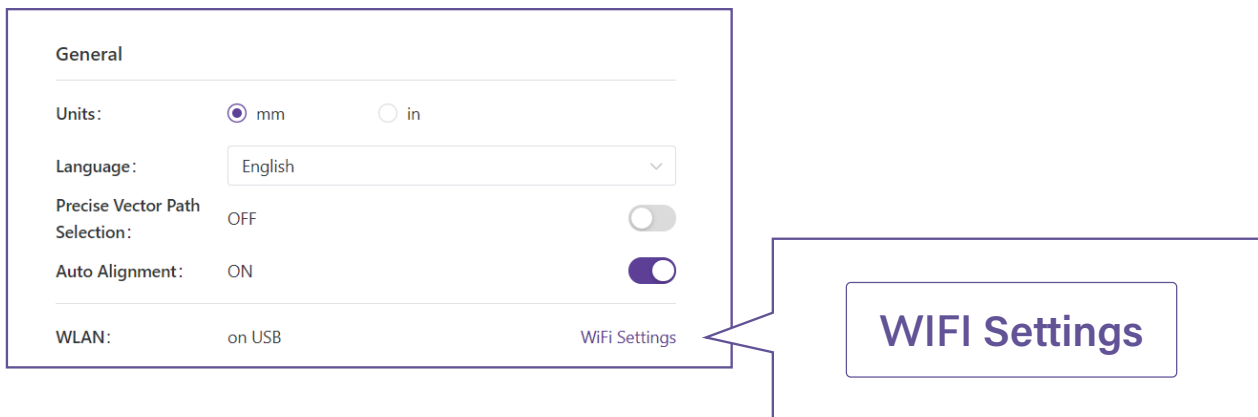

# Software and Network

---

6. Select your home network and connect to it. Input your Wi-Fi password if required.

**Note:** This product doesn't support 5GHz Wi-Fi connection. Please ensure your Wi-Fi modem/router supports and has activated the 2.4GHz connection.

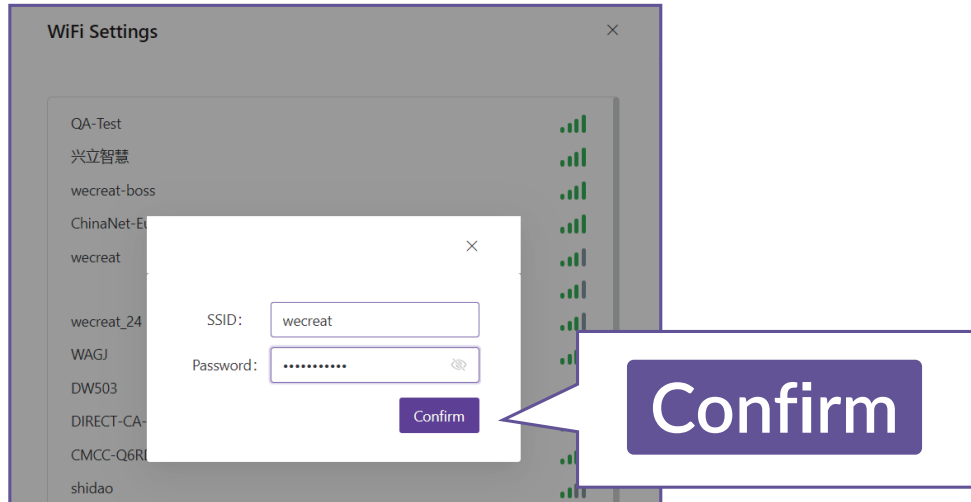

7. When you see the message “Wi-Fi connected successfully”, close the settings window. Then you will see the machine is shown in the device list with a green dot on the right side, which means you are now connected to Vista wirelessly, eliminating the need for a USB connection.

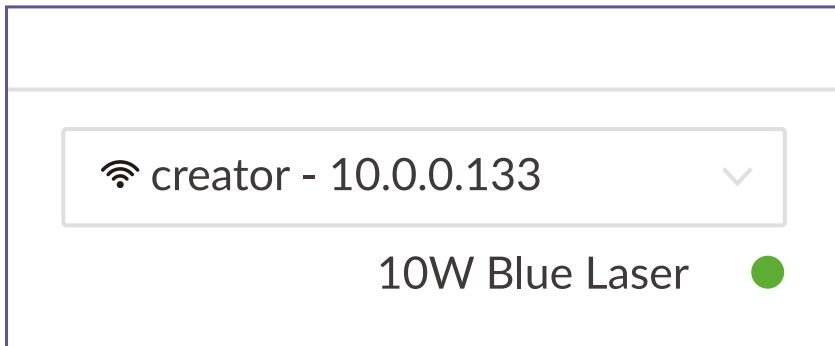

**Note:** Sometimes due to the compatibility issue with specific Wi-Fi modem/routers, issues may arise with showing the machine's name in the device list, in that case you can manually add the device as follows:

# Software and Network

- ① Keep the USB cable connected between your computer and WeCreat Vision.
- ② Open the Settings window, find the WLAN IP address, and write it down.

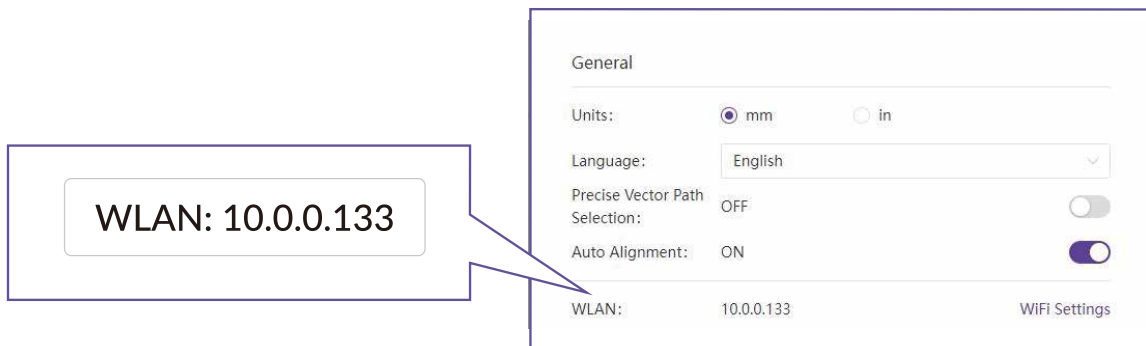

- ③ Navigate to the right side menu bar, click on the device list and click Add+. In the pop-up window, click on IP address tab, put in the IP address which you have just written down, then click Connect.

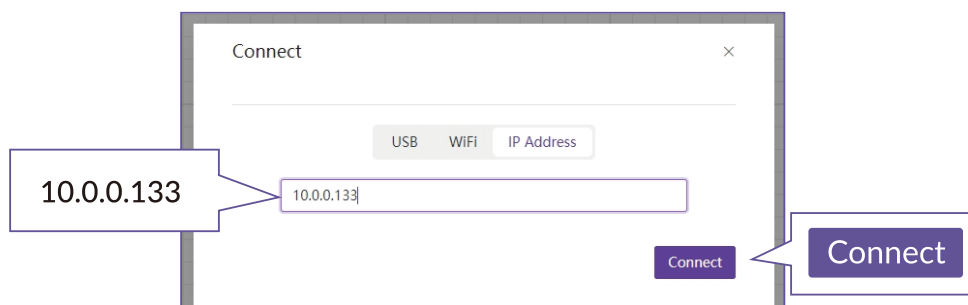
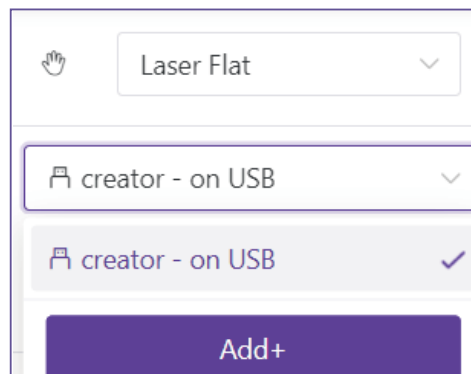

# Software and Network

---

- ④ Now please check if the wireless connection is established.

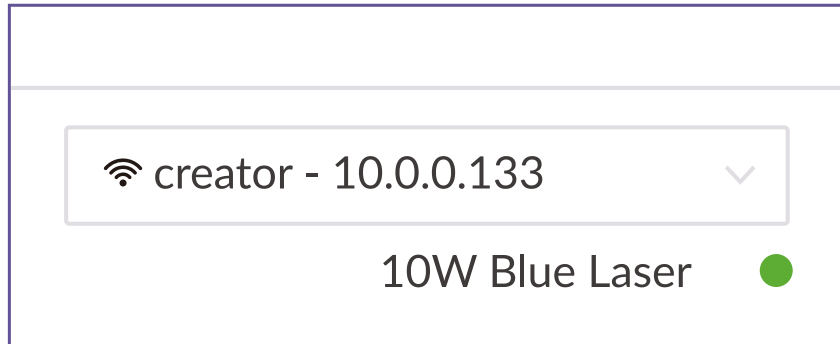

If you still encounter issues with establishing the Wi-Fi connection, please feel free to contact us at [support@wecreat.com](mailto:support@wecreat.com), our helpful and friendly support engineers are just one click away!

# First Project

---

1. Open the software WeCreat Makelt! on your computer, and click on New Project.



2. Open the machine's lid and place the supplied 3mm Basswood on the laser beds.  
**Note:** there's reference block that comes with the package, please put it on the lower left corner so the whole A3 board will be shown on the canvas.

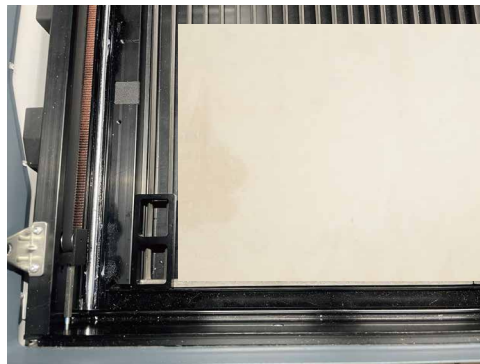

3. Keep the lid open, and click the Refresh button on the right-side menu to display the actual background.

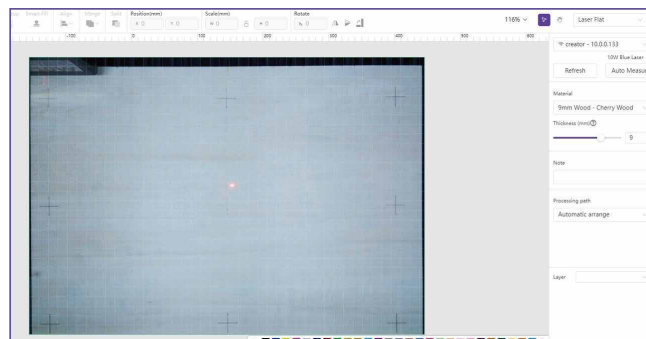

# First Project

---

4. Select Text in the left tool bar, then click on the canvas to insert the text. You can drag the text to your desired location.

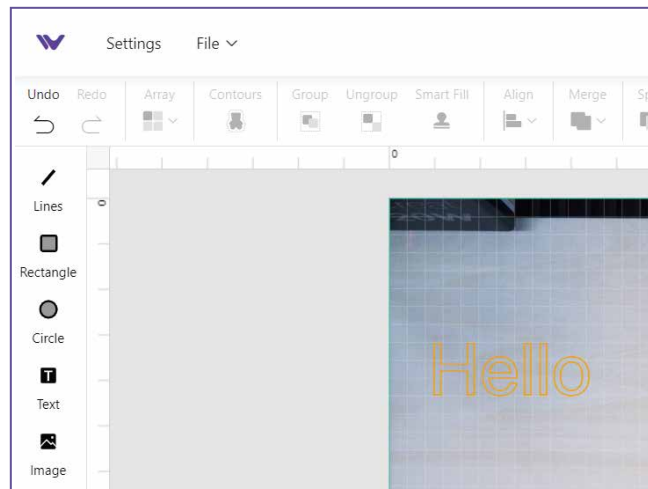

5. Choose material, the thickness will be added automatically or you may put in the thickness or you may click on auto-measurement, the system will start the measurement and the thickness will be added. Choose Line Engrave on the right side menu, adjust the Power and Speed settings accordingly, or simply keep the default settings.

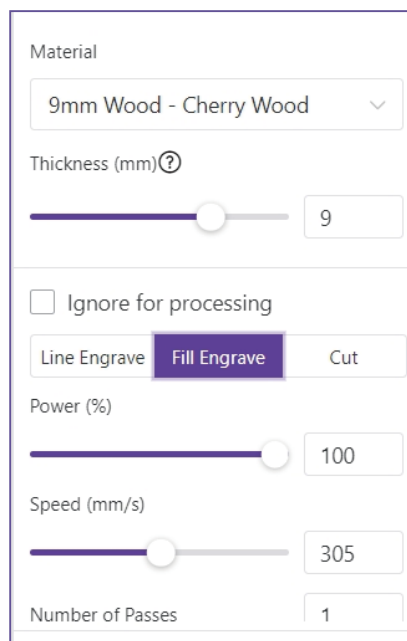

# First Project

---

6. Close the lid and click on the Start button, check the preview and estimated processing time in the pop-up window and click on Send. Then, when you are ready to begin engraving or cutting, press the physical button on the machine to start the job.

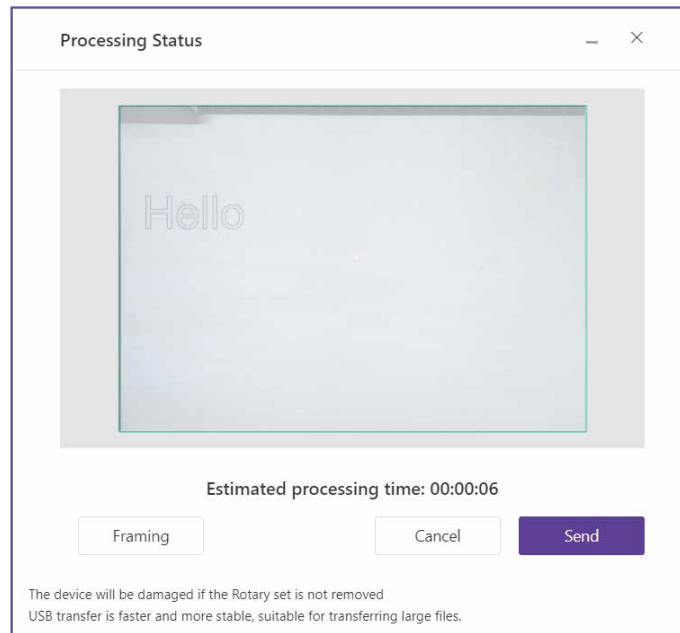

7. Wait until the task completes, then open the top lid to meet your first project.

**If you'd like to learn more about how to create advanced projects, please visit our online learning center at [wecreat.com/learn](https://wecreat.com/learn).**

# Use WeCreat Vista with the Rotary Set

---

For video tutorials, please scan this QR code to view.

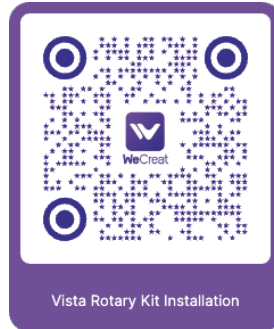

1. Prepare the rotary set using the M4\*10 screws in the tool bag.



2. Switch off the machine. Take out the laser beds.





# Use WeCreat Vista with the Rotary Set

---

3. Move the X-axis to the front, and reverse the laser module.

Note: Rotate the screws on both sides of the laser module simultaneously to turn it forward, then tighten them to secure it.

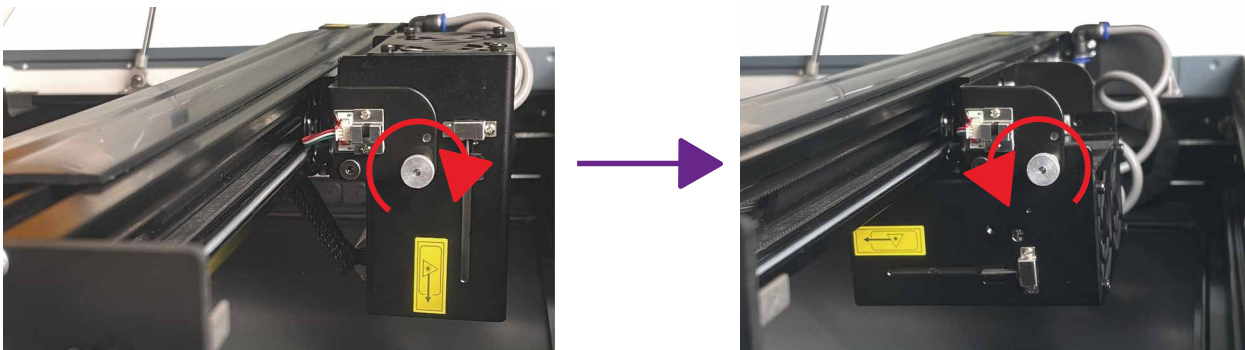
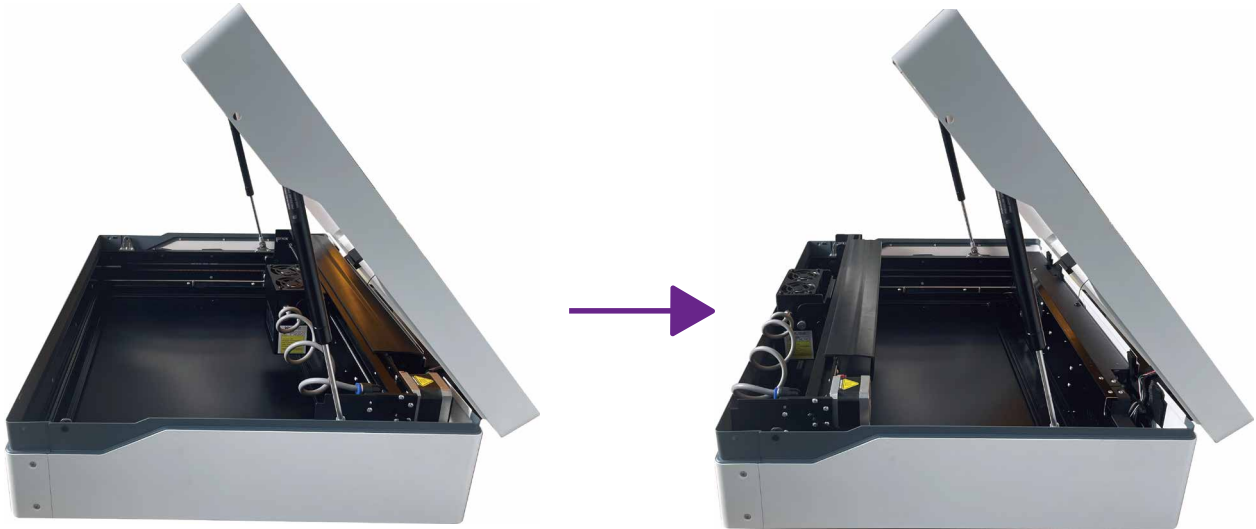

4. Remove the 2 screws on the frame which are used to secure the Rotary set.

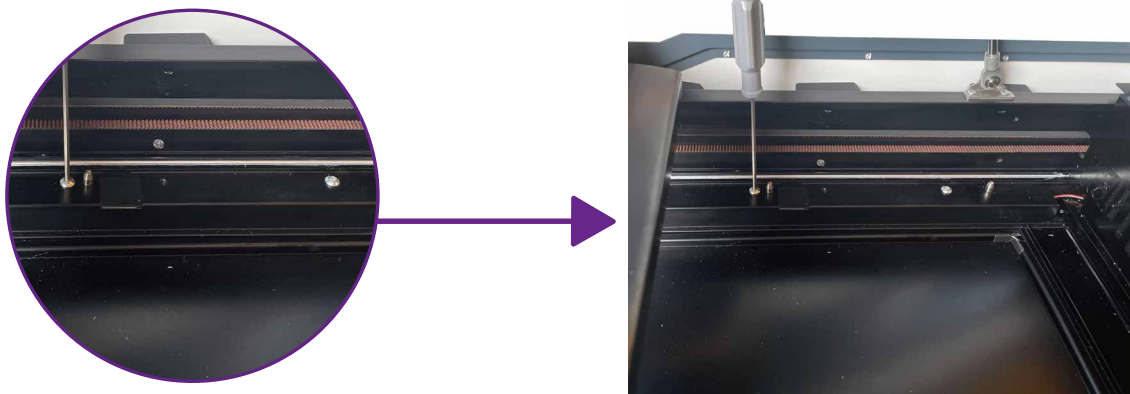

# Use WeCreat Vista with the Rotary Set

---

5. Place the Rotary Set on the left frame, aligning it with the locating pins, and secure it with the M4\*15 screws.

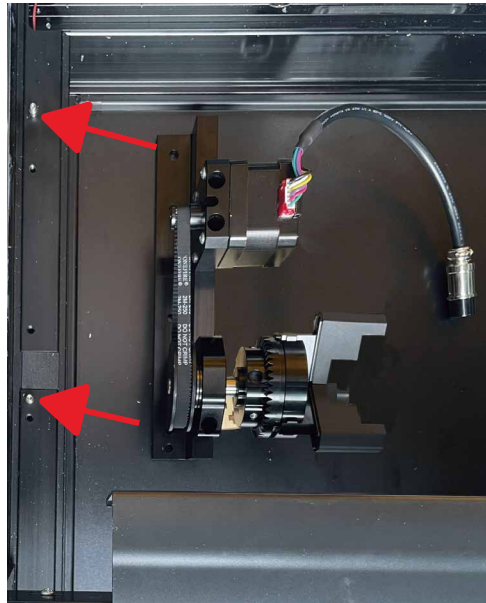

6. Plug the connection cable into the port on the machine's control board. Make sure to align the connector with the groove in the port.

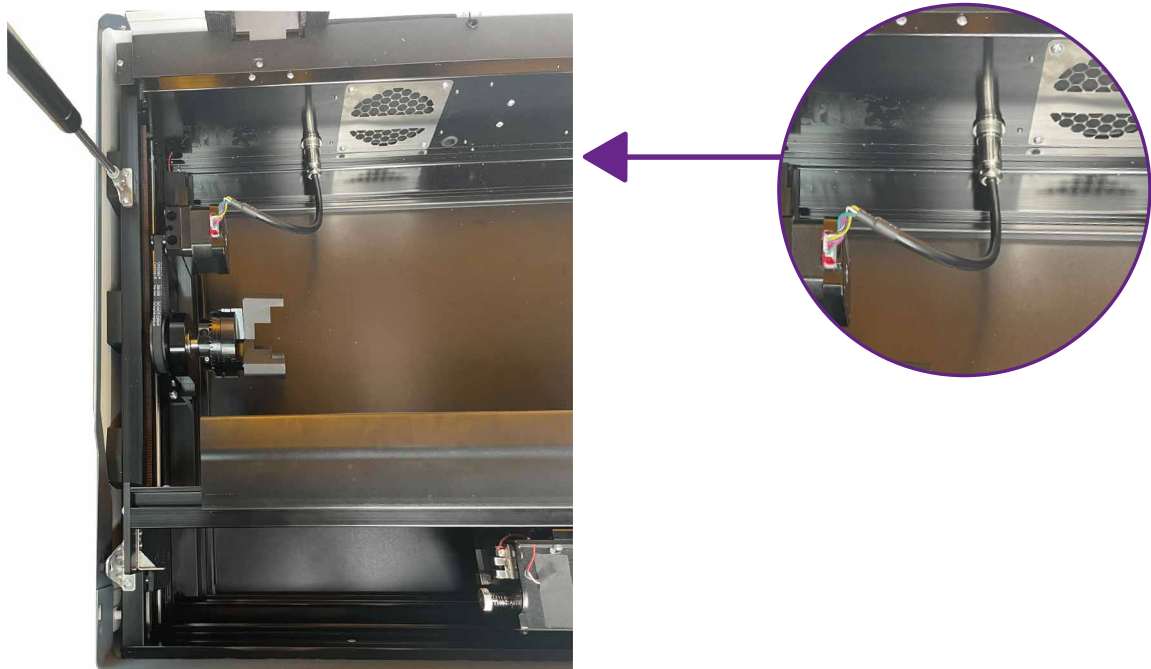

# Use WeCreat Vista with the Rotary Set

---

7. Please use the supplied tape measure to get the perimeter/diameter of the cylindrical object you want to engrave.



8. Secure the cylinder. Rotate the gears on the rotary set to catch the bottom of the cylinder with the claws.

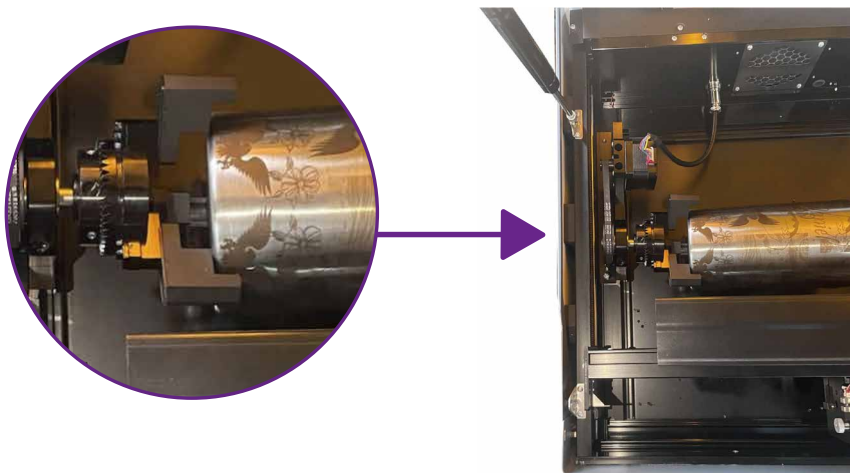

9. Tighten the jaw chuck with the chuck key.

**Note:** There are three holes in total. Use the chuck key to adjust all three holes to ensure the cylinder is firmly fixed.

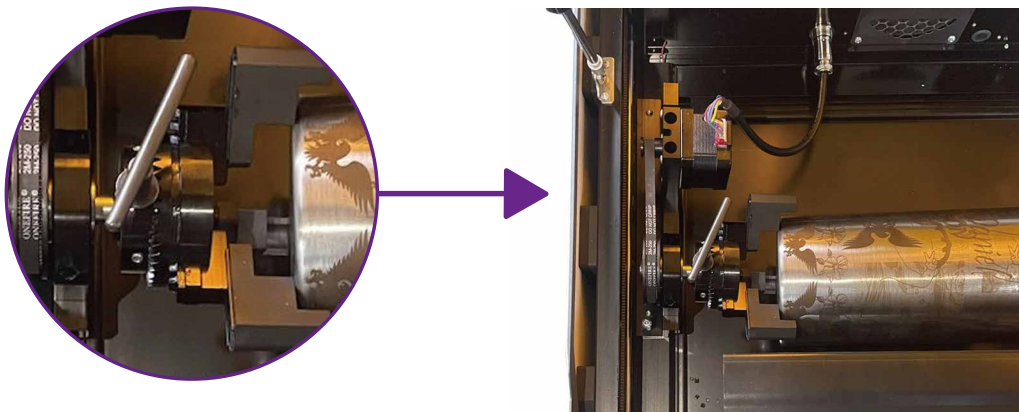

# Use WeCreat Vista with the Rotary Set

10. Adjust the height of the rotary holder. You may use the mini level to ensure the cylinder is horizontally fixed.

**Note:** For a standard cylindrical cup, use a mini level to check if it's parallel. For a tapered cup, ensure the bottom is fully against the three claws to avoid gaps.



11. Switch on the machine, Open the WeCreat MakIt software, select Laser Cylindrical mode on the top right corner, input the Perimeter/Diameter you just measured.

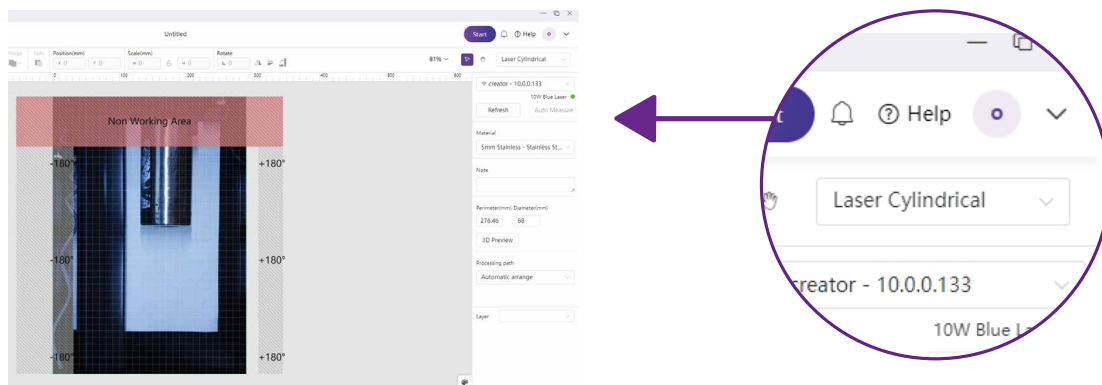

12. Keep the lid open, import your design on the canvas, adjust the position, choose the processing mode and adjust parameters settings, then click on Start to get the preview.

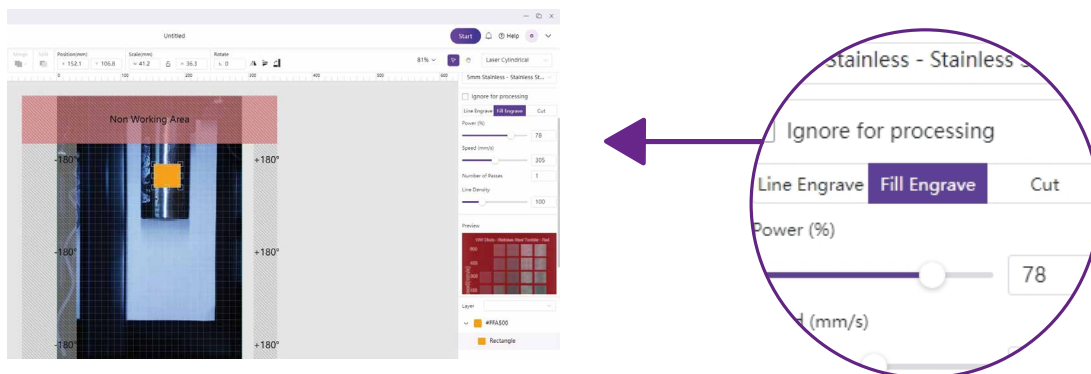

# Use WeCreat Vista with the Rotary Set

---

13. Click on Send and press the Start/Pause button on the machine. Wait until the task completes.

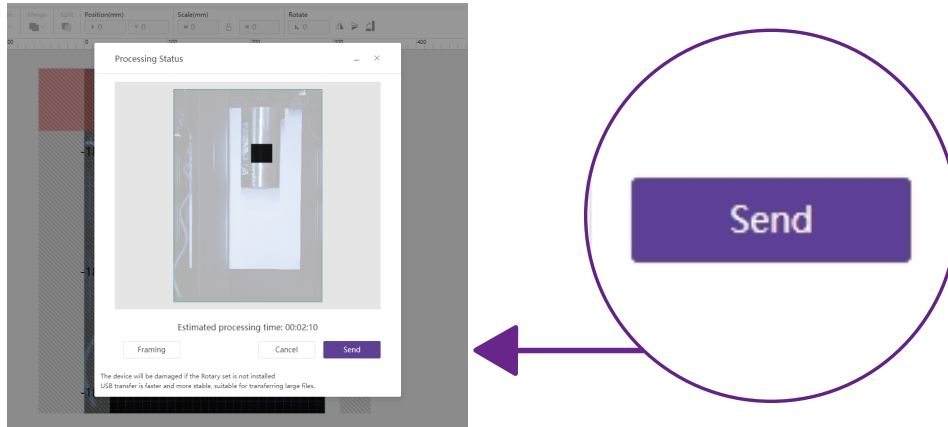

## Tips about the jaw chuck

1. In its default status, it can be used for cylinders with diameters between 1 - 100 mm (0.039 - 3.93 inches).
2. Please pay attention to the position of the connection cable, ensure it's not placing directly above the cylinder as it might be damaged.
3. If you would like to engrave on small objects such as rings, please take out the six screws and remove the jaws, then install the three threaded studs on the jaw chuck.

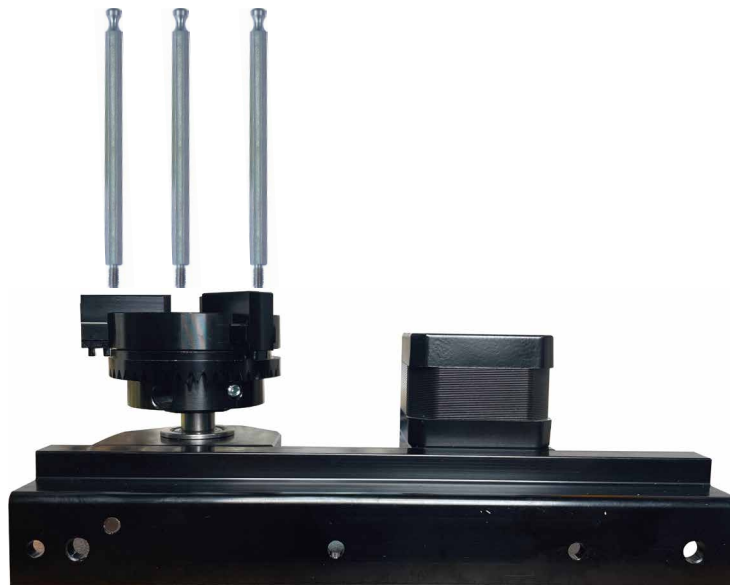

# Hazardous Substances

---

## The Names and Contents of Harmful Substances in the Product

| Part name      | Hazardous substances |     |
|----------------|----------------------|-----|
|                | Pb                   | DBP |
| Drivepipe      | X                    | O   |
| Nut            | X                    | O   |
| Pin            | O                    | O   |
| Screw          | X                    | O   |
| Motor cover    | X                    | O   |
| Terminal shell | O                    | X   |

'O' indicates that the hazardous substance in all homogeneous materials of the component is undetected.

'X' indicates that the content of this hazardous substance in at least one homogeneous material of the component is detected.

Note: The reason for the product marked with 'X' is that there are no alternative technologies or components available at this stage.

 **WARNING:** This product can expose you to chemicals including Lead, which is known to the State of California to cause birth defects or other reproductive harm. For more information, please go to [www.p65warnings.ca.gov](http://www.p65warnings.ca.gov).

# Maintenance

---

Maintaining a laser machine is essential for safety, performance, and longevity. It helps ensure that the equipment operates efficiently and safely while producing high-quality engravings and cuttings consistently over time.

For more detailed instructions on the laser cleaning and maintenance, please scan this QR code.

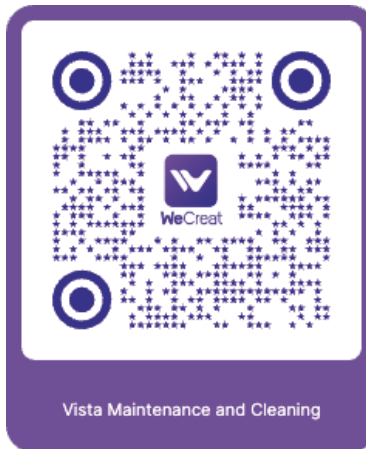

## After-Sales Services

On a mission to make laser engraving easier to everyone, WeCreat group is here to help.

For after-sales services, WeCreat can be reached via  
Telephone: +1 425-939-3933 Mon - Fri, 9 am - 6 pm EST  
Email: [support@wecreat.com](mailto:support@wecreat.com)  
Website: [www.wecreat.com](http://www.wecreat.com)

## Warranty

Within the initial one-year warranty period, we offer comprehensive technical support for any issues you may encounter.

Please click on the link below for more details. This limited manufacturer's warranty does not affect any statutory warranty provided by law.

<https://wecreat.com/pages/warranty-policy>